

CORNER RECORD

Document Number _____

City of _____ County of PLUMAS, California

Brief Legal Description LOT 14, DELLEKER SUBDIVISION, Sec. 34, T. 23 N., R. 13 E., M.D.M.

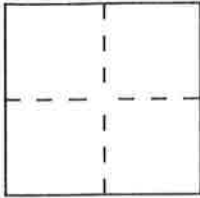

CORNER TYPE

Government Corner Control
 Meander Property
 Rancho Other
 Date of Survey OCTOBER 12, 1992

COORDINATES (Optional)

N. _____
 E. _____
 Zone _____ Datum _____
 Elev. _____

Corner — Left as found Found and tagged Established Reestablished Rebuilt

Identification and type of corner found: Evidence used to identify or procedure used to establish or reestablish the corner:
Found 1/2" Rebars with Plastic Caps RCE 22836 per BPM 97, also found 1/2" I.P. at Southeast Corner of Lot 14 per 2 M87. Set Northeast Corner of Lot 14 from said found Corners in record position.

A description of the physical condition of the monument as found and as set or reset: Set 5/8" Rebar with Plastic Cap L.S. 2843

SURVEYOR'S STATEMENT

This Corner Record was prepared by me or under my direction in conformance with the Land Surveyors' Act on Oct. 20 1992.

Signed John W. Hamby L.S. or R.C.E. Number L.S. 2843

COUNTY SURVEYOR'S STATEMENT

This Corner Record was received Oct 20 1992 and examined and filed Oct. 22 1992.

Signed R Tom Hunter Title Co. Engineer

County Surveyor's Comment _____

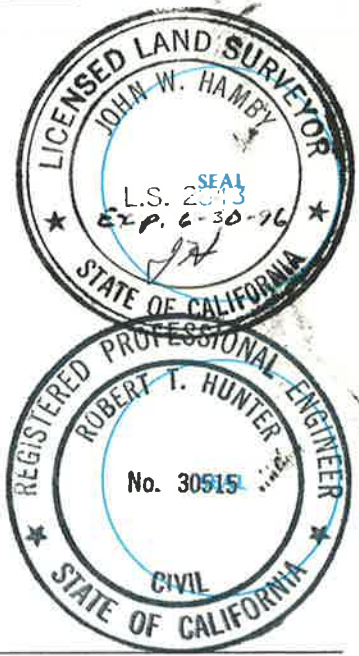

- LEGEND -

- (R) Record per 2 M 87
- (R2) Record Per 8 PM 97
- (M) Measured

Found 1/2" Rebar Plastic Cap
ACE 22836 per 8 PM 97



LOT 15

S 54° 57' 11" E 136.63' (R & M)

LOT 14

SET 5/8" Rebar &
Plastic CAP LS 2843
(R)
L = 37.49'
R = 50.00

Found 1/4" open I.P. (R)
Not record Δ = 6° 43' 12"
R = 310.00'
L = 36.36'

N 40° 29' 19" E 14.75' (R)

COURT

Found 1/2" I.P.
Per 2 M 87
LOT 13

MONTANA

N 17° 25' 29" E
100.00' (R & M)

210.88' (R & M & R2)
110.88' (R & M)

S 65° 34' 24" E 118.54' (R)

Found 1/2" Rebar Plastic Cap
RCE 22836 per 8 PM 97

DELLEKER SUBDIVISION