

CORNER RECORD

COUNTY OF PLUMAS T. 26 N R. 9E M. D. MINERAL SURVEY MERIDIAN CALIFORNIA
 CORNER TYPE: GOVT. CORNER MEANDER RANCHO CONTROL OTHER MINERAL SURVEY
 CORNER IDENTIFICATION -- DATE OF VISIT JULY 19 88 # 1249

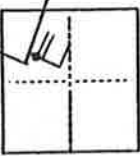

SECTION 23
 SW CORNER EMERALD

CORNER -- LEFT AS FOUND FOUND AND TAGGED REESTABLISHED OBLITERATED CORNER REBUILT

PHYSICAL DESCRIPTION OF CORNER FOUND; EVIDENCE AND METHOD USED TO IDENTIFY OR REESTABLISH

FOUND 2" IRON PIPE

PHYSICAL DESCRIPTION OF MONUMENTS REBUILT OR PERPETUATED

WIRED 1-1/2" BRASS TAG "LS 5067" TO PIPE FROM WHICH:
 12" FIR BEARS S 8° E 3.0 FEET SCRIBED " SW COR E BT"

CALIFORNIA COORDINATE SYSTEM ORDER: FIRST SECOND THIRD STATION _____
 STATIONS USED: NGS (USC & GS) COUNTY OTHER EASTINGS (X) _____
 ZONE _____ ELEVATION _____ NORTHINGS (Y) _____

(Fold)

SKETCH: (Include reference tie or witness points, remarks and topo of area)

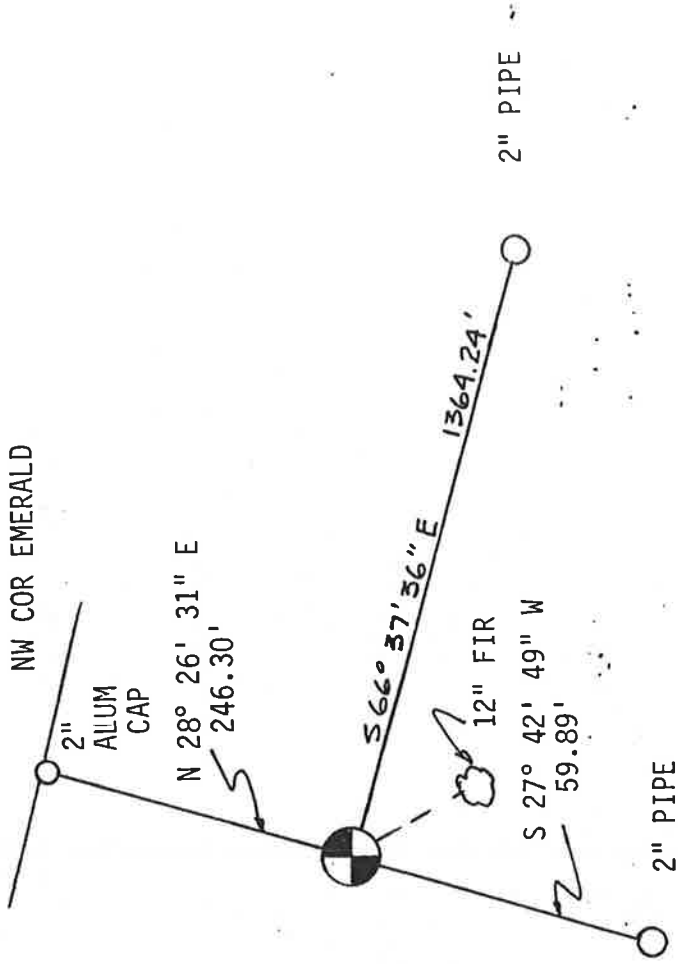

SURVEYOR'S CERTIFICATE

THIS CORNER RECORD WAS PREPARED BY ME OR UNDER MY DIRECTION IN CONFORMANCE WITH THE LAND SURVEYORS ACT ON JULY 20 1988

SIGNED: Michael P. Lejeune
 L.S. 5067
 MICHAEL P. LEJEUNE
 SEAL 5067
 LICENSED LAND SURVEYOR STATE OF CALIFORNIA

COUNTY SURVEYOR'S CERTIFICATE

THE CORNER RECORD WAS RECEIVED AND EXAMINED AND FILED 15 1983

BY: R. Tom Shuster 1983
 TITLE: Ch. Surveyor

DOCUMENT No. 79

STATEMENT ON BACK OF SHEET

YES NO