

CORNER RECORD

Document Number _____

Sec. ¹⁵ 10 T 23 N R 11 E

County of Plumas, California

Brief Legal Description Southerly line of property shown on 2 RS 112

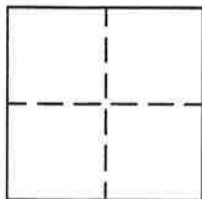

CORNER TYPE

Government Corner Control
 Meander Property
 Rancho Other
 Date of Survey April 2, 1996

COORDINATES (Optional)

N. _____
 E. _____
 Zone _____ Datum _____
 Elev. _____

Corner— Left as found Found and tagged Established Reestablished Rebuilt

Identification and type of corner found: Evidence used to identify or procedure used to establish or reestablish the corner:

Found 1" I.P. monuments shown on 2 RS 112. Those monuments that had
been destroyed by road maintenance were replaced with 5/8" rebar with
aluminum caps stamped L.S.2843.

A description of the physical condition of the monument as found and as set or reset: _____

See attached drawing for condition of found monuments.

SURVEYOR'S STATEMENT

This Corner Record was prepared by me or under my direction in conformance with the Land Surveyors' Act on September 10, 1994.

Signed John W. Hamby L.S. 2843
John W. Hamby



COUNTY SURVEYOR'S STATEMENT

This Corner Record was received 5/10 1996 and examined and filed 5/9 1996.

Signed R. Tom Hunter Title Co. Surveyor



County Surveyor's Comment _____

LEGEND

- FOUND point as described
- SET 5/8" Rebar & Aluminum Cap LS 2843
- (R1) RECORD per 2 RS 112
- (R2) RECORD per 9 RS 131

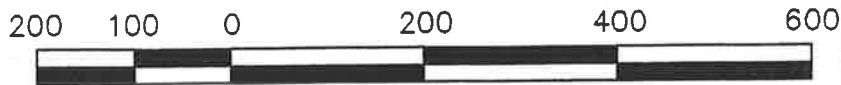

1" = 200'

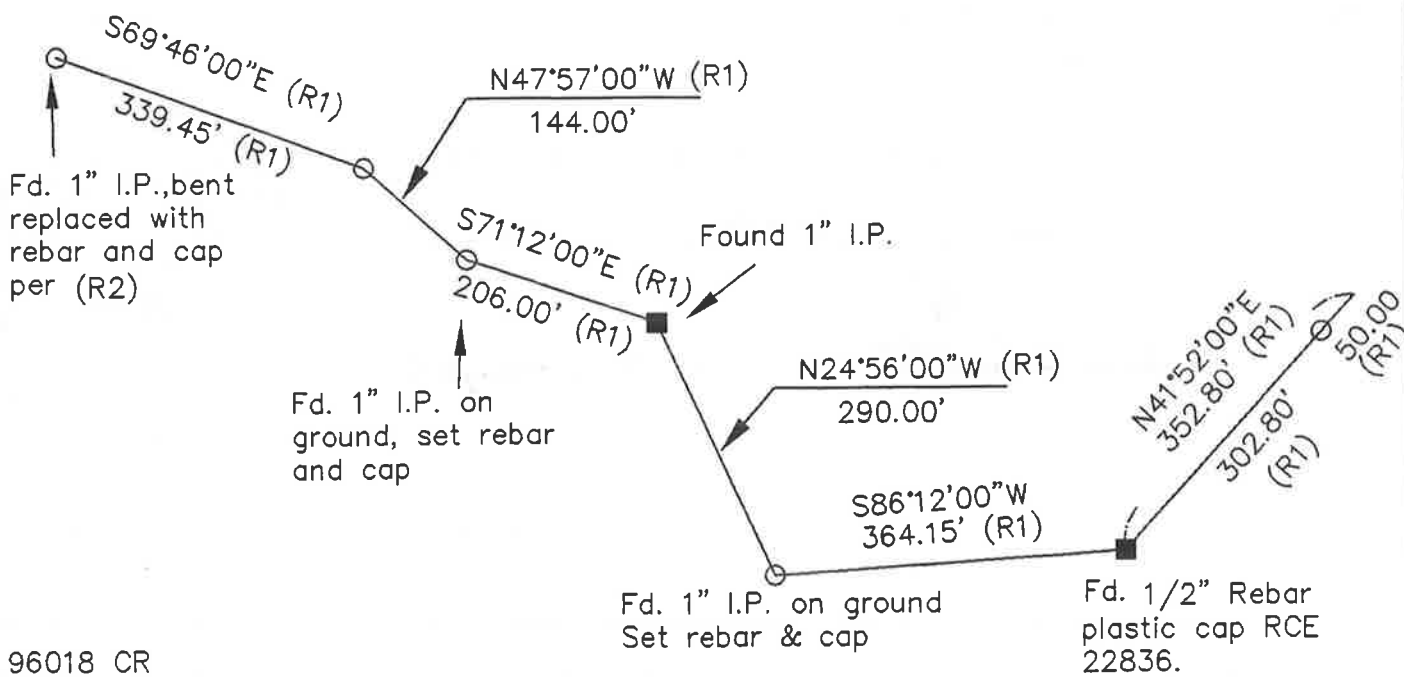

96018 CR