

CORNER RECORD

Document Number 421

City of PORTOLA

County of PLUMAS, California

Brief Legal Description Centerline of Main Street between First Ave. and Second Ave. 8RS115

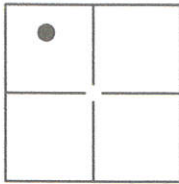

CORNER TYPE

COORDINATES(Optional)

Government Corner Control
Meander Property
Rancho Other

N. _____
E. _____
Zone _____ NAD27 NAD83
NAD83 Epoch _____
Elev. _____
Vert. Datum: NGVD29 NADV88
Meas. Units: Metric Imperial

Date of Survey JUNE, 2016

SECTION 1
T.22N., R.13E., M.D.M.

Corner— Left as found Found and tagged Established Reestablished Rebuilt

Identification and type of corner found: Evidence used to identify or procedure used to establish or reestablish the corner:
FOUND STREET CENTERLINE MONUMENTS, AS SHOWN ON PAGE 2, IN RECORD POSITION PER 8 RS 115. SURVEY CONTROL POINTS WERE SET TO PROVIDE TIES FOR THE FUTURE REESTABLISHMENT OF THE MONUMENTS DUE TO ROAD CONSTRUCTION.

A description of the physical condition of the monument as found and as set or reset: _____
FOUND RAILROAD SPIKES AS SHOWN ON 8 RS 115.

SURVEYOR'S STATEMENT

This Corner Record was prepared by me or under my direction in conformance with the Land Surveyor's Act on 6/28/2016, _____.

Signed Daniel B. Bastian P.L.S. or R.C.E. No.: 7045

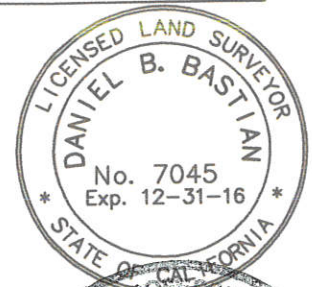

COUNTY SURVEYOR'S STATEMENT

This Corner Record was received July 4, 2016 and examined and filed July 26, 2016.

Signed R. Tom Hunter P.L.S. or R.C.E. No.: 30515

Title Contract County Surveyor Expires 3/31/2018

County Surveyor's Comment _____

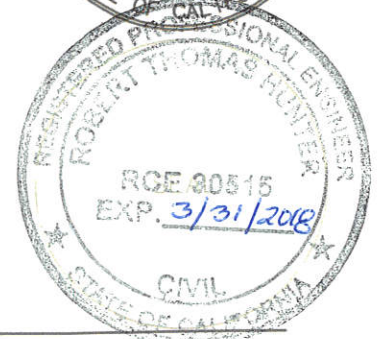

LEGEND

- Found corner as described per Book 5 of Records of Survey at Page 115.

NOTES:

1. The bearing and distance shown between the found monuments are record and measured per Book 8 of Records of Survey at Page 115.
2. The purpose of this Corner Record is to reference the location of the monuments shown hereon and to facilitate their reestablishment after they are removed for a Public Works construction project, per LSA Section 8771(b).

