

VICINITY MAP LAKE ALMANOR
COUNTRY CLUB UNIT 3

SCALE 1 INCH = 2 MILE

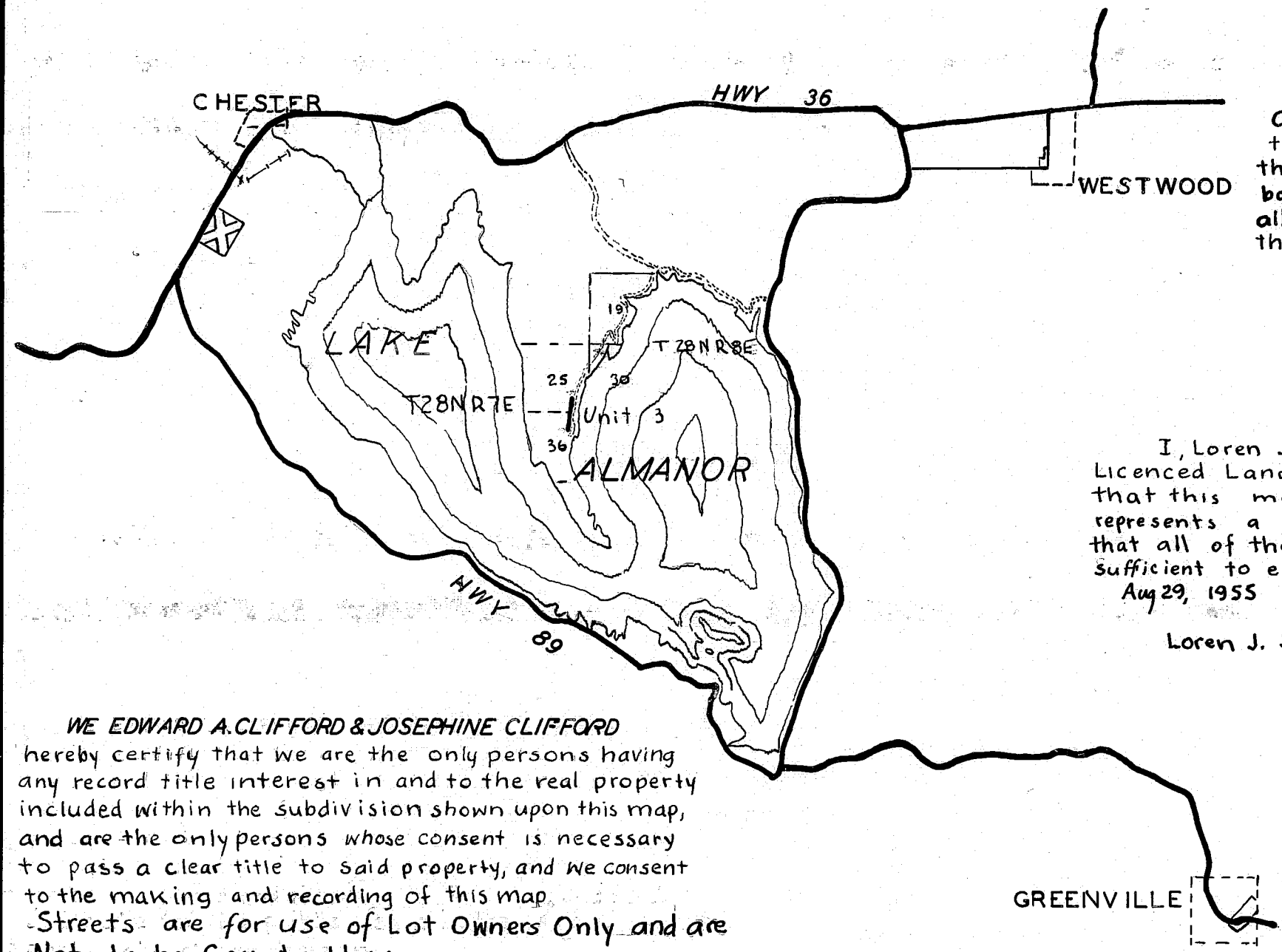

I, Chester Hard, County Tax Collector of the County of Plumas, hereby certify that there are no liens for any unpaid taxes or special assessments collected as taxes against the land included in the within subdivision, except taxes not yet payable and that said land is not nor is any part thereof subject to any special assessments which have not been paid in full
Dated November 8, 1955
Chester Hard by Robert R. Larson Deputy
Tax Collector of Plumas County

I, Lois Kehrer, County Clerk of Plumas County and ex-officio Clerk of the Board of Supervisors of Plumas County, hereby certify that, said Board at its regular meeting of September 8, 1955 approved this map subject to the certification of the County Surveyor
Dated Nov. 8, 1955
Lois Kehrer
County Clerk and ex-officio Clerk of the Board of Supervisors of Plumas County, California

I, A.J. Watson, County Surveyor of Plumas County hereby certify that I have examined this map, that it conforms substantially to the tentative map previously approved by the board of Supervisors of Plumas County and to all the requirements of Law and that I am satisfied that this map is technically correct
A.J. Watson 11/5/55
County Surveyor, County of Plumas

I, Loren J. Sargent, hereby certify that I am a Licenced Land Surveyor of the State of California, that this map consisting of three sheets correctly represents a Survey made by me in August 1955, that all of the monuments exist as shown and are sufficient to enable this survey to be retraced
Aug 29, 1955
Loren J. Sargent
Loren J. Sargent LS 2322

1740

Filed for RECORD AT THE REQUEST of Loren J. Sargent At 50 Minutes
Past 9 M This 9 Day
of September 1955
NOVEMBER
Ed. Logan
County Recorder of Plumas County

WE EDWARD A. CLIFFORD & JOSEPHINE CLIFFORD hereby certify that we are the only persons having any record title interest in and to the real property included within the subdivision shown upon this map, and are the only persons whose consent is necessary to pass a clear title to said property, and we consent to the making and recording of this map.
Streets are for use of Lot Owners Only and are Not to be County Hwys.

Edward A. Clifford
EDWARD A. CLIFFORD
Josephine Clifford
JOSEPHINE CLIFFORD

State of WASHINGTON } ss
County of KING

On this 20th Day of Sept, 1955 before me FRANCIS HOLLAND a Notary Public in and for said county residing therein, duly Commissioned + sworn personally appeared Edward A Clifford and Josephine Clifford known to me to be the persons whose names are signed to the within instrument, and acknowledged to me that they executed the same

In witness where off I have hereunto set my hand and affixed my seal the day and year in this certificate first above written

Francis Holland
Notary Public in and for the County of KING State of WASHINGTON

My Commission expires MARCH 27 1956

LAKE ALMANOR COUNTRY CLUB
UNIT NO.3

Located in the S.E. 1/4 of Sec. 25 and the N.E. 1/4 of Sec. 36 T28N R7E M.D.M.
Edward A. Clifford Owner and Subdivider
Loren J. Sargent - Surveyor