

W 1/4 Cor. Sec. 8 - 1 1/2" I.P. with Bronze Cap, set to 4th order accuracy by Calif. Dept. of Water Resources. (1963)

N. 229,125.87  
 E. 2,499,223.81

Set 1 1/4" I.P. & Tag and mound of stone at 1/16 Sec. Cor.

Easement for water main, pump, hand & related facilities

**ADDITIONAL CURVE DATA**

CURVE No.	R	L	Δ
①②③④	R = 20.00'	L = 15.50'	Δ = 44°25'55"
⑤	R = 20.00'	L = 30.53'	Δ = 87°36'47"
⑥	R = 20.00'	L = 35.01'	Δ = 100°17'40"
⑦	R = 20.00'	L = 28.58'	Δ = 81°52'01"
⑧	R = 20.00'	L = 32.25'	Δ = 92°23'13"

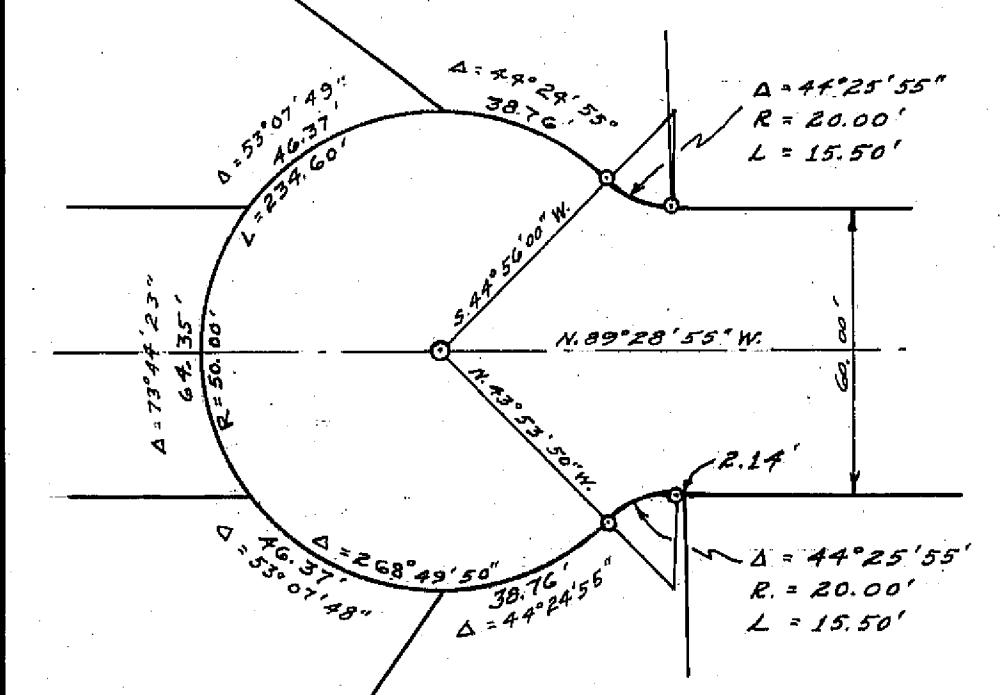

- LEGEND**
- R/W Indicates Right-of-Way.
  - ⊕ Indicates Centerline.
  - R Indicates Radius
  - Δ Indicates Central Angle of Curve.
  - L Indicates Length of Curve.
  - ⊙ Indicates 2" Iron Pipe set with brass tag stamped "John C. Simpson, R.C.E. 11173"
  - Indicates Iron Pipe or Steel pin set (also at all lot corners)

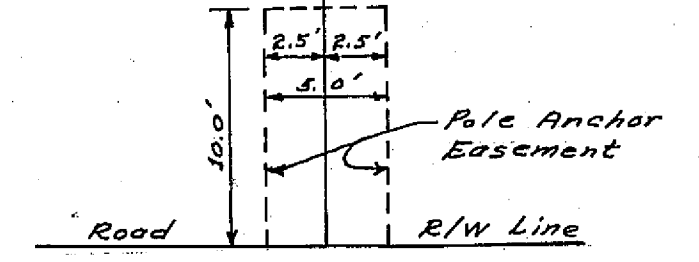

**NOTE**  
 Utility poles and guy anchors will be located in road rights-of-way if possible. Guy anchors may be set as indicated above if unavoidable, but only at lot lines.