

I, EDWARD C. CLIFFORD, TRUSTEE, HEREBY CERTIFY THAT I AM THE ONLY PERSON HAVING ANY RECORD TITLE INTEREST IN AND TO THE REAL PROPERTY INCLUDED WITHIN THE SUBDIVISION SHOWN UPON THIS MAP, AND THE ONLY PERSON WHOSE CONSENT IS NECESSARY TO PASS A CLEAR TITLE TO SAID PROPERTY, AND I CONSENT TO THE MAKING AND RECORDING OF THIS MAP. I HEREBY OFFER FOR DEDICATION THE RIGHTS-OF-WAY AND EASEMENTS FOR WATER AND SEWER LINES AND OVERHEAD AND UNDERGROUND WIRES, ON, OVER, AND UNDER THOSE STRIPS OF LAND DESIGNATED "PUBLIC UTILITIES EASEMENTS" AND EASEMENTS FOR DRAINAGE PURPOSES OVER THOSE STRIPS OF LAND DESIGNATED "DRAINAGE EASEMENTS". ALL OTHER EASEMENTS AS SHOWN ON THIS MAP ARE RESERVED FOR SPECIFIC PURPOSES AS NOTED. I ALSO OFFER FOR DEDICATION ALL STREETS AND ROADS WITHIN THIS SUBDIVISION FOR PUBLIC USE FOR COUNTY ROAD AND PUBLIC UTILITY PURPOSES. I ALSO OFFER FOR DEDICATION FOR PUBLIC RECREATION AREA, THAT PARCEL OF LAND IDENTIFIED AS AREA 'G' AS SHOWN ON THIS MAP.

Edward C. Clifford  
EDWARD C. CLIFFORD - TRUSTEE

STATE OF CALIFORNIA  
COUNTY OF LASSEN

ON THIS 15<sup>th</sup> DAY OF April, 1974, BEFORE ME BETTY K. SMITH A NOTARY PUBLIC IN AND FOR SAID COUNTY RESIDING THEREIN, DULY COMMISSIONED AND SWORN, PERSONALLY APPEARED EDWARD C. CLIFFORD KNOWN TO ME TO BE THE PERSON WHOSE NAME IS SIGNED TO THE WITHIN INSTRUMENT, AND ACKNOWLEDGED TO ME THAT HE EXECUTED THE SAME. IN WITNESS WHEREOF I HAVE HEREUNTO SET MY HAND AND AFFIXED MY SEAL THE DAY AND YEAR IN THIS CERTIFICATE FIRST ABOVE WRITTEN.



Betty K. Smith  
NOTARY  
MY COMMISSION EXPIRES 3-19-77

I, PAUL E. SIMPSON, DO HEREBY CERTIFY THAT I AM A REGISTERED CIVIL ENGINEER AND LICENSED LAND SURVEYOR OF THE STATE OF CALIFORNIA, THAT THE ANNEXED MAP CORRECTLY REPRESENTS A SURVEY MADE UNDER MY DIRECTION IN, 1973 & 1974, THAT THE SURVEY IS TRUE AND COMPLETE AS SHOWN, THAT THE MONUMENTS SHOWN THEREON EXIST AND ARE OF THE CHARACTER AND OCCUPY THE POSITIONS INDICATED, AND ARE SUFFICIENT TO ENABLE THE SURVEY TO BE RETRACED.

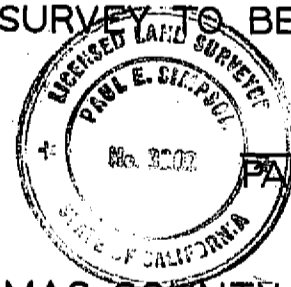

Paul E. Simpson  
PAUL E. SIMPSON R.C.E. 18535 S. 3202  
CIVIL  
STATE OF CALIFORNIA

I, THE UNDERSIGNED, PLUMAS COUNTY ROAD COMMISSIONER, HEREBY CERTIFY THAT THE STREETS AND DRAINAGE SHOWN HEREON ARE IN COMPLIANCE WITH PLUMAS COUNTY REGULATIONS.

Lawrence J. Brock  
LAWRENCE J. BROCK, R.C.E. 13528  
PLUMAS COUNTY ROAD COMMISSIONER

I, THE UNDERSIGNED, COUNTY SURVEYOR OF THE COUNTY OF PLUMAS, STATE OF CALIFORNIA, DO HEREBY CERTIFY THAT I HAVE EXAMINED THE FINAL MAP OF LAKE ALMANOR WEST UNIT NO. 1, THAT IT IS SUBSTANTIALLY THE SAME AS APPEARED ON THE TENTATIVE MAP ON FILE AND ANY APPROVED ALTERATIONS THEREOF, THAT ALL THE PROVISIONS OF THE SUBDIVISION MAP ACT OF THE STATUTES OF CALIFORNIA, AND ANY LOCAL ORDINANCES APPLICABLE AT THE TIME OF APPROVAL OF SAID TENTATIVE MAP HAVE BEEN COMPLIED WITH, AND I AM SATISFIED THAT THE MAP IS TECHNICALLY CORRECT.

Larry A. Fites  
LARRY A. FITES, R.C.E. 13225  
PLUMAS COUNTY SURVEYOR

I, THE UNDERSIGNED, COUNTY TAX COLLECTOR OF THE COUNTY OF PLUMAS, STATE OF CALIFORNIA, DO HEREBY CERTIFY THAT THERE ARE NO TAX LIENS AGAINST LAKE ALMANOR WEST UNIT NO. 1 AS HEREIN SET FORTH, OR UNPAID STATE, COUNTY, MUNICIPAL, OR LOCAL TAXES, OR SPECIAL ASSESSMENTS COLLECTED AS TAXES, EXCEPT TAXES OR ASSESSMENTS NOT YET PAYABLE. TAXES OR ASSESSMENTS WHICH ARE A LIEN BUT NOT YET PAYABLE, ARE ESTIMATED TO BE IN THE AMOUNT OF \$8160.00.

Douglas S. Redstreak  
DOUGLAS S. REDSTREAKE  
PLUMAS COUNTY TAX COLLECTOR

I DO HEREBY CERTIFY THAT ON THE 7<sup>th</sup> DAY OF May, 1974, THE PLUMAS COUNTY BOARD OF SUPERVISORS OFFICIALLY APPROVED THE SUBDIVISION MAPS OF LAKE ALMANOR WEST UNIT NO. 1, THE RECEIPT OF SATISFACTORY SECURITY IN THE TAX COLLECTOR ESTIMATED AMOUNT OF \$8,160.00 TO INSURE PAYMENT OF TAXES WHICH ARE LIEN, BUT NOT YET PAYABLE, WAS ACKNOWLEDGED. ALL DEDICATIONS OFFERED ON THIS MAP WERE ACCEPTED FOR THE USES NOTED.

Raynelle Slaten  
RAYNELLE SLATEN  
PLUMAS COUNTY CLERK

RECORDED IN THE OFFICE OF THE RECORDER OF PLUMAS COUNTY, STATE OF CALIFORNIA, AT THE REQUEST OF PLUMAS COUNTY TITLE COMPANY THIS 7<sup>th</sup> DAY OF MAY, 1974 AT 30 MINUTES PAST 4 O'CLOCK P.M. IN BOOK 4 AT PAGES 42, 43, 44, 45, 46, 47, 48 FILE NO. 5256 FEE: \$17.00

Dorothy Neer Marley  
DOROTHY NEER MARLEY  
PLUMAS COUNTY RECORDER  
By Fred E. Thomas, Deputy

- NOTES:
1. THE BASIS OF BEARINGS IS THE RECORD OF SURVEY FILED IN BOOK 4 AT PAGE 5.
  2. SUBDIVISION ACREAGE  
TOTAL = 155.32 AC.  
LOTS = 104.06 AC.  
AREAS = 30.41 AC.  
ROADS = 20.85 AC.
  3. ALL SEPTIC TANK & LEACHFIELD SYSTEMS INSTALLED ON THESE LOTS SHALL BE IN CONFORMANCE WITH THE "GUIDELINES FOR WASTE DISPOSAL FROM LAND DEVELOPMENTS" ESTABLISHED BY THE CALIFORNIA REGIONAL WATER QUALITY CONTROL BOARD, CENTRAL VALLEY REGION.
  4. A SOILS AND GEOLOGIC REPORT ON THIS SUBDIVISION WAS PREPARED IN OCTOBER, 1972 BY TOM CORDOVA, REGISTERED GEOLOGIST NO. 242, FOR EARTH SCIENCE CONSULTANTS ASSOCIATED, RENO, NEVADA.
  5. THE FOLLOWING LOTS DO NOT MEET THE CRITERIA FOR LEACHFIELD SYSTEMS AND SHALL NOT BE ISSUED BUILDING PERMITS UNTIL SUCH TIME AS A SEWAGE DISPOSAL SYSTEM HAS BEEN APPROVED BY THE COUNTY OF PLUMAS: 9, 10, 11, 12, 13, 48, 49, 50, 51, 166, 167 & 168.

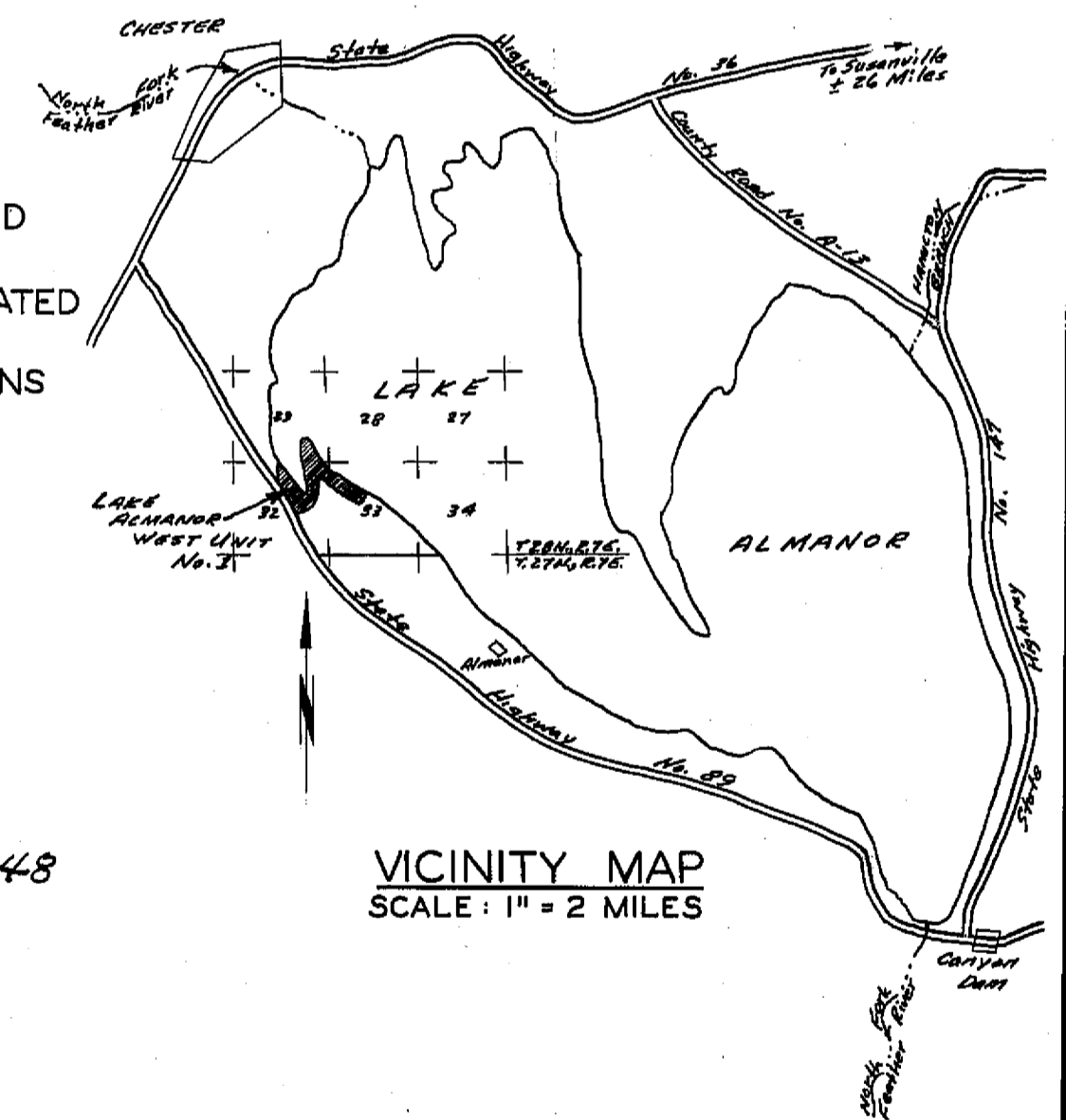

VICINITY MAP  
SCALE: 1" = 2 MILES

**LAKE ALMANOR WEST UNIT NO. 1**  
IN A PORTION OF SECTIONS 29, 32, & 33, T.28N., R.7E., M.D.B. & M.  
PLUMAS COUNTY, CALIFORNIA  
SCALE: 1" = 100'  
OWNER & SUBDIVIDER: EDWARD C. CLIFFORD  
PAUL E. SIMPSON, & ASSOCIATES, ENGINEERING-PLANNING-SURVEYING  
SUSANVILLE, CALIFORNIA