

OWNER'S CERTIFICATE:

I, EDWARD C. CLIFFORD, TRUSTEE, HEREBY CERTIFY THAT I AM THE ONLY PERSON HAVING ANY RECORD TITLE INTEREST IN AND TO THE REAL PROPERTY INCLUDED WITHIN THE SUBDIVISION SHOWN UPON THIS MAP, AND THE ONLY PERSON WHOSE CONSENT IS NECESSARY TO PASS A CLEAR TITLE TO SAID PROPERTY, AND I CONSENT TO THE MAKING AND RECORDING OF THIS MAP. I HEREBY OFFER FOR DEDICATION THE RIGHTS-OF-WAY AND EASEMENTS FOR WATER AND SEWER LINES AND OVERHEAD AND UNDERGROUND WIRES, ON, OVER, AND UNDER THOSE STRIPS OF LAND DESIGNATED "PUBLIC UTILITIES EASEMENTS" AND EASEMENTS FOR DRAINAGE PURPOSES OVER THOSE STRIPS OF LAND DESIGNATED "DRAINAGE EASEMENTS" ALL OTHER EASEMENTS AS SHOWN ON THIS MAP ARE RESERVED FOR SPECIFIC PURPOSES AS NOTED. I ALSO OFFER FOR DEDICATION ALL STREETS AND ROADS WITHIN THIS SUBDIVISION FOR PUBLIC USE FOR COUNTY ROAD AND PUBLIC UTILITY PURPOSES.

Edward C. Clifford
EDWARD C. CLIFFORD - TRUSTEE

STATE OF California
COUNTY OF Lassen

ON THIS 22nd DAY OF April, 1976, BEFORE ME Becky L. Polan A NOTARY PUBLIC IN AND FOR SAID COUNTY RESIDING THEREIN, DULY COMMISSIONED AND SWORN, PERSONALLY APPEARED EDWARD C. CLIFFORD KNOWN TO ME TO BE THE PERSON WHOSE NAME IS SIGNED TO THE WITHIN INSTRUMENT, AND ACKNOWLEDGED TO ME THAT HE EXECUTED THE SAME. IN WITNESS WHEREOF I HAVE HEREUNTO SET MY HAND AND AFFIXED MY SEAL THE DAY AND YEAR IN THIS CERTIFICATE FIRST ABOVE WRITTEN.

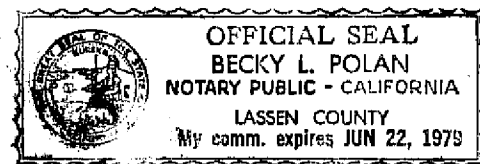

Becky L. Polan
NOTARY
MY COMMISSION EXPIRES 6-22-79

SURVEYOR'S CERTIFICATE:

I, PAUL E. SIMPSON, DO HEREBY CERTIFY THAT I AM A REGISTERED CIVIL ENGINEER AND LICENSED LAND SURVEYOR OF THE STATE OF CALIFORNIA, THAT THE ANNEXED MAP CORRECTLY REPRESENTS A SURVEY MADE UNDER MY DIRECTION IN 1975. THAT THE SURVEY IS TRUE AND COMPLETE AS SHOWN, THAT THE MONUMENTS SHOWN THEREON EXIST AND ARE OF THE CHARACTER AND OCCUPY THE POSITIONS INDICATED, AND ARE SUFFICIENT TO ENABLE THE SURVEY TO BE RETRACED.

Paul E. Simpson
PAUL E. SIMPSON - R.C.E. 18539

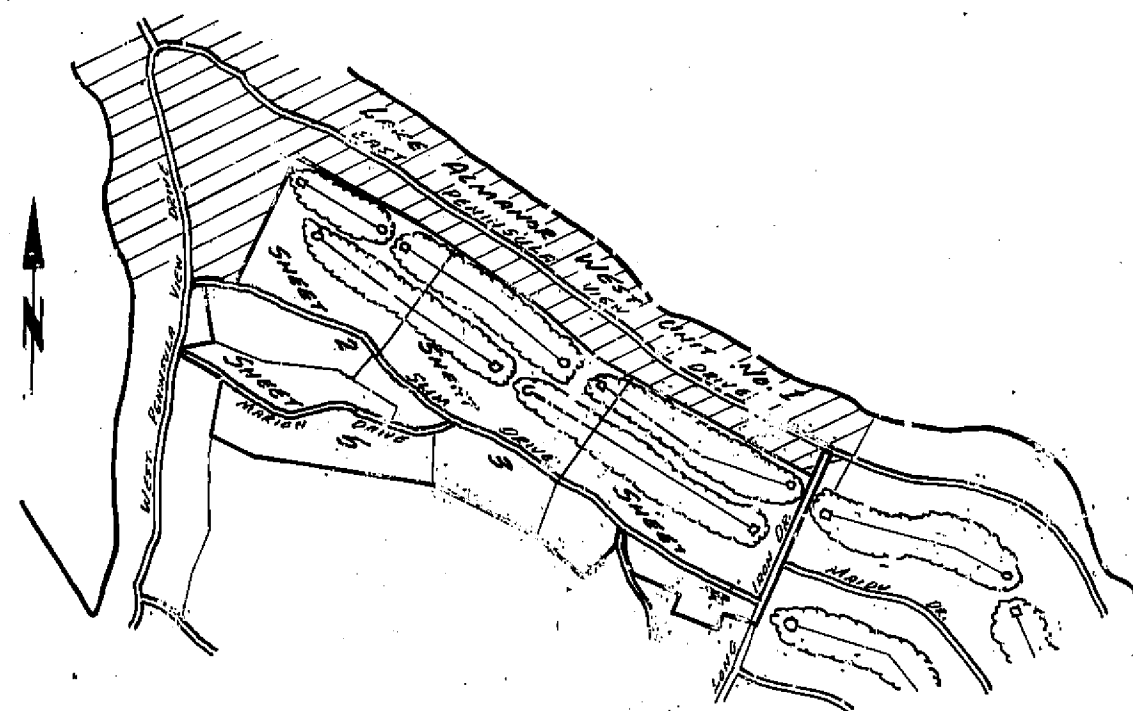
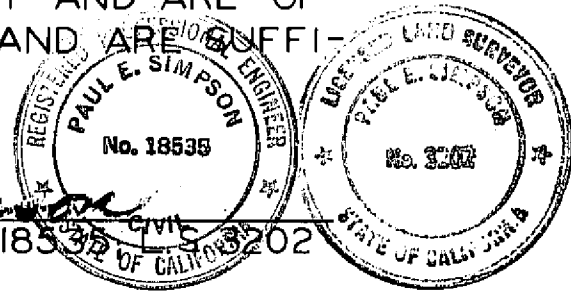

KEY MAP
SCALE 1" = 1200'

COUNTY SURVEYOR'S CERTIFICATE:

THIS MAP HAS BEEN EXAMINED FOR CONFORMANCE WITH THE REQUIREMENTS OF THE LAND SURVEYOR'S ACT THIS 4th DAY OF May, 1976

Larry A. Fites
LARRY A. FITES, R.C.E. 13223
PLUMAS COUNTY SURVEYOR

NOTES:

1. THE BASIS OF BEARINGS IS THE MAP FILED FOR LAKE ALMANOR WEST UNIT NO. 1 IN MAP BOOK 4 AT PAGES 42-48.
2. SUBDIVISION ACREAGE
TOTAL = 111.97 AC.
LOTS = 54.99 AC.
ROADS = 9.78 AC.
AREAS = 47.20 AC.
3. ALL SEPTIC TANK & LEACHFIELD SYSTEMS INSTALLED ON THESE LOTS SHALL BE IN CONFORMANCE WITH THE "GUIDELINES FOR WASTE DISPOSAL FROM LAND DEVELOPMENTS" ESTABLISHED BY THE CALIFORNIA REGIONAL WATER QUALITY CONTROL BOARD, CENTRAL VALLEY REGION.
4. A SOILS AND GEOLOGIC REPORT ON THIS SUBDIVISION WAS PREPARED IN OCTOBER 1972 BY TOM CORDOVA, REGISTERED GEOLOGIST NO. 242, OF EARTH SCIENCE CONSULTANTS ASSOCIATED, RENO, NEVADA.

COUNTY TAX COLLECTOR'S CERTIFICATE:

I, THE UNDERSIGNED, COUNTY TAX COLLECTOR OF THE COUNTY OF PLUMAS, STATE OF CALIFORNIA, DO HEREBY CERTIFY THAT THERE ARE NO TAX LIENS AGAINST LAKE ALMANOR WEST UNIT NO. 2 AS HEREIN SET FORTH, OR UNPAID STATE, COUNTY, MUNICIPAL, OR LOCAL TAXES, OR SPECIAL ASSESSMENTS COLLECTED AS TAXES, EXCEPT TAXES OR ASSESSMENTS NOT YET PAYABLE, TAXES OR ASSESSMENTS WHICH ARE A LIEN BUT NOT YET PAYABLE, ARE ESTIMATED TO BE IN THE AMOUNT OF \$7,800⁰⁰.

Douglas S. Redstreake
DOUGLAS S. REDSTREAKE
PLUMAS COUNTY TAX COLLECTOR

COUNTY CLERK'S CERTIFICATE:

I DO HEREBY CERTIFY THAT ON THE 4th DAY OF MAY, 1976, THE PLUMAS COUNTY BOARD OF SUPERVISORS OFFICIALLY APPROVED THE SUBDIVISION MAPS OF LAKE ALMANOR WEST UNIT NO. 2, THE RECEIPT OF SATISFACTORY SECURITY IN THE TAX COLLECTOR ESTIMATED AMOUNT OF \$7,800 TO INSURE PAYMENT OF TAXES WHICH ARE LIEN, BUT NOT YET PAYABLE, WAS ACKNOWLEDGED. ALL DEDICATIONS OFFERED ON THIS MAP WERE ACCEPTED FOR THE USES NOTED.

Raynelle Slaten
RAYNELLE SLATEN
PLUMAS COUNTY CLERK

COUNTY RECORDER'S CERTIFICATE:

RECORDED IN THE OFFICE OF THE RECORDER OF PLUMAS COUNTY, STATE OF CALIFORNIA, AT THE REQUEST OF PLUMAS COUNTY TITLE COMPANY THIS 17th DAY OF MAY, 1976 AT 10 MINUTES PAST 11 O'CLOCK A.M. IN BOOK 4 OF MAPS AT PAGES 76 FILE NO. 6125 FEE: \$13⁰⁰

Dorothy Neer Marley
DOROTHY NEER MARLEY
PLUMAS COUNTY RECORDER
Lana J. Brown

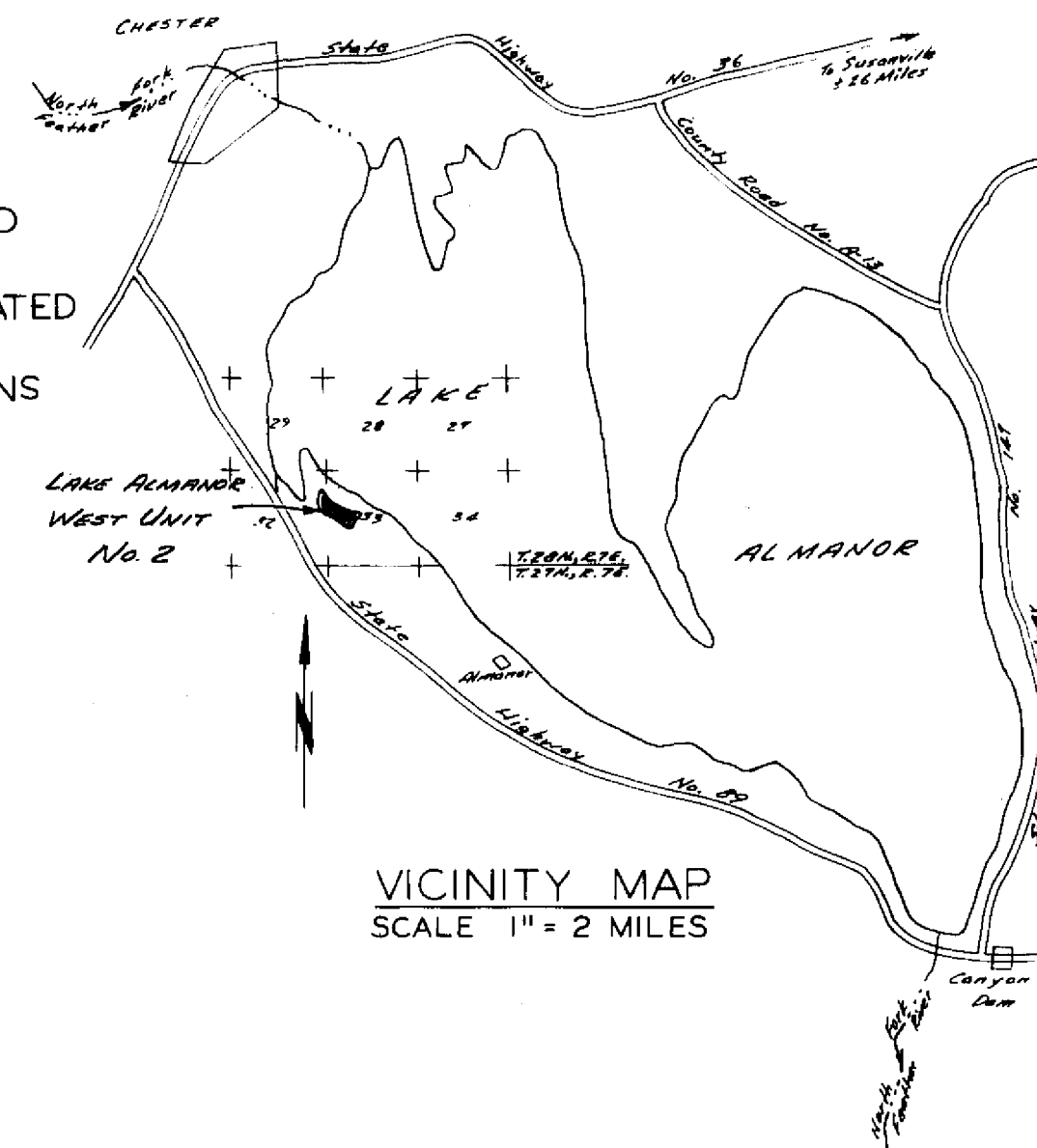

VICINITY MAP
SCALE 1" = 2 MILES

LAKE ALMANOR WEST UNIT NO. 2

IN A PORTION OF SECTIONS 32 & 33, T.28N., R.7E, M.D.B. & M.
PLUMAS COUNTY, CALIFORNIA

SCALE: 1" = 100'

OWNER & SUBDIVIDER: EDWARD C. CLIFFORD

PAUL E. SIMPSON, & ASSOCIATES, ENGINEERING-PLANNING-SURVEYING
SUSANVILLE, CALIFORNIA