

OWNER'S CERTIFICATE:

I, EDWARD C. CLIFFORD, TRUSTEE, HEREBY CERTIFY THAT I AM THE ONLY PERSON HAVING ANY RECORD TITLE INTEREST IN AND TO THE REAL PROPERTY INCLUDED WITHIN THE SUBDIVISION SHOWN UPON THIS MAP, AND THE ONLY PERSON WHOSE CONSENT IS NECESSARY TO PASS A CLEAR TITLE TO SAID PROPERTY, AND I CONSENT TO THE MAKING AND RECORDING OF THIS MAP. I HEREBY OFFER FOR DEDICATION THE RIGHTS-OF-WAY AND EASEMENTS FOR WATER AND SEWER LINES AND OVERHEAD AND UNDERGROUND WIRES, ON, OVER, AND UNDER THOSE STRIPS OF LAND DESIGNATED "PUBLIC UTILITIES EASEMENTS" AND EASEMENTS FOR DRAINAGE PURPOSES OVER THOSE STRIPS OF LAND DESIGNATED "DRAINAGE EASEMENTS" ALL OTHER EASEMENTS AS SHOWN ON THIS MAP ARE RESERVED FOR SPECIFIC PURPOSES AS NOTED. I ALSO OFFER FOR DEDICATION ALL STREETS AND ROADS WITHIN THIS SUBDIVISION FOR PUBLIC USE FOR COUNTY ROAD AND PUBLIC UTILITY PURPOSES.

*E. C. Clifford*  
EDWARD C. CLIFFORD, TRUSTEE

STATE OF California  
COUNTY OF Lassen

ON THIS 26<sup>th</sup> DAY OF August, 1976, BEFORE ME Becky L. Polan A NOTARY PUBLIC IN AND FOR SAID COUNTY RESIDING THEREIN, DULY COMMISSIONED AND SWORN, PERSONALLY APPEARED EDWARD C. CLIFFORD KNOWN TO ME TO BE THE PERSON WHOSE NAME IS SIGNED TO THE WITHIN INSTRUMENT, AND ACKNOWLEDGED TO ME THAT HE EXECUTED THE SAME. IN WITNESS WHEREOF I HAVE HEREUNTO SET MY HAND AND AFFIXED MY SEAL THE DAY AND YEAR IN THIS CERTIFICATE FIRST ABOVE WRITTEN.

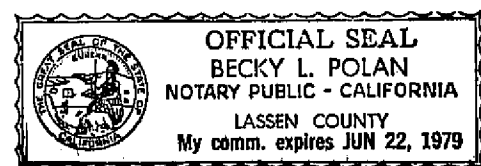

*Becky L. Polan*  
NOTARY  
MY COMMISSION EXPIRES 6-22-79

SURVEYOR'S CERTIFICATE:

THIS MAP WAS PREPARED BY ME OR UNDER MY DIRECTION AND IS BASED UPON A FIELD SURVEY IN CONFORMANCE WITH THE REQUIREMENTS OF THE SUBDIVISION MAP ACT AT THE REQUEST OF EDWARD C. CLIFFORD IN AUGUST, 1976. I HEREBY CERTIFY THAT IT CONFORMS TO THE APPROVED TENTATIVE MAP AND THE CONDITIONS OF APPROVAL THEREOF.

*Paul E. Simpson*  
PAUL E. SIMPSON R.C.E. 18585; L.S. 3702  
REGISTERED PROFESSIONAL ENGINEER No. 18585  
REGISTERED LAND SURVEYOR No. 3202  
CIVIL STATE OF CALIFORNIA

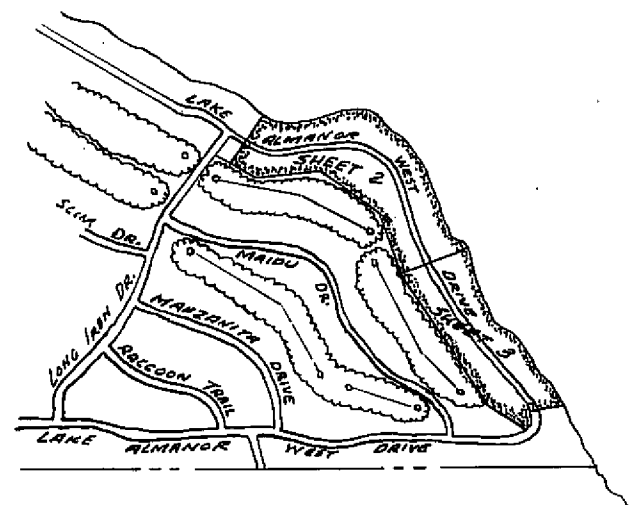

KEY MAP  
No Scale

COUNTY SURVEYOR'S CERTIFICATE:

THIS MAP CONFORMS WITH THE REQUIREMENTS OF THE SUBDIVISION MAP ACT AND LOCAL ORDINANCE.

DATED: 9-20-76

*Larry A. Fites*  
LARRY A. FITES, R.C.E. 13225  
PLUMAS COUNTY ENGINEER

NOTES:

1. THE BASIS OF BEARINGS IS THE MAP FILED FOR LAKE ALMANOR WEST UNIT NO. 1 IN MAP BOOK 4 AT PAGES 42-48.
2. SUBDIVISION ACREAGE  
TOTAL = 43.86 AC.  
LOTS = 39.11 AC.  
ROADS = 4.75 AC.  
AREAS = 0.00 AC.
3. ALL SEPTIC TANK & LEACHFIELD SYSTEMS INSTALLED ON THESE LOTS SHALL BE IN CONFORMANCE WITH THE "GUIDELINES FOR WASTE DISPOSAL FROM LAND DEVELOPMENTS" ESTABLISHED BY THE CALIFORNIA REGIONAL WATER QUALITY CONTROL BOARD, CENTRAL VALLEY REGION.
4. A SOILS AND GEOLOGIC REPORT ON THIS SUBDIVISION WAS PREPARED IN OCTOBER 1972 BY TOM CORDOVA, REGISTERED GEOLOGIST NO. 242, FOR EARTH SCIENCE CONSULTANTS ASSOCIATED, RENO, NEVADA.

COUNTY TAX COLLECTOR'S CERTIFICATE:

I, THE UNDERSIGNED, COUNTY TAX COLLECTOR OF THE COUNTY OF PLUMAS, STATE OF CALIFORNIA, DO HEREBY CERTIFY THAT THERE ARE NO TAX LIENS AGAINST LAKE ALMANOR WEST UNIT NO. 3 AS SHOWN HEREON, OR UNPAID STATE, COUNTY, MUNICIPAL, OR LOCAL TAXES, OR SPECIAL ASSESSMENTS COLLECTED AS TAXES, EXCEPT TAXES OR ASSESSMENTS NOT YET PAYABLE. TAXES OR ASSESSMENTS WHICH ARE A LIEN BUT NOT YET PAYABLE, ARE ESTIMATED TO BE IN THE AMOUNT OF NONE.

*Douglas S. Redstreake*  
DOUGLAS S. REDSTREAK  
PLUMAS COUNTY TAX COLLECTOR

COUNTY CLERK'S CERTIFICATE:

I DO HEREBY CERTIFY THAT ON THE 21 DAY OF September, 1976, THE PLUMAS COUNTY BOARD OF SUPERVISORS OFFICIALLY APPROVED THE SUBDIVISION MAPS OF LAKE ALMANOR WEST UNIT NO. 3. THE DEDICATIONS OFFERED AND SHOWN ON THIS MAP WERE ACCEPTED FOR THE USES NOTED.

*Raynelle Slaten*  
RAYNELLE SLATEN  
PLUMAS COUNTY CLERK

COUNTY RECORDER'S CERTIFICATE:

RECORDED IN THE OFFICE OF THE RECORDER OF PLUMAS COUNTY, STATE OF CALIFORNIA, AT THE REQUEST OF PLUMAS COUNTY TITLE COMPANY THIS 23<sup>rd</sup> DAY OF SEPTEMBER, 1976 AT 30 MINUTES PAST 11 O'CLOCK AM IN BOOK 4 AT PAGES 87, 88, 89 FILE NO. 2252 FEE: \$9.00

*Raynelle Slaten*  
RAYNELLE SLATEN  
PLUMAS COUNTY RECORDER  
*Diana B. Brown*

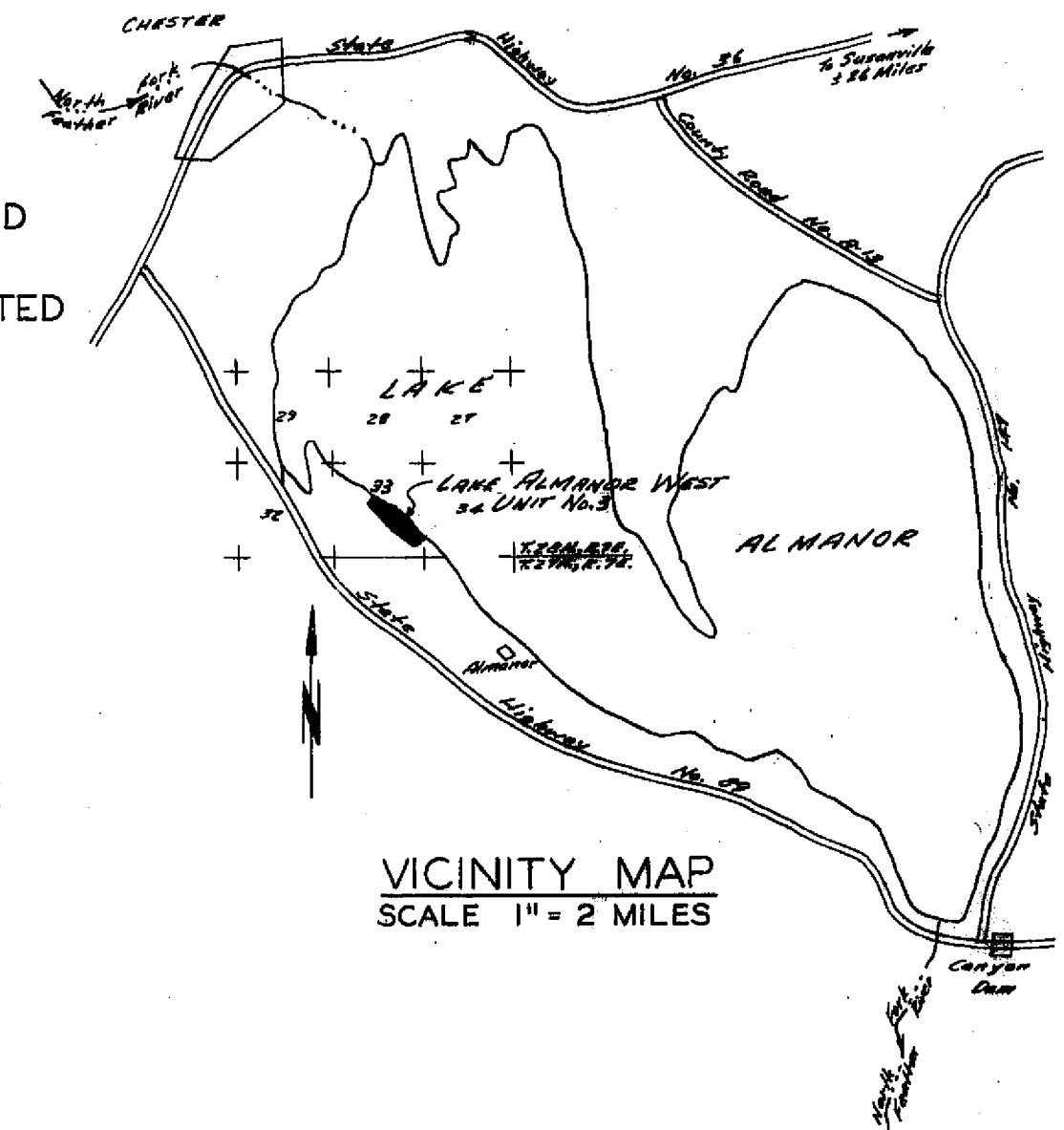

LAKE ALMANOR WEST UNIT NO. 3

IN A PORTION OF SECTIONS 33 & 34, T.28N., R.7E., M.D.B. & M.  
PLUMAS COUNTY, CALIFORNIA

SCALE: 1" = 100'

OWNER & SUBDIVIDER: EDWARD C. CLIFFORD

PAUL E. SIMPSON, & ASSOCIATES, ENGINEERING-PLANNING-SURVEYING  
SUSANVILLE, CALIFORNIA