

**OWNERS' CERTIFICATE**

We hereby certify that we are the owners of the land shown on this Parcel Map and consent to preparation and recording of this map, and that we are the only persons whose consent is required to pass clear title to said lands.

The easements shown on this map to be created by recordation thereof are created with our consent and are hereby dedicated or declared these easements to be for private use as indicated. Easements for public utilities, roads, and drainage facilities are hereby dedicated for public use.

PLUMAS-EUREKA ESTATES, a limited partnership

BY: John H. Kepler B. J. Pearson  
JOHN H. KEPLER, General Partner B. J. PEARSON, General Partner

STATE OF CALIFORNIA, COUNTY OF PLUMAS  
On this 9 day of ~~October~~ in the year 76, before me, a Notary Public in and for the said County and State, personally appeared JOHN H. KEPLER AND B. J. PEARSON, known to me to be the General Partners of the partnership that executed the within instrument, and acknowledged to me that such partnership executed the same. WITNESS my hand and seal.

John Seibel  
CAL-SIERRA TITLE COMPANY, CALIFORNIA CORPORATION, TRUSTEE & PLUMAS RECONVEYANCE CORPORATION, CALIFORNIA CORPORATION, TRUSTEE  
BY: David Windle  
DAVID WINDLE Vice-President

STATE OF CALIFORNIA, COUNTY OF PLUMAS  
On ~~November 9~~ 9, 1976, before me, the undersigned, a Notary Public in and for the said County and State, personally appeared DAVID WINDLE, known to me to be the VICE-PRESIDENT of the corporations that executed the within instrument, and known to me to be the person who executed the within instrument on behalf of the corporations therein named, and acknowledged to me that said corporations executed the within instrument pursuant to their by-laws or resolution of their boards of directors. WITNESS my hand and seal.

John Seibel  
OFFICIAL SEAL  
JOHN SEIBEL  
NOTARY PUBLIC - CALIFORNIA  
PLUMAS COUNTY  
My comm. expires APR 25, 1980

**COUNTY CLERK CERTIFICATE**

I, Raynelle Slaten, Clerk of the County of Plumas, State of California, and Ex-Officio Clerk of the Board of Supervisors of said county, hereby certify that the herein embodied map was approved by the said Board of Supervisors, convened in regular meeting upon the 9<sup>th</sup> day of Nov. 1976, and the easements as shown on the map were accepted for the uses noted.

Raynelle Slaten  
RAYNELLE SLATEN

**RECORDER'S CERTIFICATE**

Filed this 28<sup>th</sup> day of December, 1976, at 3:40 P.m. in Book 4 of MAPS at page 96, 97, at the request of PLUMAS-EUREKA ESTATES, a limited partnership.

Signed: Raynelle Slaten  
RAYNELLE SLATEN  
County Recorder

FEE: \$7<sup>00</sup>  
File No. 4884

**COUNTY SURVEYOR'S CERTIFICATE**

This map conforms with the requirements of the Subdivision Map Act and local ordinance.

Dated: 11-9-76 Signed: Larry A. Fites  
LARRY A. FITES, RCE #13225  
County Engineer

**ROAD COMMISSIONER'S CERTIFICATE**

The streets as shown hereon are hereby approved as to alignment, gradient and drainage.

Lawrence J. Brock  
Road Commissioner for Plumas County,  
California

**COUNTY TAX COLLECTOR'S CERTIFICATE**

I, Tax Collector of the County of Plumas, State of California, do hereby certify that there are no tax liens against the Parcels, as shown hereon, for unpaid county, municipal, or local taxes or special assessments collected as taxes, except taxes or assessments not yet payable. Taxes or assessments which are a lien but not yet payable, are estimated to be in the amount of \$ NONE.

Douglas S. Redstreake  
DOUGLAS S. REDSTRAKE  
Plumas County Tax Collector

**ENGINEER'S CERTIFICATE**

This map was prepared by me or under my direction and is based upon a field survey in conformance with the requirements of the Subdivision Map Act at the request of Plumas-Eureka Estates, a partnership, on July, 1975. I hereby certify that it conforms to the approved tentative map and the conditions of approval thereof.

Richard A. Lundy  
R. A. LUNDY R.C.E. 15265

**NOTE:**

Soils report made by William L. Effinger, Registered Geologist No. 1545, November 14, 1974.

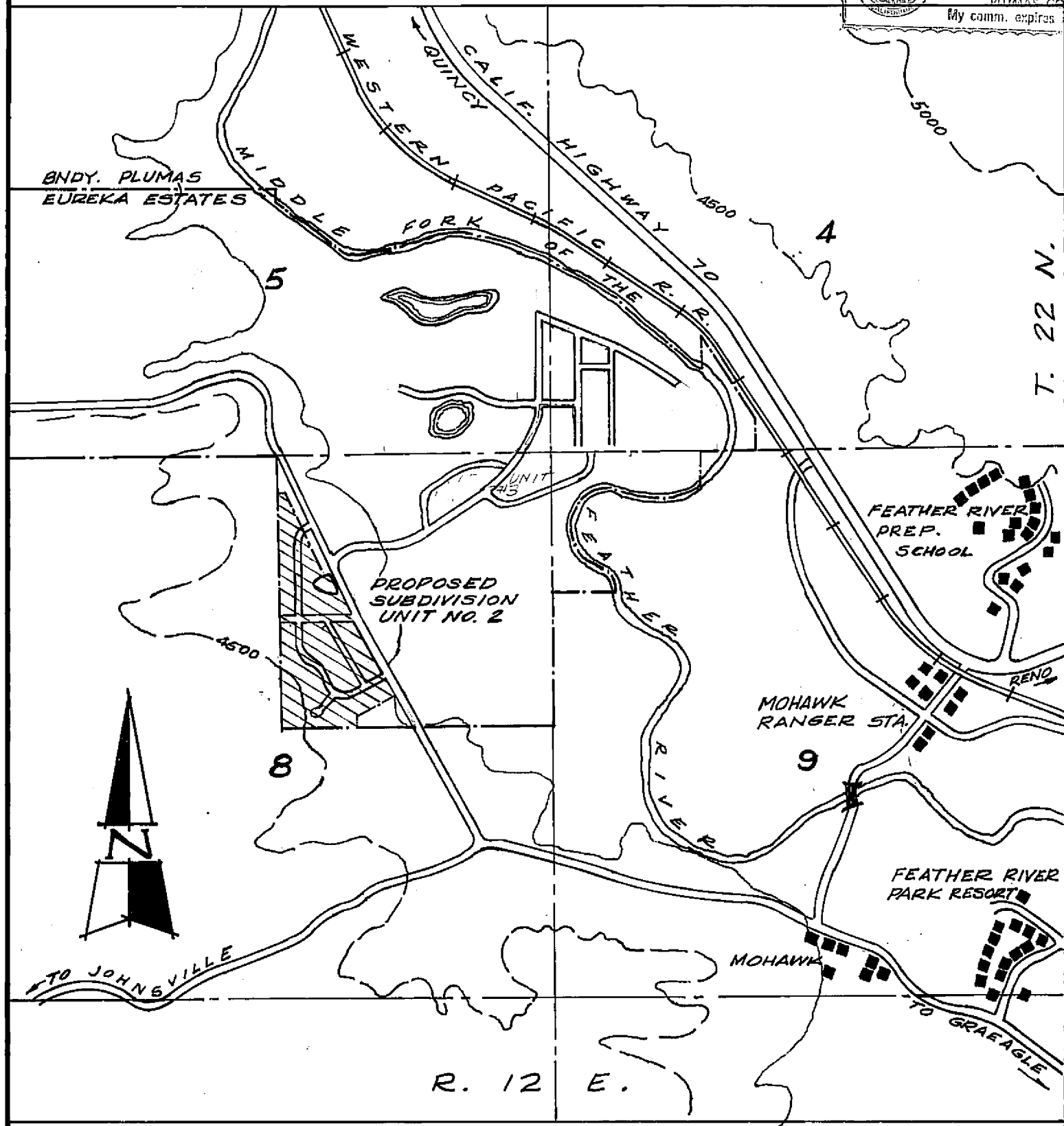

**LOCATION MAP**  
SCALE 1" = 1320'



**PLUMAS-EUREKA ESTATES  
UNIT NO. 2**  
WITHIN THE WEST 1/2 OF THE NE 1/4 OF  
SECTION 8, T. 22 N., R. 12 E., M.D.M.  
BLAIRSDEN, CALIFORNIA  
PLUMAS COUNTY, CALIFORNIA  
PLUMAS-EUREKA ESTATES  
A PARTNERSHIP  
JUNE, 1976  
LUNDY ENGINEERING  
GRAEAGLE, CALIFORNIA  
SHEET 1 OF 2 SHEETS