

OWNER'S CERTIFICATE

I hereby certify that I, am the owners of the land shown on this subdivision map and consent to preparation and recording of this map, and that I am the only person whose consent is required to pass clear title to said lands.

The easements shown on this map to be created by recordation thereof are created with my consent and are hereby dedicated or declared to be for private use as indicated. Easements for public utilities are hereby dedicated for public use.

Ruth L. Deatherage
Ruth L. Deatherage

STATE OF CALIFORNIA
COUNTY OF PLUMAS

On this 28th day of December 1978 before me, the undersigned, a Notary Public in and for said County and State, personally appeared Ruth L. Deatherage known to me to be the person whose name is subscribed to the within instrument and acknowledged that she executed the same.

Elizabeth Cammack
Elizabeth Cammack

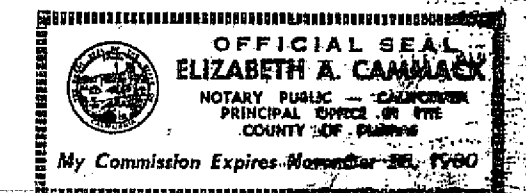

ENGINEER'S CERTIFICATE

This map was prepared by me and was compiled from record data and is based upon a field survey in conformance with the requirements of the Subdivision Map Act of the State of California. I hereby state that the subdivision map procedures of the local agency have been complied with and that this subdivision map conforms to the approved tentative map and the conditions of approval thereof which were required to be fulfilled prior to the filing of the subdivision map. The survey is true and complete as shown, that the monuments shown thereon exist and are of the character and occupy the positions indicated, and are sufficient to enable the survey to be retraced.

Darrell P. Payne
Darrell P. Payne (RCE # 8596)

COUNTY SURVEYOR'S CERTIFICATE

This map conforms with the requirements of the Subdivision Map Act and local ordinance.

Date June 5, 1979

Lawrence J. Brock
Lawrence J. Brock
County Surveyor

COUNTY TAX COLLECTOR'S CERTIFICATE

I, Tax Collector of the County of Plumas, State of California, do hereby certify that there are no tax liens against the Parcels, as shown hereon, for unpaid County, municipal or local taxes or special assessments collected as taxes, except taxes or assessments not yet payable. Taxes or assessments which are a lien but not yet payable are estimated to be in the amount of \$ 895.00.

Lois Alexander
Lois Alexander
Plumas County Tax Collector

COUNTY CLERK'S CERTIFICATE

I, Raynelle Slaten, Clerk of the County of Plumas, State of California, and Ex-Officio Clerk of the Board of Supervisors of said County, hereby certify that the herein embodied map was approved by the said Board of Supervisors convened in regular meeting upon the 13th day of June 1979, and the easements as shown on the map were accepted for uses noted.

Raynelle Slaten
Raynelle Slaten

RECORDER'S CERTIFICATE

Filed this 6th day of June 1979, at 2:07 p.m. in Book 4 of Maps at Page 131, at the request of Darrell P. Payne.

Fee \$ 5.00
File No. 9271

Raynelle Slaten
Raynelle Slaten
County Recorder
by *Judith L. Andrew*
Deputy

LEGEND

- ◆ Found Monument as noted
- Set 3/4" Iron Pipe with Brass tag RCE 8596
- Easements as noted
- Leach exclusion line
- P.U.E. Public Utility Easement & Pacific Telephone Co.

ROAD NOTE

Roads shown hereon are not subject to County improvement or maintenance. It will be required that such roads be improved to County Standard at no cost to the County before such roads will be accepted into the County Road system.

BASIS OF BEARINGS is the North boundary line shown on the Record of Survey Map filed in Book 4 R/S of Page 103 as "N 89° 37' 17" W 2643.84'".

ACREAGE of Summit Acres Subdivision = 121.871 Acres
Area in Roads = 8.772 Acres
Area in Lots = 113.099 Acres

LEACH EXCLUSION AREAS

Areas within 50' of drainage ways and 100' of springs and wells are not available for leachfield use. Other areas shown as Leach Exclusion Area are also not available unless it is shown that no hardpan exists or the hardpan can be broken permitting leaching to function.

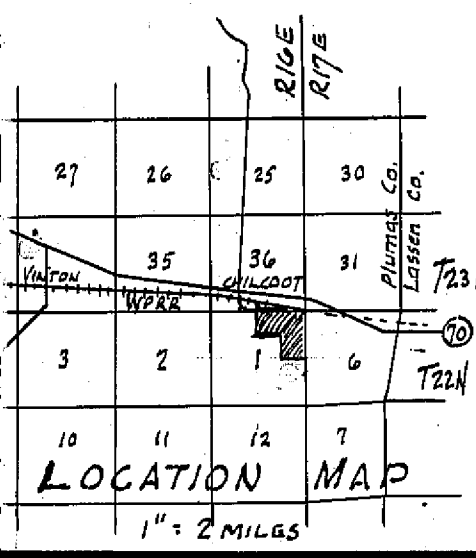

SUMMIT ACRES

Subdivision
Portion of NE 1/4, Section 1, T22N, R16E, MDB&M, Plumas County, California, for
& SE 1/4, Section 36, T23N, R16E
Ruth L. Deatherage P.O. Box 54 Chilcoot, California
Darrell P. Payne Civil Engineer Route 1 Box 81 Quincy California
SHEET 1 of 1