

**OWNER'S CERTIFICATE**

WE HEREBY CERTIFY THAT WE ARE THE OWNERS OF THE LAND SHOWN ON THIS SUBDIVISION MAP AND CONSENT TO THE PREPARATION AND RECORDING OF THIS MAP, AND THAT WE ARE THE ONLY PERSONS WHOSE CONSENT IS REQUIRED TO PASS CLEAR TITLE OF SAID LAND.

Robert F. Carmody  
ROBERT F. CARMODY  
Carol H. Carmody  
CAROL H. CARMODY

**NOTARY**

STATE OF CALIFORNIA )  
COUNTY OF PLUMAS ) SS

ON THIS 26 DAY OF April, 1982, BEFORE ME, THE UNDERSIGNED, A NOTARY PUBLIC IN AND FOR SAID COUNTY AND STATE, PERSONALLY APPEARED ROBERT F. CARMODY AND CAROL H. CARMODY, KNOWN TO ME TO BE THE PERSONS WHOSE NAMES ARE SUBSCRIBED TO THE WITHIN INSTRUMENT AND ACKNOWLEDGED THAT THEY EXECUTED THE SAME.

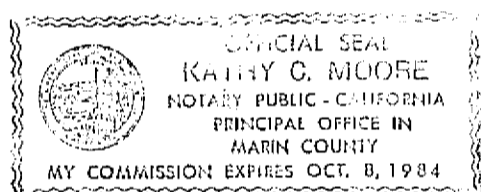

Kathy C. Moore  
NOTARY PUBLIC  
10-8-84  
MY COMMISSION EXPIRES

**TRUSTEE CERTIFICATE**

MID-VALLEY TITLE AND ESCROW COMPANY, A CALIFORNIA CORPORATION, AS TRUSTEE UNDER THOSE DEEDS OF TRUST DATED MARCH 4, 1980, RECORDED IN BOOK 328 O.R. PAGE 69, AND DATED MARCH 7, 1980, RECORDED IN BOOK 328 O.R. PAGE 75, DOES HEREBY CONSENT TO THE PREPARATION AND RECORDING OF THIS MAP.

MID-VALLEY TITLE AND ESCROW  
Warren Dutton

**NOTARY**

STATE OF CALIFORNIA )  
COUNTY OF PLUMAS ) SS

ON THIS 12 DAY OF January, 1983, BEFORE ME, THE UNDERSIGNED, A NOTARY PUBLIC IN AND FOR SAID COUNTY AND STATE, PERSONALLY APPEARED Warren Dutton KNOWN TO ME TO BE THE Vice President OF THE CORPORATION THAT EXECUTED THE WITHIN INSTRUMENT AND PROVED TO ME ON THE BASIS OF SATISFACTORY EVIDENCE TO BE THE PERSON WHO EXECUTED IT ON BEHALF OF SUCH CORPORATION AND ACKNOWLEDGED TO ME THAT SAID CORPORATION EXECUTED THE SAME.

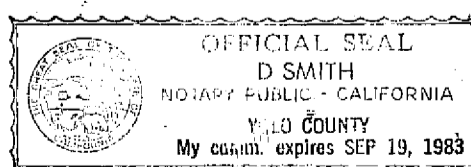

D. Smith  
NOTARY PUBLIC  
9-19-83  
MY COMMISSION EXPIRES

**COUNTY SURVEYOR'S CERTIFICATE**

I HAVE EXAMINED THIS MAP AND FIND IT IS SUBSTANTIALLY THE SAME AS IT APPEARED ON THE TENTATIVE MAP AND ANY APPROVED ALTERATIONS THEREOF. ALL PROVISIONS OF THE SUBDIVISION MAP ACT AND LOCAL ORDINANCES APPLICABLE AT THE TIME OF APPROVAL OF THE TENTATIVE MAP HAVE BEEN COMPLIED WITH; AND I AM SATISFIED THAT THE MAP IS TECHNICALLY CORRECT.

DATED: Feb 15, 1983

Lawrence J. Brock  
LAWRENCE J. BROCK  
PLUMAS COUNTY ENGINEER

**COUNTY TAX COLLECTOR'S CERTIFICATE**

I, BARBARA J. COKOR, TAX COLLECTOR OF THE COUNTY PLUMAS, STATE OF CALIFORNIA, DO HEREBY CERTIFY THAT THERE ARE NO TAX LIENS AGAINST THE LOTS AS SHOWN HEREON FOR UNPAID COUNTY, MUNICIPAL OR LOCAL TAXES OR SPECIAL ASSESSMENTS COLLECTED AS TAXES, EXCEPT TAXES OR ASSESSMENTS NOT YET PAYABLE. TAXES OR ASSESSMENTS WHICH ARE A LIEN BUT NOT YET PAYABLE ARE ESTIMATED TO BE IN THE AMOUNT OF \$ None.

DATED: Feb 18, 1983

Barbara J. Cokor by Jimmy Schuster, Asst.  
BARBARA J. COKOR  
PLUMAS COUNTY TAX COLLECTOR

**ENGINEER'S CERTIFICATE**

THIS MAP AND THE SURVEY PERFORMED THEREFORE IN MAY 1982, WERE MADE BY ME OR UNDER MY DIRECTION. THE SURVEY IS TRUE AND COMPLETE AS SHOWN. ALL MONUMENTS SHOWN HEREON ARE OF THE CHARACTER AND OCCUPY THE POSITIONS INDICATED AND ARE SUFFICIENT TO ENABLE THE SURVEY TO BE RETRACED.

Clifford R. Brown  
CLIFFORD R. BROWN R.C.E. 22836

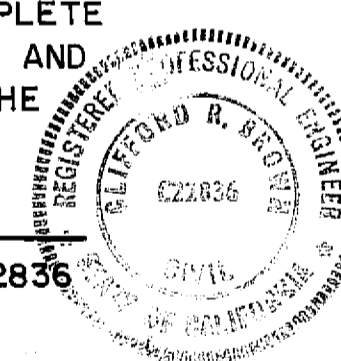

**COUNTY RECORDER'S CERTIFICATE**

FILED THIS 23 DAY OF February 1983, AT 9:41 A.M., IN BOOK 5 OF MAPS AT PAGE 21 AT THE REQUEST OF THE COUNTY ENGINEER.

FEE: \$7.00

FILE NO. 5876

ILA DIGGS, COUNTY RECORDER  
by: Frances Nicol  
DEPUTY

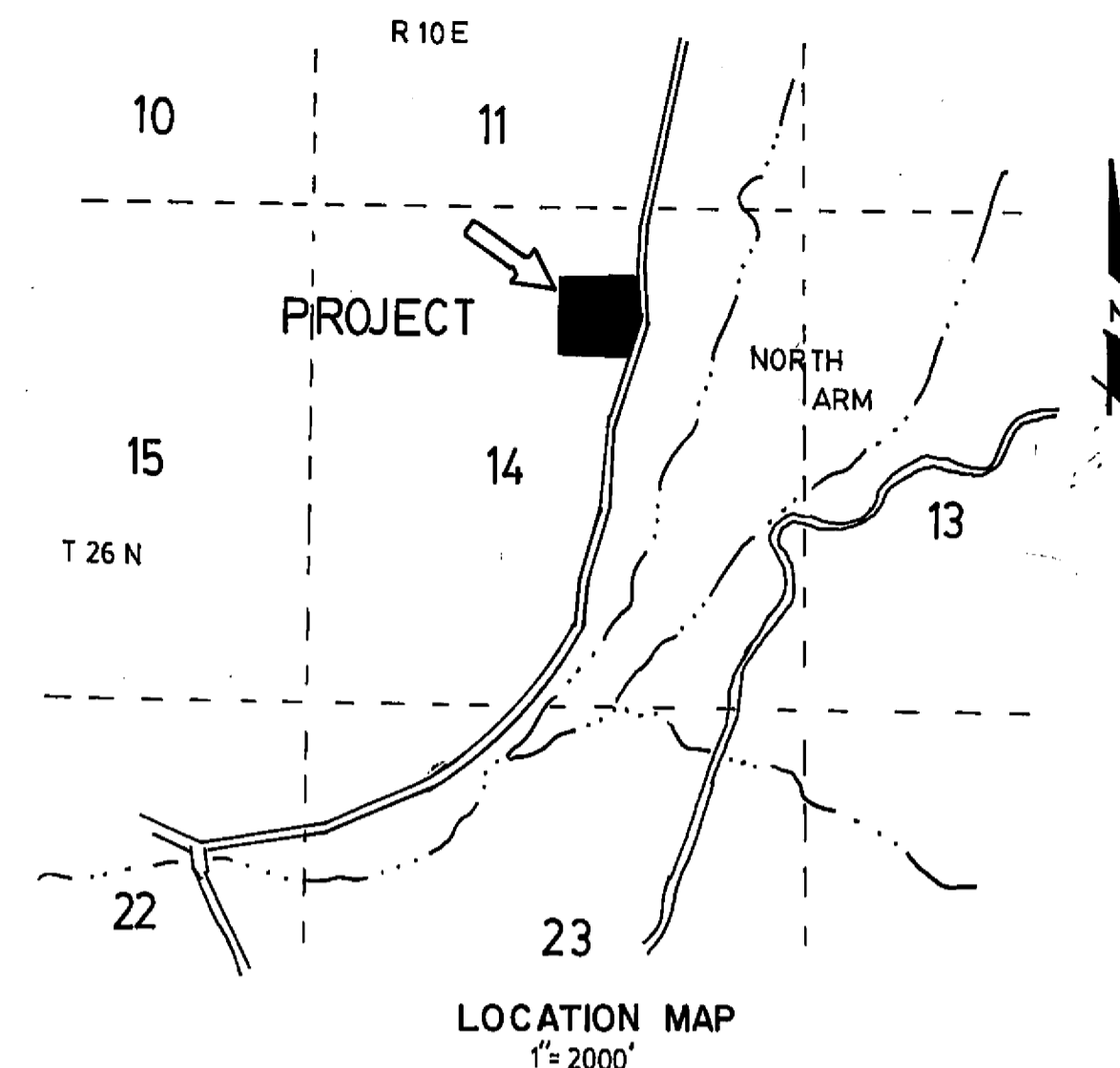

**COUNTY CLERK'S CERTIFICATE**

I, ILA DIGGS, CLERK OF THE COUNTY OF PLUMAS, STATE OF CALIFORNIA AND EX-OFFICIO CLERK OF THE BOARD OF SUPERVISORS OF SAID COUNTY, HEREBY CERTIFY THAT THE HEREIN EMBODIED MAP WAS APPROVED BY THE SAID BOARD OF SUPERVISORS, CONVENED IN REGULAR MEETING UPON THE 15th DAY OF February 1983.

Ila Diggs  
ILA DIGGS  
PLUMAS COUNTY CLERK

**JUNIPER LANE SUBDIVISION  
AND  
P.U.D.**

BEING A PORTION OF THE NORTH EAST QUARTER OF SECTION 14 T26N R10E MDB&M PLUMAS Co. CALIFORNIA

DEVELOPER: ROBERT F. CARMODY AND CAROL H. CARMODY  
ENGINEER: CLIFFORD R. BROWN Engineering & Surveying  
Rt. 1 Box 480-B, Quincy, California

MAY 1982