

OWNER'S STATEMENT

I, Galen R. Mitchell having record title interest in the hereon subdivided lands, do hereby consent to the preparation and recordation of this map. I hereby offer for dedication the public utility easements along the private road being "Neison Lane," "Mitchell Lane," on this map.

Galen R. Mitchell

NOTARY ACKNOWLEDGEMENT

STATE OF CALIFORNIA)
COUNTY OF PLUMAS)

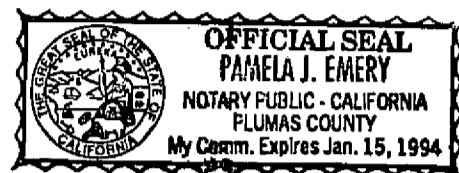

On this 3rd day of July, 1990, before me, the undersigned, a Notary Public in and for said state, personally appeared Galen R. Mitchell personally known to me, or proved to me on the basis of satisfactory evidence, to be the persons whose names are subscribed to the within instrument, and acknowledged to me that they executed it.

Witness my hand and official seal

Pamela J. Emery
Signature

COUNTY SURVEYOR'S STATEMENT

I have examined this map and find it substantially the same as it appeared on the tentative map and any approved alterations thereof. All provisions of the Subdivision Map Act and any local ordinances applicable at the time of approval of the tentative map have been complied with; and I am satisfied that the map is technically correct.

Dated Oct 23, 1990
By Lawrence J. Brock RCE 13528
Plumas County Surveyor

TRUSTEE'S CERTIFICATE

Cal-Sierra Title Company, a California Corporation, as trustee under a Deed of Trust dated March 10, 1989, and recorded in Book 499 of Official Records at page 586, ford hereby consent to the preparation and recording of this map.

Cal-Sierra Title Company

By David O. Windle
President

STATE OF CALIFORNIA)
COUNTY OF PLUMAS) SS

On 23 Day of October, 1990, before me, the undersigned, a Notary Public in and for said county and state, personally appeared, David O. Windle, personally known to me (or proved to me on the basis of satisfactory evidence) to be president of the corporation that executed the within instrument, and known to me to be the person who executed the same on behalf of said corporation and acknowledged to me that said corporation executed the same.

John Seibel
Notary Public in and for said County and State
Exp. 5-3-92

COUNTY TAX COLLECTOR'S CERTIFICATE

I, Barbara J. Coates, Tax Collector of the County of Plumas, State of California, do hereby certify that there are no tax liens against the Parcels, as shown hereon, for unpaid state, county, municipal, or local taxes or special assessments collected as taxes, except taxes or assessments not yet payable. Taxes or assessments which are a lien but not yet payable, are estimated to be in the amount of \$1,050.00

Dated 10/15/90

Barbara J. Coates by Ginny Schoeder, asst.
Barbara J. Coates
Plumas County Tax Collector

SURVEYOR'S STATEMENT

This map and the survey performed therefore in May 1990 were made by me or under my direction. The survey is true and complete as shown. All of the monuments shown hereon are of the character and occupy the positions indicated and are sufficient to enable the survey to be retraced.

Dated 7-6-90

Clifford R. Brown RCE 22836

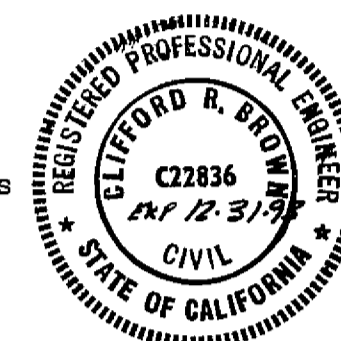

COUNTY RECORDER'S CERTIFICATE

Filed this 24th day of October, 1990, at 8:45 A.m. in Book 6 of Maps, at page 135, at the request of the County Engineer.

Fee \$11.00

File No. 8202

Judith Wells
County Recorder

by Sue A. Deary
Deputy

COUNTY CLERK'S CERTIFICATE

I, Judith Wells, Clerk of the County of Plumas, State of California, and Ex-Officio Clerk of the Board of Supervisors of said county, hereby certify that the herein embodied map was approved by the said Board of Supervisors convened in a regular meeting upon the 23rd day of October, 1990, and the offer of dedication for public utility easements as shown on the map were accepted for the uses noted.

Dated Oct. 24, 1990

Judith Wells
County Clerk

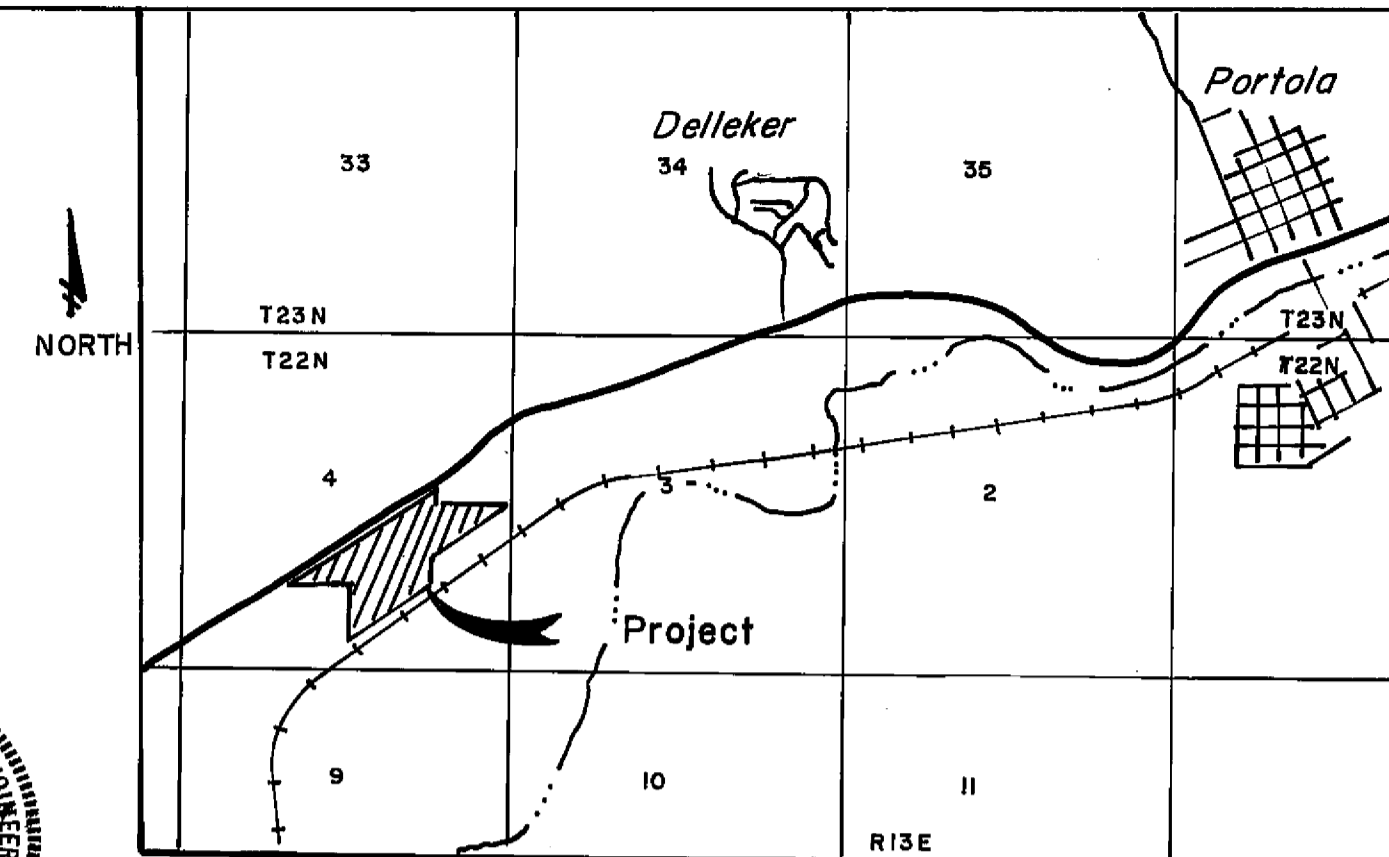

LOCATION MAP
1" = 3100'

"MITCHELL TRACT"

A Planned Development

A Subdivision of 9 lots within a portion of Section 4 of T22N, R13E, MDBM near Delleker, Plumas County, CA.

Owner: Galen R. Mitchell
3395 War Paint Circle
Reno, Nevada 89506 (702)789-0207

Engineer: Cliff Brown Engineering & Survey
2335 Pondersa
Quincy, CA 95971 283-3959

May 1990

Sheet 1 of 4