

OWNER'S STATEMENT

WE HEREBY CERTIFY THAT WE ARE THE OWNERS OF THE LAND SHOWN ON THIS SUBDIVISION MAP AND CONSENT TO PREPARATION AND RECORDING OF THIS MAP, AND THAT WE ARE THE ONLY PERSONS WHOSE CONSENT IS REQUIRED TO PASS CLEAR TITLE TO SAID LANDS. JAMISON ROAD, PENMAN LANE AND MINERS LANE AS SHOWN ARE HEREBY DEDICATED FOR PUBLIC ROAD AND DRAINAGE PURPOSES AND FOR PUBLIC UTILITY FACILITIES AND PUBLIC UTILITY EASEMENT PURPOSES. THE UTILITY EASEMENTS (U.E.) SHOWN ON THIS MAP ARE HEREBY RESERVED, FOR INSTALLATION, MAINTENANCE AND REPAIR OF ALL UNDERGROUND ELECTRICAL, TELEPHONE AND CABLE TELEVISION CABLES, DUCTS AND RELATED FACILITIES, TOGETHER WITH THE RIGHT TO TRIM AND REMOVE, AS OFTEN AS NECESSARY, TREES, LIMBS AND BRUSH, AND ARE GRANTED TO THE RESPECTIVE SERVING UTILITY COMPANIES AND CABLE TELEVISION COMPANY CONCURRENTLY WITH THE FILING OF THIS MAP. THIS GRANT OF EASEMENT IS RECORDED IN VOLUME 492 OF OFFICIAL RECORDS AT PAGE 237, PLUMAS COUNTY RECORDS. THE 15 FOOT WIDE WATER MAIN EASEMENTS SHOWN ON THIS MAP ARE HEREBY RESERVED FOR CONTINUED USE, MAINTENANCE AND REPAIR OF THE WATER TRANSMISSION MAINS AND APPURTENANCES, AND ARE GRANTED TO THE SMITH CREEK MUTUAL WATER COMPANY CONCURRENTLY WITH THE FILING OF THIS MAP. THIS GRANT OF EASEMENT IS RECORDED IN VOLUME 492 OF OFFICIAL RECORDS AT PAGE 233, PLUMAS COUNTY RECORDS.

FEATHER RIVER ASSOCIATES

John P. Helm
JOHN P. HELM
GENERAL PARTNER

Joseph M. Ducote
JOSEPH M. DUCOTE
GENERAL PARTNER

Mac Gregor C. Dawson
MAC GREGOR C. DAWSON
GENERAL PARTNER

STATE OF CALIFORNIA)
COUNTY OF SAN FRANCISCO) SS.

ON THIS 1st DAY OF MAY, 1988, BEFORE ME, THE UNDERSIGNED, A NOTARY PUBLIC IN AND FOR SAID COUNTY AND STATE, PERSONALLY APPEARED, JOHN P. HELM, JOSEPH M. DUCOTE AND MAC GREGOR DAWSON PERSONALLY KNOWN TO ME (OR PROVED TO ME ON THE BASIS OF SATISFACTORY EVIDENCE) TO BE THE GENERAL PARTNERS OF THE PARTNERSHIP THAT EXECUTED THE WITHIN INSTRUMENT, AND ACKNOWLEDGED TO ME THAT SUCH PARTNERSHIP EXECUTED THE SAME.

L.A. Ross
NOTARY PUBLIC IN AND FOR SAID COUNTY AND STATE
6-21-90
MY COMMISSION EXPIRES:

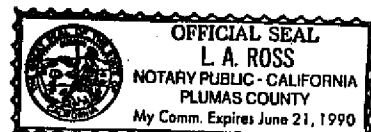

TITLE INSURANCE AND TRUST COMPANY, A CALIFORNIA CORPORATION AS TRUSTEE UNDER THAT DEED OF TRUST DATED AUGUST 6TH, 1980, AND RECORDED IN BOOK 333 OF OFFICIAL RECORDS AT PAGE 489, DOES HEREBY CONSENT TO THE PREPARATION AND FILING OF THIS MAP.

BY: *Sandra Pence*
SANDRA PENCE
ASSISTANT VICE-PRESIDENT

STATE OF CALIFORNIA)
COUNTY OF PLUMAS) SS.

ON THIS 15th DAY OF NOVEMBER, 1988, BEFORE ME, THE UNDERSIGNED, A NOTARY PUBLIC IN AND FOR SAID COUNTY AND STATE, PERSONALLY APPEARED, SANDRA PENCE, PERSONALLY KNOWN TO ME (OR PROVED TO ME ON THE BASIS OF SATISFACTORY EVIDENCE) TO BE THE ASSISTANT VICE-PRESIDENT OF THE CORPORATION THAT EXECUTED THE WITHIN INSTRUMENT, AND ACKNOWLEDGED TO ME THAT SUCH CORPORATION EXECUTED THE WITHIN INSTRUMENT PURSUANT TO ITS BY-LAWS OR A RESOLUTION OF ITS BOARD OF DIRECTORS.

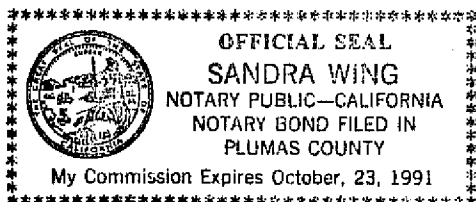

Sandra Wing
NOTARY PUBLIC IN AND FOR SAID COUNTY AND STATE
10/23/91
MY COMMISSION EXPIRES:

FIRST FINANCIAL SERVICE CORPORATION, A NEVADA CORPORATION AS TRUSTEE UNDER THAT DEED OF TRUST DATED OCTOBER 18th, 1980, AND RECORDED IN BOOK 336 OF OFFICIAL RECORDS AT PAGE 96, AND ALSO THAT DEED OF TRUST DATED FEBRUARY 2, 1981, AND RECORDED IN BOOK 344 OF OFFICIAL RECORDS AT PAGE 159, DOES HEREBY CONSENT TO THE PREPARATION AND FILING OF THIS MAP.

BY: *Ron L. Hoy*
RON L. HOY
VICE-PRESIDENT

STATE OF NEVADA)
COUNTY OF WASHOE) SS.

ON THIS 14th DAY OF November, 1988, BEFORE ME, THE UNDERSIGNED, A NOTARY PUBLIC IN AND FOR SAID COUNTY AND STATE, PERSONALLY APPEARED, RON L. HOY, PERSONALLY KNOWN TO ME (OR PROVED TO ME ON THE BASIS OF SATISFACTORY EVIDENCE) TO BE THE VICE-PRESIDENT OF THE CORPORATION THAT EXECUTED THE WITHIN INSTRUMENT, AND ACKNOWLEDGED TO ME THAT SUCH CORPORATION EXECUTED THE WITHIN INSTRUMENT PURSUANT TO ITS BY-LAWS OR A RESOLUTION OF ITS BOARD OF DIRECTORS.

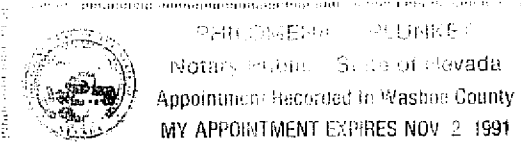

Phyllis T. Plunkett
NOTARY PUBLIC IN AND FOR SAID COUNTY AND STATE
November 2, 1991
MY COMMISSION EXPIRES:

COUNTY CLERK'S CERTIFICATE

I, ILA DIGGS, CLERK OF THE COUNTY OF PLUMAS, STATE OF CALIFORNIA, AND EX-OFFICIO CLERK OF THE BOARD OF SUPERVISORS OF SAID COUNTY, HEREBY CERTIFY THAT THE HEREIN EMBODIED MAP WAS APPROVED BY SAID BOARD OF SUPERVISORS CONVENED IN A REGULAR MEETING UPON THE 22nd DAY OF November, 1988, AND THE ROADS AS SHOWN ON THE MAP WERE ACCEPTED FOR THE PUBLIC USES NOTED.

Ila Diggs
ILA DIGGS
COUNTY CLERK

COUNTY TAX COLLECTOR'S CERTIFICATE

I, BARBARA J. COATES, TAX COLLECTOR OF THE COUNTY OF PLUMAS, STATE OF CALIFORNIA, DO HEREBY CERTIFY THAT THERE ARE NO TAX LIENS AGAINST THE LOTS AS SHOWN HEREON, FOR UNPAID COUNTY, MUNICIPAL, OR LOCAL TAXES OR SPECIAL ASSESSMENTS COLLECTED AS TAXES, EXCEPT TAXES OR ASSESSMENTS NOT YET PAYABLE. TAXES OR ASSESSMENTS WHICH ARE A LIEN BUT NOT YET PAYABLE, ARE ESTIMATED TO BE IN THE AMOUNT OF \$ NONE.

DATED: 11/21/88 *Barbara J. Coates*
BARBARA J. COATES
PLUMAS COUNTY TAX COLLECTOR

COUNTY SURVEYOR'S CERTIFICATE

I HAVE EXAMINED THIS MAP AND FIND IT IS SUBSTANTIALLY THE SAME AS IT APPEARED ON THE TENTATIVE MAP AND ANY APPROVED ALTERATIONS THEREOF. ALL PROVISIONS OF THE SUBDIVISION MAP ACT AND ANY LOCAL ORDINANCES APPLICABLE AT THE TIME OF APPROVAL OF THE TENTATIVE MAP HAVE BEEN COMPLIED WITH; AND I AM SATISFIED THAT THE MAP IS TECHNICALLY CORRECT.

DATED: 11/22/88 SIGNED: *Lawrence J. Brock*
LAWRENCE J. BROCK R.C.E. 13528
COUNTY SURVEYOR

COUNTY RECORDER'S CERTIFICATE

FILED THIS 22nd DAY OF November, 1988 AT 12:10 P.M. IN BOOK 6 OF MAPS, AT PAGE 68-71, AT THE REQUEST OF THE COUNTY ENGINEER.

FEE: # 11⁰⁰
FILE NO.: 492

ILA DIGGS
COUNTY RECORDER
BY: *Bob Cammack*
DEPUTY

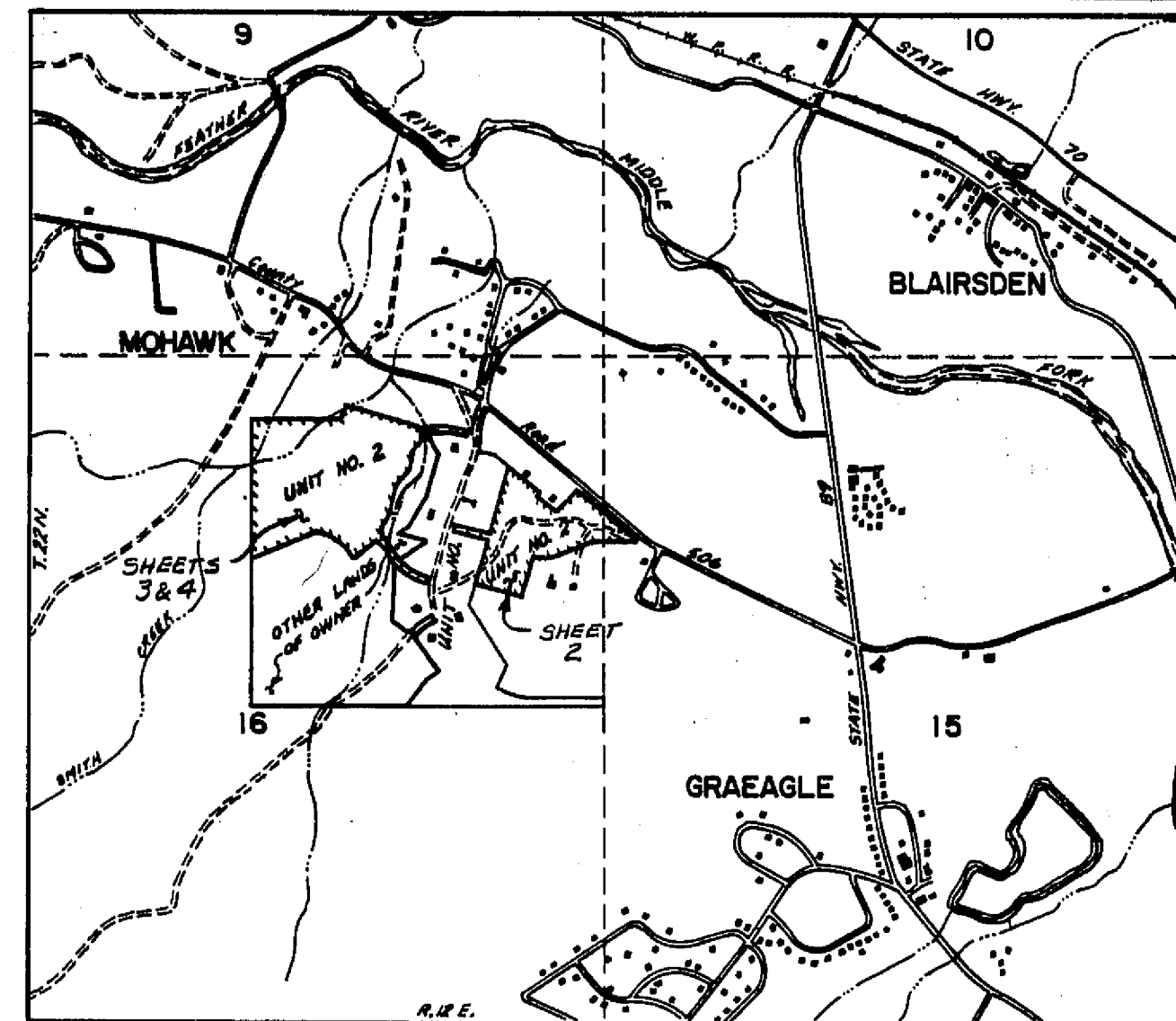

LOCATION MAP
SCALE: 1" = 1/4 MILE

ENGINEER'S STATEMENT

THIS MAP AND THE SURVEY PERFORMED THEREFOR IN JANUARY 1988, WERE MADE BY ME OR UNDER MY DIRECTION. THE SURVEY IS TRUE AND COMPLETE AS SHOWN. ALL THE MONUMENTS SHOWN HEREON ARE OF THE CHARACTER AND OCCUPY THE POSITIONS INDICATED, OR THEY WILL BE SET IN SUCH POSITIONS ON OR BEFORE ONE YEAR AFTER THE RECORDATION OF THIS MAP BY THE PLUMAS COUNTY RECORDER. THE MONUMENTS ARE, OR WILL BE, SUFFICIENT TO ENABLE THE SURVEY TO BE RETRACED.

Larry A. Fites
LARRY A. FITES
R.C.E. 13225

**GOLD RIDGE SUBDIVISION
UNIT NO. 2**

A PLANNED DEVELOPMENT
FOR
FEATHER RIVER ASSOCIATES
BEING A PORTION OF SECTIONS
15 AND 16, T. 22N., R. 12E., M.D.B.&M.
IN PLUMAS COUNTY, CALIFORNIA

LARRY FITES ENGINEERING
P.O. BOX 308
GRAEAGLE, CALIFORNIA 96103
R.C.E. 13225

FEBRUARY, 1988

SHEET 1 OF 4