

OWNERS'S STATEMENT

THE UNDERSIGNED HEREBY CERTIFY THAT THEY ARE THE OWNERS OF THE LAND SHOWN ON THIS SUBDIVISION MAP AND CONSENT TO THE PREPARATION AND RECORDING OF THIS MAP, AND THAT THEY ARE THE ONLY PERSONS WHOSE CONSENT IS REQUIRED TO PASS CLEAR TITLE TO SAID LAND.

THE EASEMENTS SHOWN ON THIS MAP TO BE CREATED BY RECORDATION THEREOF ARE CREATED WITH OUR CONSENT AND ARE HEREBY DECLARED TO BE FOR PRIVATE USE AS INDICATED. EASEMENTS FOR PUBLIC UTILITIES ARE HEREBY DEDICATED FOR PUBLIC USES.

RAMELLI INVESTMENT GROUP, A LIMITED PARTNERSHIP

Signature of William W. Harberts, WILLIAM W. HARBERTS A GENERAL PARTNER

Signature of Joseph B. Kroeson, JOSEPH B. KROESON A GENERAL PARTNER

NOTARY

STATE OF CALIFORNIA) ss COUNTY OF PLUMAS )

ON 31 January 1989, BEFORE ME, THE UNDERSIGNED, A NOTARY PUBLIC IN AND FOR SAID STATE, PERSONALLY APPEARED WILLIAM W. HARBERTS AND JOSEPH B. KROESON, KNOWN TO ME TO BE BOTH OF THE GENERAL PARTNERS OF THE PARTNERSHIP THAT EXECUTED THE WITHIN INSTRUMENT, AND ACKNOWLEDGED TO ME THAT SUCH PARTNERSHIP EXECUTED THE SAME. WITNESS MY HAND AND OFFICIAL SEAL

Signature of Julie A. Bunto, NOTARY PUBLIC

March 10, 1989 MY COMMISSION EXPIRES

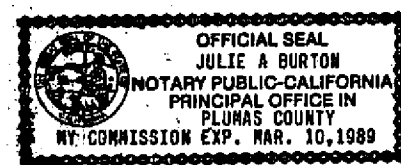

SURVEYOR'S STATEMENT

THIS MAP AND THE SURVEY PERFORMED THEREFORE IN OCTOBER, 1988 WERE MADE BY ME OR UNDER MY DIRECTION. THE SURVEY IS TRUE AND COMPLETE AS SHOWN. ALL OF THE MONUMENTS SHOWN HEREON ARE OF THE CHARACTER AND OCCUPY THE POSITIONS INDICATED AND ARE SUFFICIENT TO ENABLE THE SURVEY TO BE RETRACED.

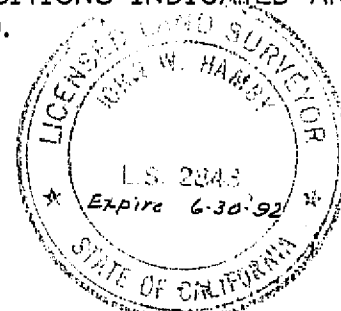

Signature of John W. Hamby, JOHN W. HAMBY L.S. 2843

COUNTY CLERK'S CERTIFICATE

I, ILA DIGGS, CLERK OF THE COUNTY OF PLUMAS, STATE OF CALIFORNIA AND EX-OFFICIO CLERK OF THE BOARD OF SUPERVISORS OF SAID COUNTY, HEREBY CERTIFY THAT THE HEREIN EMBODIED MAP WAS APPROVED BY THE SAID BOARD OF SUPERVISORS CONVENED IN REGULAR MEETING UPON THE 4th DAY OF April 1989, AND THE OFFER OF DEDICATION FOR PUBLIC UTILITY EASEMENTS AS SHOWN ON THE MAP WAS ACCEPTED FOR THE USES NOTED.

DATED: 4-4-89

Signature of Ila Diggs, ILA DIGGS PLUMAS COUNTY CLERK

COUNTY SURVEYOR'S CERTIFICATE

I HAVE EXAMINED THIS MAP AND FIND IT IS SUBSTANTIALLY THE SAME AS IT APPEARED ON THE TENTATIVE MAP AND ANY APPROVED ALTERATIONS THEREOF. ALL PROVISIONS OF THE SUBDIVISION MAP ACT AND ANY LOCAL ORDINANCES APPLICABLE AT THE TIME OF APPROVAL OF THE TENTATIVE MAP HAVE BEEN COMPLIED WITH, AND I AM SATISFIED THAT THE MAP IS TECHNICALLY CORRECT.

DATED 4/1/89

Signature of Lawrence J. Brock, LAWRENCE J. BROCK RCE 13528 PLUMAS COUNTY SURVEYOR

COUNTY TAX COLLECTOR'S CERTIFICATE

I, BARBARA J. COATES, TAX COLLECTOR OF THE COUNTY OF PLUMAS, STATE OF CALIFORNIA, DO HEREBY CERTIFY THAT THERE ARE NO TAX LIENS AGAINST THE LOTS AS SHOWN HEREON FOR UNPAID COUNTY, MUNICIPAL OR LOCAL TAXES OR SPECIAL ASSESSMENTS COLLECTED AS TAXES, EXCEPT TAXES OR ASSESSMENTS NOT YET PAYABLE. TAXES OR ASSESSMENTS WHICH ARE A LIEN BUT NOT YET PAYABLE ARE ESTIMATED TO BE IN THE AMOUNT OF \$104.00

DATED 4-7-89

Signature of Barbara J. Coates, BARBARA J. COATES PLUMAS COUNTY TAX COLLECTOR

COUNTY RECORDER'S CERTIFICATE

FILED THIS 14th DAY OF April 1989, AT 11:20 A.M. IN BOOK 6 OF MAPS AT PAGE 78-80 AT THE REQUEST OF THE COUNTY ENGINEER.

FEE: \$9.00

FILE NO. 2157

ILA DIGGS, COUNTY RECORDER by Signature of Jo Ann Van Peder, DEPUTY

TRUSTEE'S CERTIFICATE

CAL-SIERRA TITLE COMPANY A CALIFORNIA CORPORATION AS TRUSTEE UNDER THAT DEED OF TRUST DATED JUNE 1, 1978 AND RECORDED IN BOOK 289 OF PLUMAS COUNTY OFFICIAL RECORDS AT PAGES 462 THROUGH 489, DOES HEREBY CONSENT TO THE PREPARATION AND RECORDATION OF THIS MAP.

CAL-SIERRA TITLE COMPANY BY Signature of David O. Windle, DAVID O. WINDLE - PRES.

STATE OF CALIFORNIA) ss COUNTY OF PLUMAS )

ON 2-21, 1989, BEFORE ME, THE UNDERSIGNED, A NOTARY PUBLIC IN AND FOR SAID STATE, PERSONALLY APPEARED DAVID O. WINDLE, KNOWN TO ME TO BE THE PRESIDENT OF THE CORPORATION THAT EXECUTED THE WITHIN INSTRUMENT ON BEHALF OF THE CORPORATION THEREIN NAMED, AND ACKNOWLEDGED TO ME THAT SUCH CORPORATION EXECUTED THE WITHIN INSTRUMENT PURSUANT TO ITS BY-LAWS OR A RESOLUTION OF ITS BOARD OF DIRECTORS, WITNESS MY HAND AND OFFICIAL SEAL.

Signature of John Seibel, NOTARY PUBLIC

5-3-92 MY COMMISSION EXPIRES

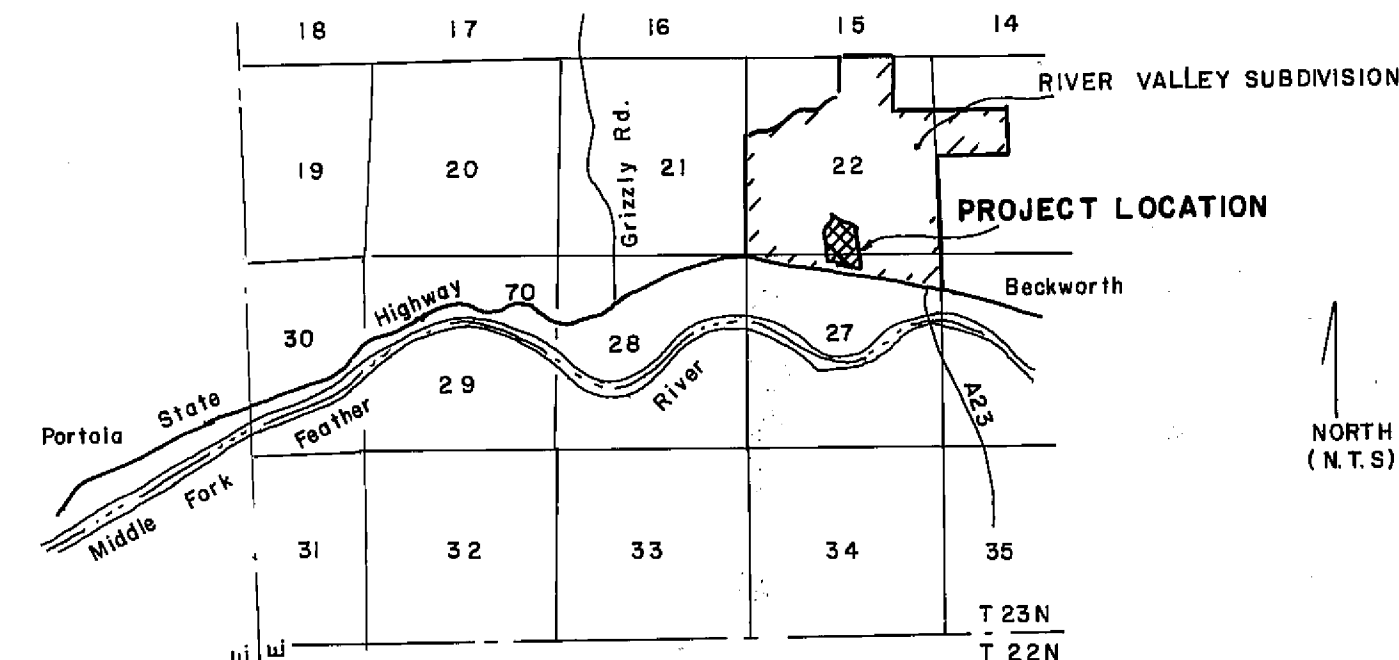
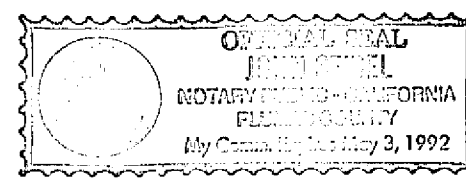

LOCATION MAP

Subdivision Summary

TOTAL AREA	20.75 ACRES
ROADS	1.76 ACRES
NET AREA	18.99 ACRES

RIVER VALLEY SUBDIVISION

UNIT #3

A Resubdivision of Lots 4 & 5 River Valley Subdivision - (5 M 32)

Portions of Sections 22 & 27

T. 23 N., R. 14 E., M.D.M.

PLUMAS COUNTY - CALIFORNIA

November 1988

HAMBY SURVEYING, INC. P.O. Box 1209 ph.(916) 832-5571 PORTOLA, CA. 96122