

OWNER'S STATEMENT

I, Ernest G. Leonhardt having record title interest in the hereon subdivided lands, do hereby consent to the preparation and recordation of this map. I hereby offer for dedication the public utility easements along the private road being "Danny Court" on this map.

Ernest G. Leonhardt

Ernest G. Leonhardt

NOTARY ACKNOWLEDGEMENT

STATE OF CALIFORNIA)
COUNTY OF PLUMAS)

On this 31 day of May, 1990, before me, the undersigned, a Notary Public in and for said state, personally appeared Ernest G. Leonhardt personally known to me, or proved to me on the basis of satisfactory evidence, to be the person whose name is subscribed to the within instrument, and acknowledged to me that they executed it.

Witness my hand and official seal

John Seibel
Signature

COUNTY SURVEYOR'S STATEMENT

I have examined this map and find it substantially the same as it appeared on the tentative map and any approved alterations thereof. All provisions of the Subdivision Map Act and any local ordinances applicable at the time of approval of the tentative map have been complied with; and I am satisfied that the map is technically correct.

Dated 8/10/90

Lawrence J. Brock

Lawrence J. Brock RCE 13528
Plumas County Surveyor

COUNTY TAX COLLECTOR'S CERTIFICATE

I, Barbara J. Coates, Tax Collector of the County of Plumas, State of California, do hereby certify that there are no tax liens against the Parcels, as shown hereon, for unpaid state, county, municipal, or local taxes or special assessments collected as taxes, except taxes or assessments not yet payable. Taxes or assessments which are a lien but not yet payable, are estimated to be in the amount of \$ 472.00.

Dated 8-10-90

Barbara J. Coates by: Ginny Schoeder
Barbara J. Coates
Plumas County Tax Collector

SURVEYOR'S STATEMENT

This map and the survey performed therefore in May 1990 were made by me or under my direction. The survey is true and complete as shown. All of the monuments shown hereon are of the character and occupy the positions indicated and are sufficient to enable the survey to be retraced.

Dated 5-31-90

Clifford R. Brown
Clifford R. Brown RCE 22836

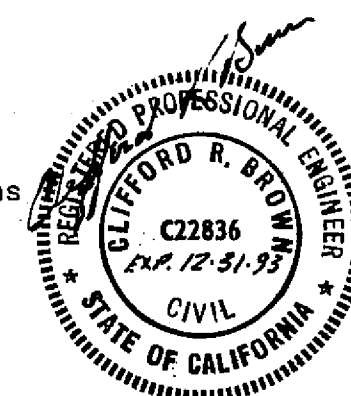

COUNTY RECORDER'S CERTIFICATE

Filed this 10th day of August, 1990, at 10:35 A.m. in Book 6 of Maps, at page 128, at the request of the County Engineer.

Fee \$9.00

File No. 5461

Judith Wells
County Recorder

by *Jo Ann Van Gilder*
Deputy

COUNTY CLERK'S CERTIFICATE

I, Judith Wells, Clerk of the County of Plumas, State of California, and Ex-Officio Clerk of the Board of Supervisors of said county, hereby certify that the herein embodied map was approved by the said Board of Supervisors convened in a regular meeting upon the 10th day of July, 1990, and the offer of dedication for public utility easements as shown on the map were accepted for the uses noted.

Dated 8-10-90

Judith Wells
Judith Wells
County Clerk

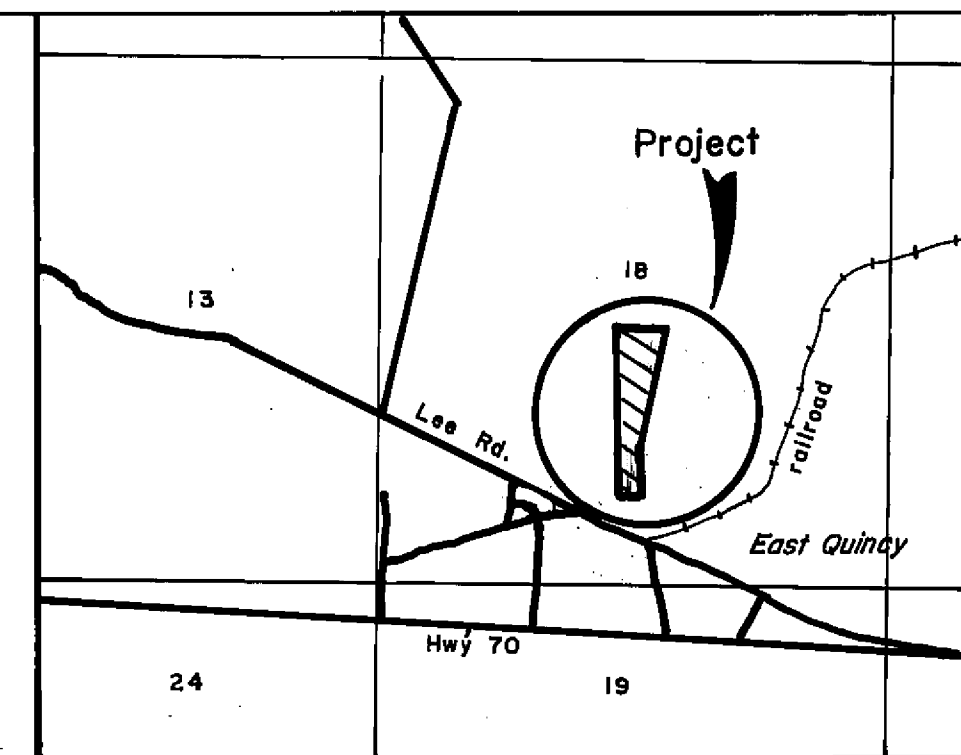

Location Map
T24N, R10E, Section 18, MDBM

"PLUMAS INDUSTRIAL PARK"

A Subdivision of 6 lots within a portion of Section 18 of T24N, R10E, MDBM East Quincy, Plumas County, CA.

Owner: Ernest G. Leonhardt
P.O. Box 96
Quincy, CA 95971 283-2336

Engineer: Cliff Brown Engineering & Survey
2335 Pondersa
Quincy, CA 95971 283-3959

May 1990

Sheet 1 of 3