

**OWNER'S STATEMENT**

MOHAWK VALLEY RANCH, INC. DBA WHITEHAWK RANCH, HAVING RECORD TITLE INTEREST IN THE HEREON SUBDIVIDED LANDS DOES HEREBY CONSENT TO THE PREPARATION AND RECORDATION OF THIS MAP, AND DOES HEREBY DEDICATE, FOR THE HEREINAFTER DESCRIBED PURPOSES, THE FOLLOWING EASEMENTS, ALL IN ACCORDANCE WITH THE IMPROVEMENT PLANS APPROVED BY THE PLUMAS COUNTY ENGINEER.

1. INGRESS, EGRESS, SUPPORT AND UTILITIES. DEER CREEK CROSSING, AS SHOWN ON THE MAP, FOR PUBLIC UTILITY PURPOSES, AND FOR INGRESS, EGRESS, SUPPORT AND USE BY ALL PUBLIC UTILITIES, LAW ENFORCEMENT, FIRE PROTECTION, WELFARE AND OTHER RELATED PUBLIC OR COUNTY AGENCIES, THEIR VEHICLES AND PERSONNEL, FOR THE SOLE PURPOSE OF PERFORMING OFFICIAL BUSINESS.
2. UTILITIES. EASEMENTS FOR INSTALLATION, MAINTENANCE AND REPAIR OF ALL UTILITIES CONSTRUCTED OVER, ON, ACROSS AND UNDER LOT 'A' AND LOT 'B', AS SHOWN ON THE MAP, WITH THE RIGHT TO TRIM AND REMOVE, AS OFTEN AS NECESSARY, TREES, LIMBS AND BRUSH FOR THE SOLE PURPOSE OF INSTALLING, MAINTAINING, AND/OR REPAIRING SAID UTILITIES.

LOT 'A' AND LOT 'B', AS SHOWN ON THE MAP, WILL BE GRANTED TO THE COMMON USE AND ENJOYMENT OF THE OWNERS OF WHITEHAWK RANCH PHASE IV FOR THE PROTECTION OF LIGHT, SPACE, NATURAL ENVIRONMENT AND HABITAT, AND FOR RECREATION USES TO THE EXTENT SUCH USES ARE CONSISTENT WITH THE ABOVE-DESCRIBED EASEMENTS. SAID LOT 'A' AND LOT 'B' WILL BE MAINTAINED BY THE WHITEHAWK RANCH TOWNHOME OWNERS' ASSOCIATION.

DEER CREEK CROSSING, AS SHOWN ON THE MAP, WILL BE GRANTED TO THE WHITEHAWK RANCH HOMEOWNERS' ASSOCIATION AS A PRIVATE ACCESS AREA FOR THE COMMON USE OF THE OWNERS OF LOTS 15 THROUGH 23 OF WHITEHAWK RANCH PHASE IV UNIT 2 AND OWNERS OF LOTS IN ANY OTHER PHASE OF WHITEHAWK RANCH. SAID PRIVATE ACCESS AREA WILL BE MAINTAINED BY THE WHITEHAWK RANCH HOMEOWNERS' ASSOCIATION.

MOHAWK VALLEY RANCH, INC. DBA WHITEHAWK RANCH

BY: Hugh A. White TITLE: C.E.O.  
HUGH A. WHITE

STATE OF CALIFORNIA  
COUNTY OF PLUMAS

ON June 6, 1994, BEFORE ME Linda Carr, PERSONALLY APPEARED HUGH A. WHITE PERSONALLY KNOWN TO ME (OR PROVED TO ME ON THE BASIS OF SATISFACTORY EVIDENCE) TO BE THE PERSON WHOSE NAME IS SUBSCRIBED TO THE WITHIN INSTRUMENT AND ACKNOWLEDGED TO ME THAT HE EXECUTED THE SAME IN HIS AUTHORIZED CAPACITY, AND THAT BY HIS SIGNATURE ON THE INSTRUMENT THE PERSON, OR THE ENTITY UPON BEHALF OF WHICH THE PERSON ACTED, EXECUTED THE INSTRUMENT.

WITNESS MY HAND AND OFFICIAL SEAL.

Linda Carr

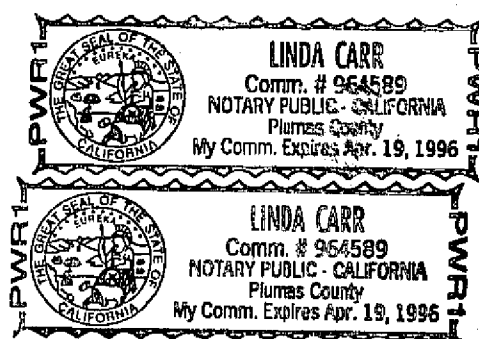

**COUNTY TAX COLLECTOR'S CERTIFICATE**

I, BARBARA J. COATES, TAX COLLECTOR OF THE COUNTY OF PLUMAS, STATE OF CALIFORNIA, DO HEREBY CERTIFY THAT THERE ARE NO TAX LIENS AGAINST THE LOTS, AS SHOWN HEREON, FOR UNPAID STATE, COUNTY, MUNICIPAL, OR LOCAL TAXES OR SPECIAL ASSESSMENTS COLLECTED AS TAXES, EXCEPT TAXES OR ASSESSMENTS NOT YET PAYABLE. TAXES OR ASSESSMENTS WHICH ARE A LIEN BUT NOT YET PAYABLE ARE ESTIMATED TO BE IN THE AMOUNT OF \$ 16,500.00.

DATED: 6-13-94  
Barbara J. Coates  
BARBARA J. COATES  
PLUMAS COUNTY TAX COLLECTOR

**ENGINEER'S STATEMENT**

THIS MAP AND THE SURVEY PERFORMED THEREFORE IN JANUARY 1994, WERE MADE BY ME OR UNDER MY DIRECTION. THE SURVEY IS TRUE AND COMPLETE AS SHOWN. ALL OF THE MONUMENTS SHOWN HEREON ARE OF THE CHARACTER AND OCCUPY THE POSITIONS INDICATED, OR THEY WILL BE SET IN SUCH POSITIONS ON OR BEFORE ONE YEAR AFTER THE RECORDATION OF THIS MAP BY THE PLUMAS COUNTY RECORDER, THE MONUMENTS ARE, OR WILL BE, SUFFICIENT TO ENABLE THE SURVEY TO BE RETRACED.

DATED: 6/3/94

Larry A. Fites  
LARRY A. FITES  
R.C.E. 13225  
LICENSE EXP. DATE: 3/31/97

**COUNTY SURVEYOR'S STATEMENT**

I HAVE EXAMINED THIS MAP AND FIND IT IS SUBSTANTIALLY THE SAME AS IT APPEARED ON THE TENTATIVE MAP AND ANY APPROVED ALTERATIONS THEREOF. ALL PROVISIONS OF THE SUBDIVISION MAP ACT AND ANY LOCAL ORDINANCES APPLICABLE AT THE TIME OF APPROVAL OF THE TENTATIVE MAP HAVE BEEN COMPLIED WITH AND I AM SATISFIED THAT THE MAP IS TECHNICALLY CORRECT.

DATED: 6-14-94

R. Tom Hunter  
R. TOM HUNTER, R.C.E. 30515  
PLUMAS COUNTY SURVEYOR  
LICENSE EXP. DATE: 3/31/96

**COUNTY CLERK'S CERTIFICATE**

I, JUDITH WELLS, CLERK OF THE COUNTY OF PLUMAS, STATE OF CALIFORNIA AND EX-OFFICIO CLERK OF THE BOARD OF SUPERVISORS OF SAID COUNTY, HEREBY CERTIFY THAT THE HEREIN EMBODIED MAP WAS APPROVED BY SAID BOARD OF SUPERVISORS CONVENED IN A REGULAR MEETING UPON THE 4th DAY OF June, 1994. THE OFFERS OF DEDICATION OF THE PUBLIC UTILITY EASEMENTS (P.U.E.) AND DEER CREEK CROSSING, AS SHOWN ON THE MAP, WERE ACCEPTED FOR THE USES NOTED.

DATED: June 16, 1994

Jeanne K. Beebe  
JUDITH WELLS  
COUNTY CLERK

**COUNTY RECORDER'S STATEMENT**

FILED THIS 16th DAY OF June, 1994, AT 11:07AM. IN BOOK 7 OF MAPS, AT PAGE 6110, AT THE REQUEST OF THE COUNTY SURVEYOR.

FEE: \$ 10.00

FILE NO. 4618

JUDITH WELLS  
COUNTY RECORDER  
BY: Eric A. Deary  
DEPUTY

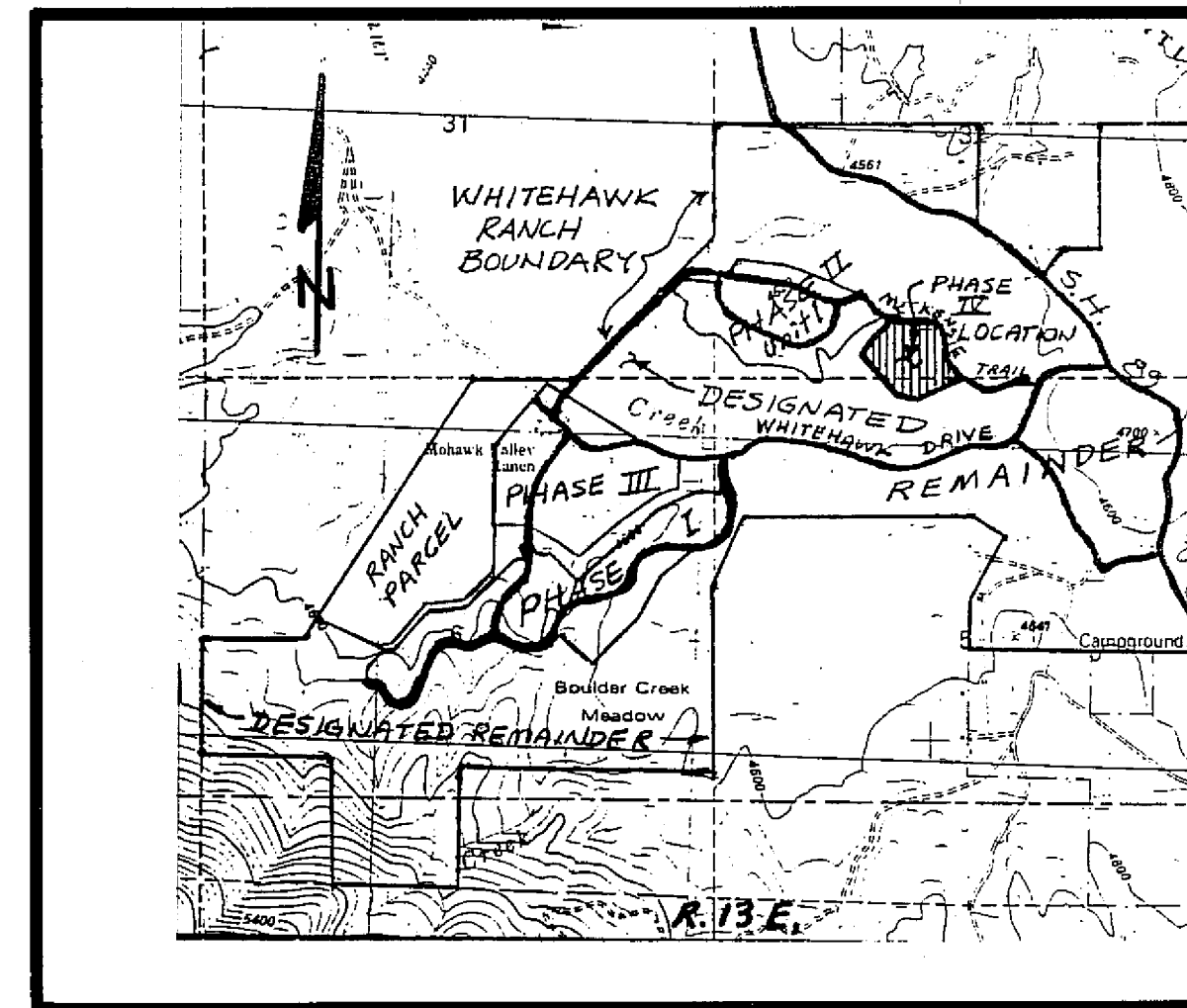

LOCATION MAP  
SCALE: 1" = 2000'

**AREA TABULATION**

LOTS 15 THROUGH 26	1.20 AC.
LOT A	0.59 AC.
LOT B	1.13 AC.
ACCESS AREA	0.22 AC.
TOTAL	3.14 AC.

**WHITEHAWK RANCH  
PHASE IV**

UNIT NO. 2

A PLANNED DEVELOPMENT

FOR

MOHAWK VALLEY RANCH, INC.  
dba WHITEHAWK RANCH

WITHIN SECTION 5, T. 21 N., R. 13 E.  
AND SECTION 32, T. 22 N., R. 13 E., MDM  
PLUMAS COUNTY, CALIFORNIA

PREPARED BY:

LARRY FITES ENGINEERING

P.O. BOX 20308  
GRAEAGLE, CALIFORNIA 96103  
R.C.E. 13225

APRIL 1994

SHEET 1 OF 2

7 M 109

certificate of correction  
OK OK 672 pg 123  
1/17/96 Doc# 339

Recorded Certificate of Correction of Book 534 pg 13 Doc# 8413 on 10/29/1990  
OK OK 674 on 1/31/96 Doc# 674