

**OWNER'S STATEMENT**

WE, ROGER W. CLARK AND BONNIE M. CLARK, TRUSTEES OF THE CLARK FAMILY LIVING TRUST DATED SEPTEMBER 8, 1989, HAVING RECORD TITLE INTEREST IN THE HEREON SUBDIVIDED LANDS DO HEREBY CONSENT TO THE PREPARATION AND RECORDATION OF THIS MAP.

DATED: Sept 7, 1993

Roger W. Clark  
ROGER W. CLARK, TRUSTEE  
Bonnie M. Clark  
BONNIE M. CLARK, TRUSTEE

**NOTARY**

STATE OF CALIFORNIA  
COUNTY OF PLUMAS

ON Sept 7 1993, BEFORE ME, THE UNDERSIGNED, PERSONALLY APPEARED ROGER W. CLARK AND BONNIE M. CLARK, PERSONALLY KNOWN TO ME (OR PROVED TO ME ON THE BASIS OF SATISFACTORY EVIDENCE) TO BE THE PERSONS WHOSE NAMES ARE SUBSCRIBED TO THE WITHIN INSTRUMENT AND ACKNOWLEDGED TO ME THAT THEY EXECUTED THE SAME IN THEIR AUTHORIZED CAPACITIES, AND THAT BY THEIR SIGNATURES ON THE INSTRUMENT THE PERSONS, OR THE ENTITY UPON BEHALF OF WHICH THE PERSONS ACTED, EXECUTED THE INSTRUMENT.

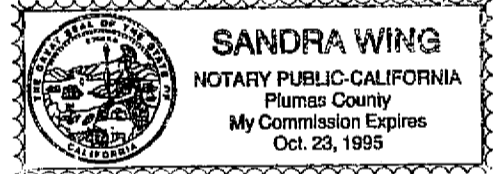

Sandra Wing  
NOTARY PUBLIC

**COUNTY CLERK'S CERIFICATE**

I, JUDITH WELLS, CLERK OF THE COUNTY OF PLUMAS, STATE OF CALIFORNIA AND EX-OFFICIO CLERK OF THE BOARD OF SUPERVISORS OF SAID COUNTY HEREBY CERTIFY THAT THE HEREIN EMBODIED MAP WAS APPROVED BY SAID BOARD OF SUPERVISORS CONVENED IN A REGULAR MEETING UPON THE 21<sup>st</sup> DAY OF June, 1994.

DATED: 6-21-94

Nancy DeLano, Deputy  
JUDITH WELLS  
COUNTY CLERK

**COUNTY RECORDERS CERTIFICATE**

FILED THIS 22<sup>nd</sup> DAY OF JUNE, 1994, AT 2:40 PM IN BOOK 7 OF MAPS AT PAGE 113, AT THE REQUEST OF THE COUNTY SURVEYOR.

FEE: \$12.00

JUDITH WELLS, COUNTY RECORDER  
BY Sue A. Gray  
DEPUTY

FILE NO. 4796

**COUNTY SURVEYOR'S STATEMENT**

I HAVE EXAMINED THIS MAP AND FIND IT IS SUBSTANTIALLY THE SAME AS IT APPEARED ON THE TENTATIVE MAP AND ANY APPROVED ALTERATIONS THEREOF. ALL PROVISIONS OF THE SUBDIVISION MAP ACT AND ANY LOCAL ORDINANCES APPLICABLE AT THE TIME OF APPROVAL OF THE TENTATIVE MAP HAVE BEEN COMPLIED WITH AND I AM SATISFIED THAT THE MAP IS TECHNICALLY CORRECT.

DATED: June 14, 1994

R. Tom Hunter  
R. TOM HUNTER, R.C.E. 30515  
PLUMAS COUNTY SURVEYOR  
LICENSE EXPIRATION DATE 3-31-96

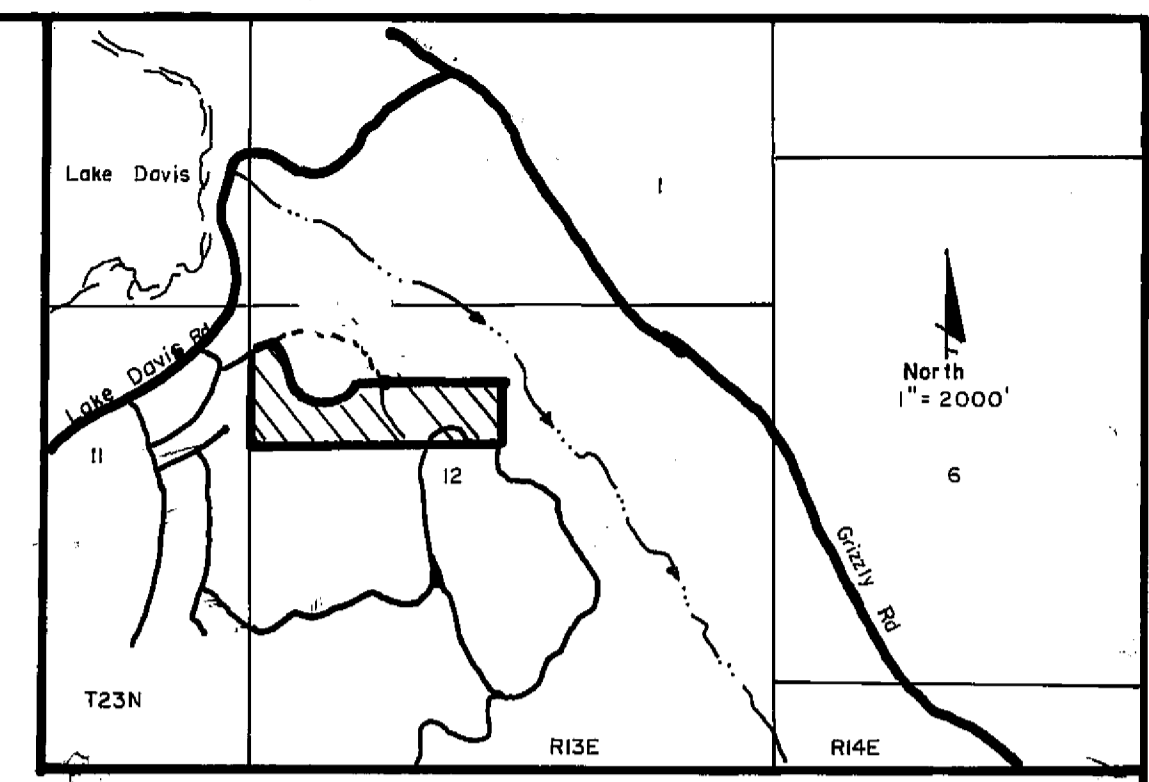

LOCATION MAP  
T23N R13E

**ENGINEER'S STATEMENT**

THIS MAP AND SURVEY PERFORMED THEREFORE IN JULY 1993, WERE MADE BY ME OR UNDER MY DIRECTION. THE SURVEY IS TRUE AND COMPLETE AS SHOWN. ALL OF THE MONUMENTS SHOWN HEREON ARE OF THE CHARACTER AND OCCUPY THE POSITIONS INDICATED, AND ARE SUFFICIENT TO ENABLE THE SURVEY TO BE RETRACED.

10-8-93  
Dated

Clifford R. Brown  
CLIFFORD R. BROWN R.C.E. 22836



**COUNTY TAX COLLECTOR'S CERTIFICATE**

I, BARBARA J. COATES, TAX COLLECTOR OF THE COUNTY OF PLUMAS, STATE OF CALIFORNIA, DO HEREBY CERTIFY THAT THERE ARE NO TAX LIENS AGAINST THE LOTS AS SHOWN HEREON FOR UNPAID STATE, COUNTY, MUNICIPAL, OR LOCAL TAXES OR SPECIAL ASSESSMENTS COLLECTED AS TAXES, EXCEPT TAXES OR ASSESSMENTS, NOT YET PAYABLE. TAXES OR ASSESSMENTS, WHICH ARE A LIEN BUT NOT YET PAYABLE, ARE ESTIMATED TO BE IN THE AMOUNT OF 1583.00.

Dated: 6-20-94

Barbara J. Coates  
By: Sunny Dunbar, asst.  
BARBARA J. COATES  
PLUMAS COUNTY TAX COLLECTOR

**Planned Development Statement**

THE PROPERTY SHOWN HEREON IS SUBJECT TO A PLANNED DEVELOPMENT PERMIT WHICH IS RECORDED IN BOOK 632 OF OFFICIAL RECORDS AT PAGE 504. FUTURE DEVELOPMENT OF THIS PROPERTY WILL BE SUBJECT TO THE CONDITIONS OF SAID PERMIT.

**Private Road Statement**

ROADS SHOWN HEREON, "BUSHWACKER ROAD AND BUCKBRUSH DRIVE" ARE PRIVATE EASEMENTS NOT SUBJECT TO IMPROVEMENT OR MAINTENANCE BY PLUMAS COUNTY. SUCH EASEMENTS WILL NOT BECOME EFFECTIVE UNLESS AND UNTIL RESERVATIONS AND GRANTS ARE INCLUDED IN THE RESPECTIVE DEEDS.

**Road Maintenance Statement**

THE PROPERTY SHOWN HEREON IS SUBJECT TO A ROAD MAINTENANCE AGREEMENT WHICH IS RECORDED IN BOOK 632 OF OFFICIAL RECORDS AT PAGE 506.

**WHITETHORN HEIGHTS UNIT 4**

A Planned Development & Subdivision of a portion of Sec. 12 T23N, R13E, MDM Plumas County, California

Developer: ROGER W. CLARK and BONNIE M. CLARK, TRUSTEES OF THE CLARK FAMILY LIVING TRUST DATED SEPTEMBER 8, 1989.

Engineer: CLIFF BROWN Engineering & Survey  
2335 Ponderosa St.  
Quincy, Ca. 95971