

OWNER'S STATEMENT

We, the undersigned, having record title interest in the hereon subdivided lands do hereby consent to the preparation and recordation of this map. We do hereby offer for dedication Sierra Way as a 50 foot wide public road and utility easement, Easement A, B & J shown hereon are dedicated as drainage easements. Easement "K" is dedicated as a 10 foot wide public utility easement.

FLYING "L" RANCH, A CALIFORNIA LIMITED PARTNERSHIP

BY: *Kenneth N. Barnard*
Kenneth N. Barnard

COUNTY SURVEYOR'S STATEMENT

I have examined this map and find it is substantially the same as it appeared on the tentative map and any approved alterations thereof. All provisions of the Subdivision Map Act and any local ordinances applicable at the time of approval of the tentative map have been complied with and I am satisfied that the map is technically correct.

Dated: Jan 20, 1995

R. Tom Hunter
R. Tom Hunter, R.C.E. 30515
Plumas County Surveyor
License Expiration Date 3/31/96

COUNTY RECORDER'S CERTIFICATE

Filed this 10TH day of FEBRUARY, 1995, at 3:00 PM in Book 7 of Record Maps, at Page 131-134, at the request of the County Surveyor.

Judith Wells
County Recorder

By: *Jo Ann Van Belder*
Deputy

Fee: 14.00

File No. 867

TRUSTEE'S CERTIFICATE

CAL-SIERRA TITLE COMPANY A CORPORATION AS TRUSTEE UNDER A DEED OF TRUST DATED JULY 2, 1990 AND RECORDED IN BOOK 525 OF OFFICIAL RECORDS AT PAGE 375, DOES HEREBY CONSENT TO THE PREPARATION AND RECORDING OF THIS MAP AND CONSENT TO THE DEDICATION OF SIERRA WAY AS A 50 FOOT WIDE PUBLIC ROAD AND UTILITY EASEMENT, EASEMENTS A, B, & J AS DRAINAGE EASEMENTS, EASEMENT K AS A 10 FOOT WIDE PUBLIC UTILITY EASEMENT.

DATED: JANUARY 19, 1995

David Windee
DAVID WINDEE, PRESIDENT

NOTARY

STATE OF CALIFORNIA
COUNTY OF PLUMAS

ON January 19, 1995 BEFORE ME, *Alicia Dalton* PERSONALLY APPEARED DAVID WINDEE, PERSONALLY KNOWN TO ME OR PROVED TO ME ON THE BASIS OF SATISFACTORY EVIDENCE TO BE THE PERSON WHOSE NAME IS SUBSCRIBED TO THE WITHIN INSTRUMENT AND ACKNOWLEDGED TO ME THAT HE EXECUTED THE SAME IN HIS AUTHORIZED CAPACITY, AND THAT BY HIS SIGNATURE ON THE INSTRUMENT THE PERSONS, OR ENTITY UPON BEHALF OF WHICH THE PERSONS ACTED, EXECUTED THE INSTRUMENT.

WITNESS MY HAND AND OFFICIAL SEAL.

Alicia Dalton
SIGNATURE OF NOTARY
MY COMMISSION EXPIRES 11-1-96 *Alicia Dalton*
County of Plumas

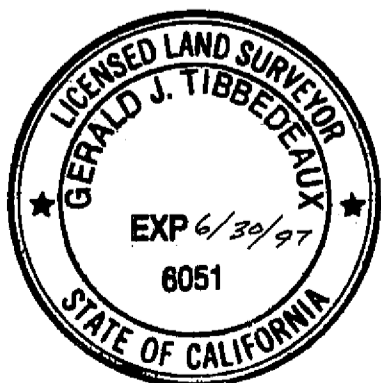

NOTARY

STATE OF CALIFORNIA

COUNTY OF PLUMAS

ON January 18, 1995 BEFORE ME, *Alicia Dalton* PERSONALLY APPEARED KENNETH N. BARNARD, PERSONALLY KNOWN TO ME OR PROVED TO ME ON THE BASIS OF SATISFACTORY EVIDENCE TO BE THE PERSON WHOSE NAME IS SUBSCRIBED TO THE WITHIN INSTRUMENT AND ACKNOWLEDGED TO ME THAT HE EXECUTED THE SAME IN HIS AUTHORIZED CAPACITY, AND THAT BY HIS SIGNATURE ON THE INSTRUMENT THE PERSONS, OR THE ENTITY UPON BEHALF OF WHICH THE PERSONS ACTED, EXECUTED THE INSTRUMENT.

WITNESS MY HAND AND OFFICIAL SEAL.

Alicia Dalton
SIGNATURE OF NOTARY
MY COMMISSION EXPIRES 11-1-96 *Alicia Dalton*
County of Plumas

COUNTY CLERK'S CERTIFICATE

I, Judith Wells, Clerk of the County of Plumas, State of California and Ex-Officio Clerk of the Board of Supervisors of said county, hereby certify that the herein embodied map was approved by said board of supervisors convened in a regular meeting upon the 7TH day of February, 1995. The offer of dedication of Sierra Way as shown as a public road and utility easement, Easements A, B, & J, as drainage easements and Easement "K" as a 10 foot wide Public Utility Easement, as shown on the map were accepted for the uses noted.

Dated 2-8-95

By: *Judith Wells*
Judith Wells
County Clerk

SURVEYOR'S STATEMENT

This map and the survey performed therefore in July, 1994, were made by me or under my direction. The survey is true and complete as shown. All of the monuments shown hereon are of the character and occupy the positions indicated and are sufficient to enable the survey to be retraced.

Dated: Jan 20, 1995

Gerald Joseph Tibbedeaux
Gerald Joseph Tibbedeaux P.L.S. 6051
License Exp. 06/30/97

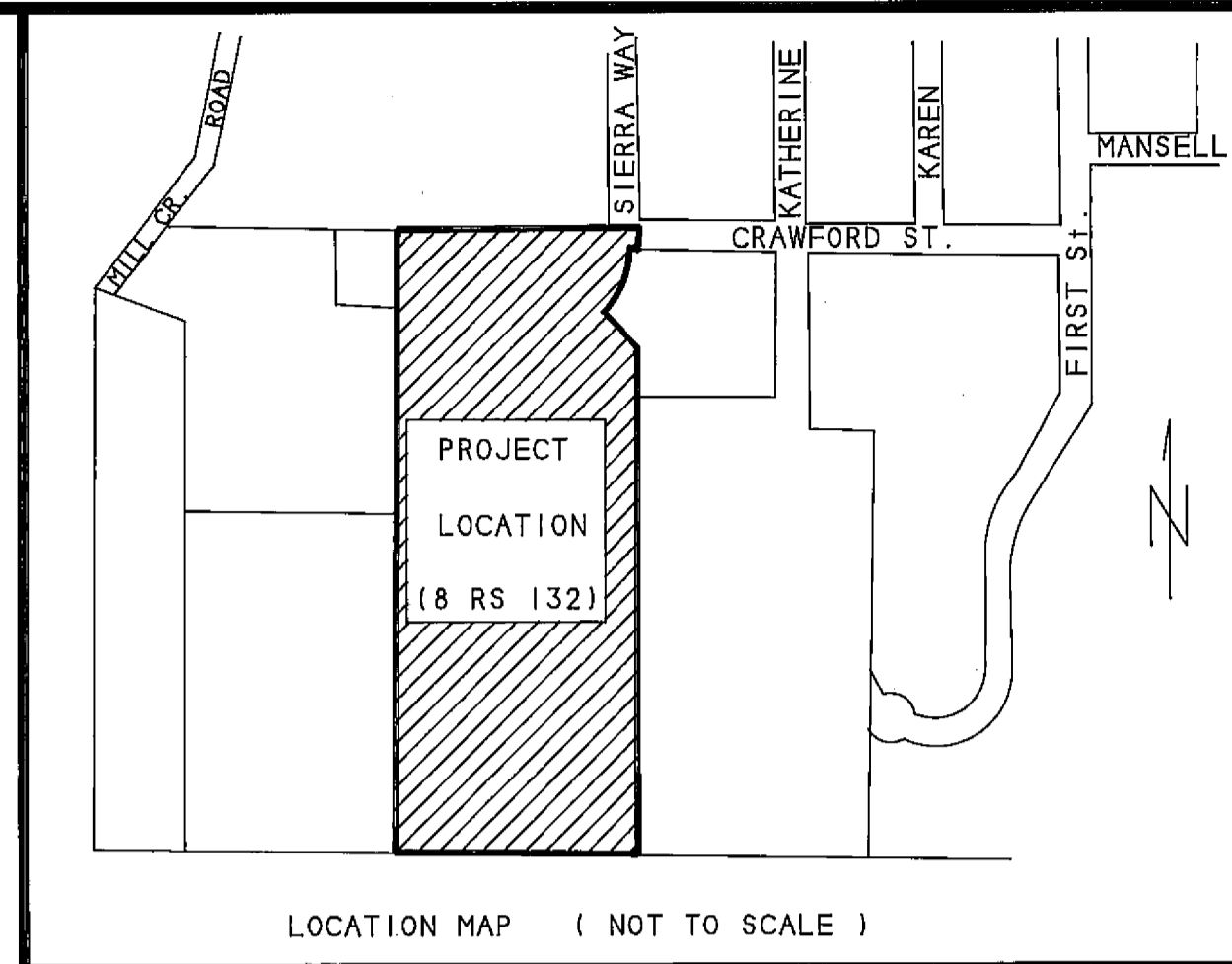

COUNTY TAX COLLECTOR'S CERTIFICATE

I, Barbara J. Coates, Tax Collector of the County of Plumas, State of California, do hereby certify that there are no tax liens against the Lots, as shown hereon, for unpaid state, county, municipal, or local taxes or special assessments collected as taxes, except taxes or assessments not yet payable. Taxes or assessments which are a lien but not yet payable, are estimated to be in the amount of \$ NONE.

Dated: 1-19-95

Barbara J. Coates
By: *Barbara J. Coates*
Barbara J. Coates
Plumas County Tax Collector

AREA IN LOTS = 13.95 ACRES
AREA IN ROADS = 0.97 ACRES
TOTAL AREA = 14.92 ACRES

SOUTHERN OAKS

A PLANNED DEVELOPMENT OF 15 LOTS WITHIN THE NE 1/4 OF THE SE 1/4 OF SEC. 19, T. 24 N., R. 10 E., M. D. M PLUMAS COUNTY CALI FORNI A FOR FLYING L RANCH PROPERTIES

Tibbedeaux Surveying
P. O. Box 1960
565 Ridge Street
Portola CA 96122
(916) 832-5772

CERT. CORR. RECORDED 10-6-98 INSTRUMENT# B003 BE 754 PG 674

7 M 131 *Out of Correction recorded*
Book 672 OR Page 10
Dec 29, 1995