

**NOTES**

1. LEACH EXCLUSION AREAS INCLUDE 50' FROM SEASONAL WATERCOURSES, AREAS OF HIGH GROUNDWATER, AND SLOPES OVER 30%, AND ALL EASEMENTS EXCEPT AS APPROVED BY THE COUNTY SANITARIAN, AND 100' FROM WELLS, AND 50' FROM PROPERTY LINES.

2. THE ADDITIONAL INFORMATION SHOWN HEREON IS FOR INFORMATIONAL PURPOSES, DESCRIBING CONDITIONS AS OF THE DATE OF FILING, AND IS NOT INTENDED TO AFFECT RECORD TITLE INTEREST.

3. THE ADDITIONAL INFORMATION SHOWN HEREON IS DERIVED FROM PUBLIC RECORDS OR REPORTS, AND DOES NOT IMPLY THE CORRECTNESS OR SUFFICIENCY OF THOSE RECORDS OR REPORTS BY THE PREPARER.

**CONDITIONS OF APPROVAL INCLUDE THE FOLLOWING ITEMS**

1. ROAD CONSTRUCTION AND CLEARING SHALL BE DONE ONLY BETWEEN MAY 15 AND NOVEMBER 1.

2. "UNDER 1275.00 et seq. OF THE SRA FIRE SAFE REGULATIONS AND THE PROVISIONS OF ARTICLE 10 OF CHAPTER 4 OF TITLE 9, COMMENCING WITH SECTION 9-4.1001, OF THE PLUMAS COUNTY CODE, EMERGENCY WATER FOR FIRE PROTECTION WILL BE REQUIRED BEFORE FINAL INSPECTIONS FOR BUILDING CONSTRUCTION".

NORTH  
1"=100'

"KITTY KAT TRAIL"

HWY 70

"KITTEEN CIRCLE"

**LEGEND**

SHADED AREAS INDICATE APPROXIMATE LEACH EXCLUSION AREAS.

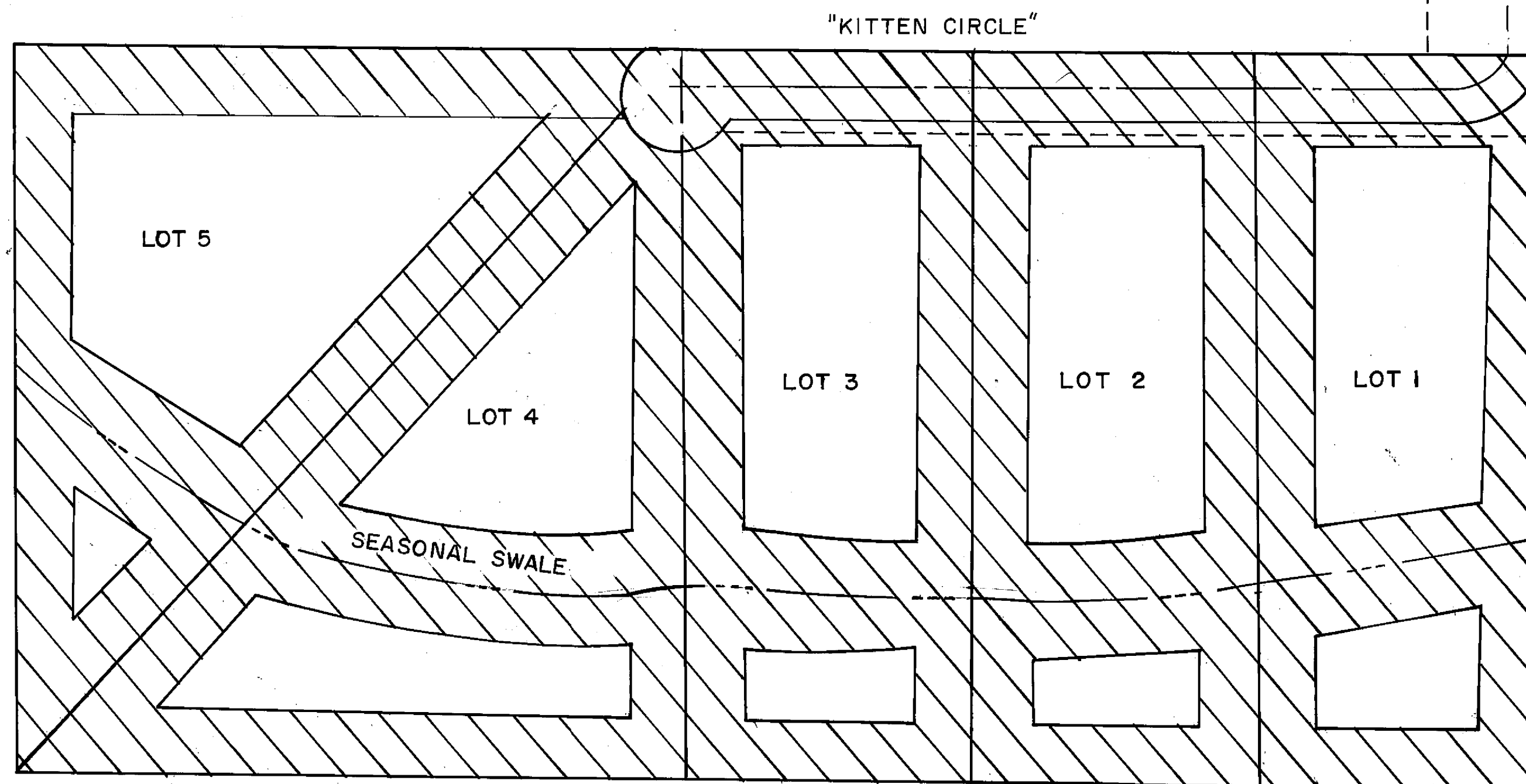

**SUPPLEMENTAL INFORMATION SHEET  
KITTY KAT ESTATES UNIT 2**

A SUBDIVISION OF FIVE LOTS WITHIN THE SOUTH HALF OF SECTION 8, T22N, R13E, MDM, PLUMAS COUNTY, CA.

OWNER: GIANT QUICKSILVER CORPORATION  
573 RIVIERA CIRCLE  
LARKSPUR, CA 94939

ENGINEER: CLIFF BROWN ENGINEERING & SURVEY  
2335 PONDEROSA  
QUINCY, CA 95971 (916)283-3959