

**OWNER'S STATEMENT**

WHITEHAWK DEVELOPMENT GROUP, LLC., HAVING RECORD TITLE INTEREST IN THE HEREON SUBDIVIDED LANDS DOES HEREBY CONSENT TO THE PREPARATION AND RECORDATION OF THIS MAP, AND DOES HEREBY DEDICATE FOX TAIL LANE, AS SHOWN ON THE MAP, FOR PUBLIC UTILITY PURPOSES, AND FOR INGRESS, EGRESS, SUPPORT AND USE BY ALL PUBLIC UTILITIES, LAW ENFORCEMENT, FIRE PROTECTION, WELFARE AND OTHER RELATED PUBLIC OR COUNTY AGENCIES, THEIR VEHICLES AND PERSONNEL, FOR THE SOLE PURPOSE OF PERFORMING OFFICIAL BUSINESS.

THE DRAINAGE EASEMENTS, AS SHOWN ON THE MAP, ARE RESERVED FOR MAINTENANCE OF WATERCOURSES, INCLUDING NECESSARY ACCESS THERETO, AND ARE BEING GRANTED TO THE WHITEHAWK RANCH HOMEOWNERS' ASSOCIATION CONCURRENTLY WITH THE FILING OF THIS MAP. THIS GRANT OF EASEMENT IS RECORDED IN VOLUME 716 OF OFFICIAL RECORDS AT PAGE 526, PLUMAS COUNTY RECORDS.

THE SEWER AND WATER EASEMENTS, AS SHOWN ON THE MAP, ARE RESERVED FOR CONSTRUCTION, MAINTENANCE AND REPAIR OF SEWER AND WATER MAINS, AND APPURTENANCES, AND ARE BEING GRANTED TO THE WHITEHAWK RANCH MUTUAL WATER COMPANY CONCURRENTLY WITH THE FILING OF THIS MAP. THIS GRANT OF EASEMENT IS RECORDED IN VOLUME 716 OF OFFICIAL RECORDS AT PAGE 525, PLUMAS COUNTY RECORDS.

FOX TAIL LANE, AS SHOWN ON THE MAP, WILL BE GRANTED TO THE WHITEHAWK RANCH HOMEOWNERS' ASSOCIATION FOR THE COMMON USE OF THE OWNERS OF LOTS 1 THROUGH 21 OF WHITEHAWK RANCH PHASE VII AND OWNERS OF LOTS IN ANY OTHER PHASE OF WHITEHAWK RANCH. FOX TAIL LANE WILL BE MAINTAINED BY THE WHITEHAWK RANCH HOMEOWNERS' ASSOCIATION AS A PRIVATE ROAD.

WHITEHAWK DEVELOPMENT GROUP, LLC

BY: Marcia L. White TITLE: MANAGER  
MARCIA L. WHITE

STATE OF CALIFORNIA  
COUNTY OF PLUMAS

ON August 27, 1997, BEFORE ME Linda Carr PERSONALLY APPEARED MARCIA L. WHITE PERSONALLY KNOWN TO ME (OR PROVED TO ME ON THE BASIS OF SATISFACTORY EVIDENCE) TO BE THE PERSON WHOSE NAME IS SUBSCRIBED TO THE WITHIN INSTRUMENT AND ACKNOWLEDGED TO ME THAT SHE EXECUTED THE SAME IN HER AUTHORIZED CAPACITY, AND THAT BY HER SIGNATURE ON THE INSTRUMENT THE PERSON, OR THE ENTITY UPON BEHALF OF WHICH THE PERSON ACTED, EXECUTED THE INSTRUMENT.

WITNESS MY HAND AND OFFICIAL SEAL.

Linda Carr

Linda Carr  
Plumas County  
Comm # 1099141  
Exp. 5-30-2000

**COUNTY TAX COLLECTOR'S CERTIFICATE**

I, BARBARA J. COATES, TAX COLLECTOR OF THE COUNTY OF PLUMAS, STATE OF CALIFORNIA, DO HEREBY CERTIFY THAT THERE ARE NO TAX LIENS AGAINST THE LOTS, AS SHOWN HEREON, FOR UNPAID STATE, COUNTY, MUNICIPAL, OR LOCAL TAXES OR SPECIAL ASSESSMENTS COLLECTED AS TAXES, EXCEPT TAXES OR ASSESSMENTS NOT YET PAYABLE. TAXES OR ASSESSMENTS WHICH ARE A LIEN BUT NOT YET PAYABLE, ARE ESTIMATED TO BE IN THE AMOUNT OF \$ 25,604.00

DATED: 8-29-97

Barbara J. Coates  
By: Denny Dunbar, asst  
BARBARA J. COATES  
PLUMAS COUNTY TAX COLLECTOR

**TRUSTEE'S CERTIFICATE**

FIDELITY NATIONAL TITLE INSURANCE COMPANY, A CALIFORNIA CORPORATION AS TRUSTEE UNDER DEEDS OF TRUST DATED AUGUST 30, 1995 AND RECORDED IN BOOK 662 OF OFFICIAL RECORDS AT PAGES 817, AND IN BOOK 662 OF OFFICIAL RECORDS AT PAGE 826, DOES HEREBY CONSENT TO THE PREPARATION AND RECORDING OF THIS MAP.

DATED: 8-28-97 BY: Helen M. Strain  
HELEN M. STRAIN  
ASST. VICE-PRESIDENT

STATE OF CALIFORNIA  
COUNTY OF PLUMAS

ON 8-28, 1997, BEFORE ME Linda Carr PERSONALLY APPEARED HELEN M. STRAIN, PERSONALLY KNOWN TO ME (OR PROVED TO ME ON THE BASIS OF SATISFACTORY EVIDENCE) TO BE THE PERSON WHOSE NAME IS SUBSCRIBED TO THE WITHIN INSTRUMENT AND ACKNOWLEDGED TO ME THAT SHE EXECUTED THE SAME IN HER AUTHORIZED CAPACITY, AND THAT BY HER SIGNATURE ON THE INSTRUMENT, OR THE ENTITY UPON BEHALF OF WHICH THE PERSON ACTED, EXECUTED THE INSTRUMENT.

WITNESS MY HAND AND OFFICIAL SEAL.

Linda Carr

Linda Carr  
Plumas County  
Comm # 1099141  
Exp. 5-30-2000

**SURVEYOR'S STATEMENT**

THIS MAP AND THE SURVEY PERFORMED THEREFORE IN JUNE 1996, WERE MADE BY ME OR UNDER MY DIRECTION. THE SURVEY IS TRUE AND COMPLETE AS SHOWN. ALL OF THE MONUMENTS SHOWN HEREON ARE OF THE CHARACTER AND OCCUPY THE POSITIONS INDICATED, OR THEY WILL BE SET IN SUCH POSITIONS ON OR BEFORE ONE YEAR AFTER RECORDATION OF THIS MAP BY THE PLUMAS COUNTY RECORDER, THE MONUMENTS ARE, OR WILL BE SUFFICIENT TO ENABLE THE SURVEY TO BE RETRACED.

DATED: 8-26-97 BY: Daniel B. Bastian  
DANIEL B. BASTIAN  
L.S. 7045  
LICENSE EXP. DATE: 12/31/98

**COUNTY SURVEYOR'S STATEMENT**

I HAVE EXAMINED THIS MAP AND FIND IT IS SUBSTANTIALLY THE SAME AS IT APPEARED ON THE TENTATIVE MAP AND ANY APPROVED ALTERATIONS THEREOF. ALL PROVISIONS OF THE SUBDIVISION MAP ACT AND ANY LOCAL ORDINANCES APPLICABLE AT THE TIME OF APPROVAL OF THE TENTATIVE MAP HAVE BEEN COMPLIED WITH; AND I AM SATISFIED THAT THE MAP IS TECHNICALLY CORRECT.

DATED: 9/9/97 BY: R. Tom Hunter  
R. TOM HUNTER, R.C.E. 30515  
PLUMAS COUNTY SURVEYOR  
LICENSE EXP. DATE: 3/31/00

**COUNTY CLERK'S CERTIFICATE**

I, JUDITH WELLS, CLERK OF THE COUNTY OF PLUMAS, STATE OF CALIFORNIA AND EX OFFICIO CLERK OF THE BOARD OF SUPERVISORS OF SAID COUNTY, HEREBY CERTIFY THAT THE HEREIN EMBODIED MAP WAS APPROVED BY SAID BOARD OF SUPERVISORS CONVENED IN A REGULAR MEETING UPON THE 9 DAY OF Sept, 1997. THE OFFERS OF DEDICATION OF THE PUBLIC UTILITY EASEMENTS (P.U.E.) AND FOX TAIL LANE, AS SHOWN ON THE MAP, WERE ACCEPTED FOR THE USES NOTED.

DATED: September 10, 1997 BY: Judith Wells  
JUDITH WELLS  
COUNTY CLERK

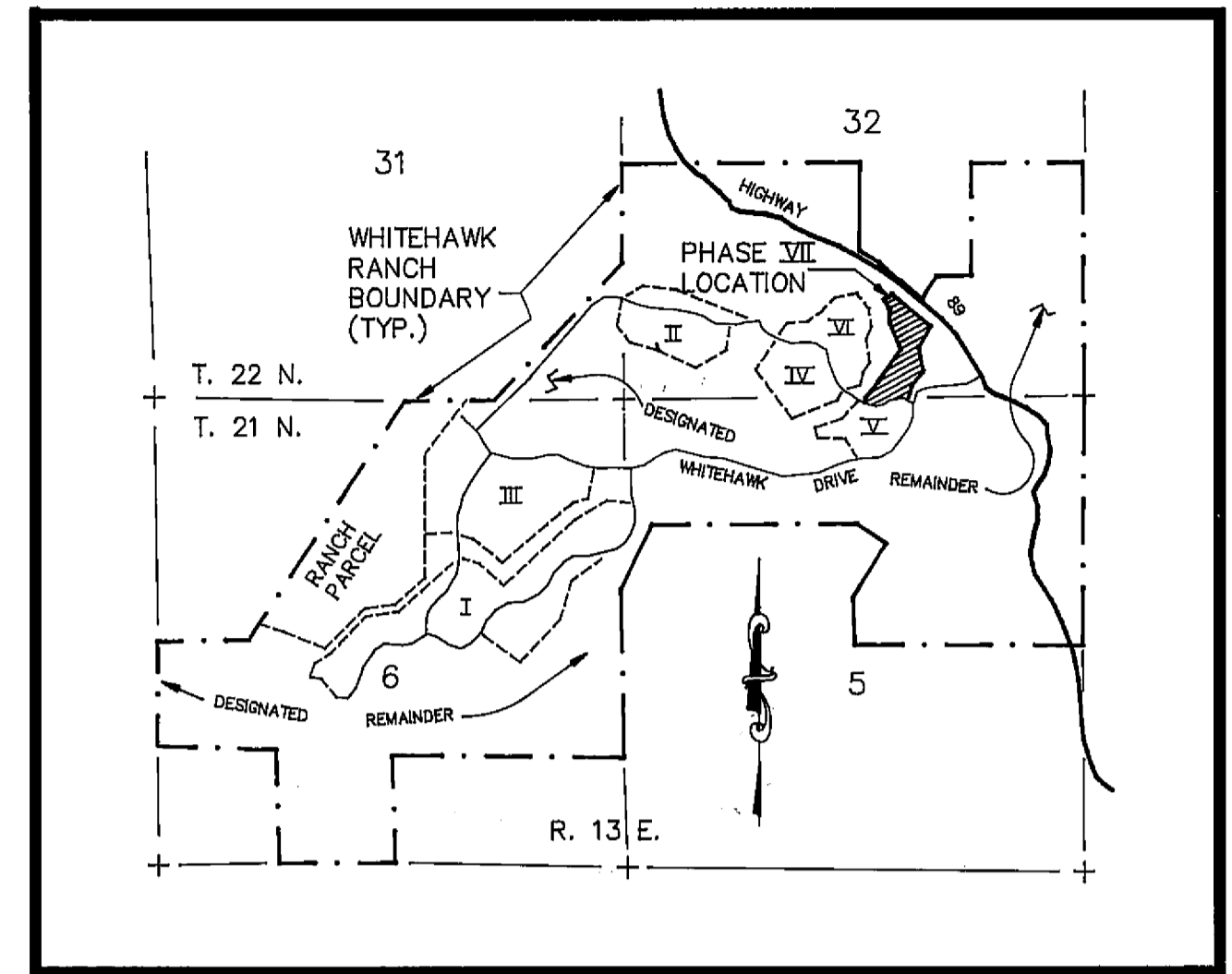

LOCATION MAP  
SCALE: 1" = 2000'

**COUNTY RECORDER'S CERTIFICATE**

FILED THIS 10<sup>th</sup> DAY OF September, 1997, AT 11:10 A.M. IN BOOK 8 OF MAPS, AT PAGE 60-61, AT THE REQUEST OF THE COUNTY SURVEYOR.

FEE: \$ 10.00  
FILE NO. 6189

JUDITH WELLS  
COUNTY RECORDER

BY: Jane Perry  
DEPUTY

**AREA TABULATION**

LOTS 1 THROUGH 21 ----- 8.88 AC.  
FOX TAIL LANE ----- 1.34 AC.  
TOTAL ----- 10.22 AC.

**WHITEHAWK RANCH  
PHASE VII**

**A PLANNED DEVELOPMENT**

FOR

**WHITEHAWK DEVELOPMENT GROUP, LLC**

WITHIN PORTIONS OF: SECTION 32, T.22N., R.13E.,  
AND SECTION 5, T.21N., R.13E., M.D.M.  
PLUMAS COUNTY, CALIFORNIA

PREPARED BY:

**BASTIAN ENGINEERING**

P.O. BOX 280  
GRAEAGLE, CALIFORNIA 96103  
L.S. 7045