

OWNERS STATEMENT

We, Roger W. Clark and Bonnie M. Clark, trustees of the Clark Family Living Trust, dated December 8, 1989, having record title interest in the hereon subdivided lands do hereby consent to the preparation and recording of the map.

COUNTY SURVEYOR'S STATEMENT

I have examined this map and find that it is substantially the same as it appeared on the tentative map and any approved alterations thereof. All provisions of the Subdivision Map Act and any local ordinances applicable at the time of approval of the tentative map have been complied with and I am satisfied that the map is technically correct.

Dated: 5/5/98

R. Tom Hunter
R. Tom Hunter, R.C.E. 30515
Plumas County Surveyor
License Expiration Date 3-31-00

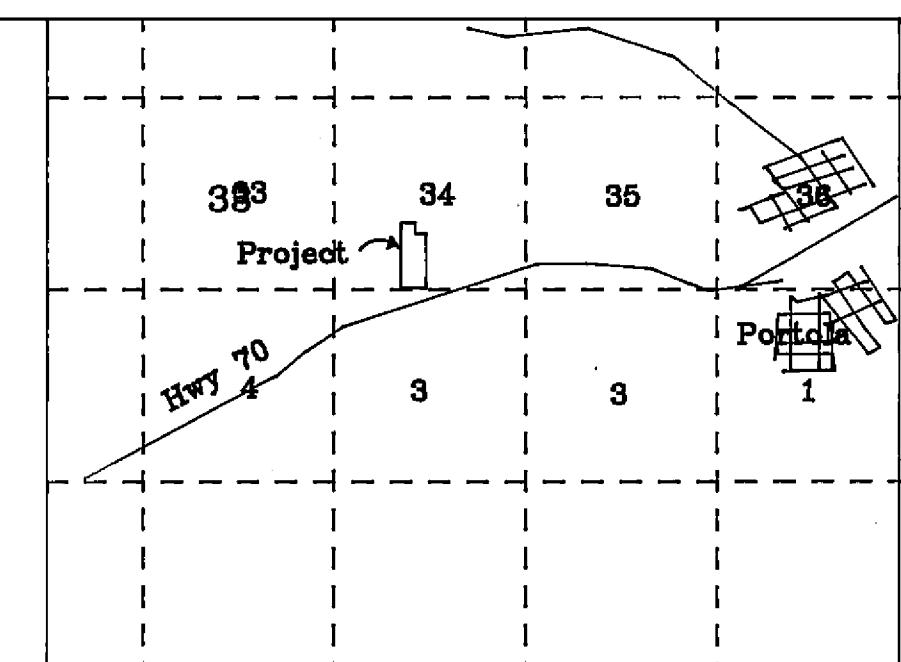

Location Map
T23N, R13E, Sec 34

Clark Family Living Trust, dated December 8, 1989

Dated: 3-30-98

Roger W. Clark
Roger W. Clark, trustee

Bonnie M. Clark
Bonnie M. Clark, trustee

COUNTY TAX COLLECTOR'S CERTIFICATE

I, Barbara J. Coates, Tax Collector of the County of Plumas, State of California do hereby certify that there are no tax liens against the Lots, as shown hereon, for unpaid state, county, municipal, or local taxes or special assessments collected as taxes, except taxes or assessments not yet payable. Taxes or assessments which are a lien but not yet payable, are estimated to be in the amount of \$ 2356.00

Dated: 5-5-98

Barbara J. Coates
Barbara J. Coates, Tax Collector
Barbara J. Coates
Plumas County Tax Collector

Area Tabulation	
Total:	19.51 ac
Roads:	2.02 ac
Lots (Net)	17.49 ac

NOTARY ACKNOWLEDGEMENT

STATE OF CALIFORNIA)
COUNTY OF PLUMAS)

On this 30th day of MARCH, 1997, before me, the undersigned, a Notary Public in and for said State, personally appeared Roger W. Clark and Bonnie M. Clark, personally known to me, or proved to me on the basis of satisfactory evidence to be the person(s) whose name(s) is/are subscribed to the within instrument, and acknowledged to me that he/she/they executed the same in his/her/their authorized capacity(ies), and that by his/her/their signature(s) on the instrument, the person(s), or the entity upon behalf of which the person(s) acted, executed the instrument.

Witness my hand and official seal.

Pamela J. Emery
Pamela J. Emery, Notary Public
Commission #168887 expires JAN 15, 2002
Plumas County, California

COUNTY RECORDER'S STATEMENT

Filed this 7th day of MAY, 1998 at 11:30 A.M. in Book 8 of Maps, at page 86-89, at the request of the County Surveyor.

Fee: 14.00

Judith Wells
County Recorder

File No. 3306

by Thomas Crawford
Deputy

COUNTY BOARD CLERK'S CERTIFICATE

I, Nancy DaForno, Clerk to the Plumas County Board of Supervisors, hereby certify that the herein embodied map was approved by said Board of Supervisors convened in a regular meeting upon the day of , 1998.

Dated: 5-6-98

Carol L. Barker, Deputy Clerk
Nancy DaForno
Clerk of the Board of Supervisors

ENGINEER'S STATEMENT

This map and the survey performed thereon in Nov. 1995 were made by me or under my direction. The survey is true and complete as shown. All of the monuments shown hereon are of the character and occupy the positions indicated and are sufficient to enable the survey to be retraced.

Date: 12-1-97

Clifford R. Brown
Clifford R. Brown
RCE 22836 EXP. 12-31-01



"MAXWELL CAMP" SUBDIVISION

A Planned development density transfer
-For-

Owner: Roger W. Clark and Bonnie M. Clark,
Trustees of the Clark Family Living Trust,
dated December 8, 1989

A division of 17 Lots within a portion
of the SW 1/4 of Section 34, T23N R13E, MDM.
near Town of Delleker, Plumas Co., CA

Engineer: Clifford R. Brown Engineering & Survey
2335 Ponderosa St.
Quincy, CA. 95971
(916) 283-3959