

SURVEYOR'S STATEMENT

THIS MAP AND THE SURVEY PERFORMED THEREFOR IN APRIL, 1999, WERE MADE BY ME OR UNDER MY DIRECTION. THE SURVEY IS TRUE AND COMPLETE AS SHOWN. ALL OF THE MONUMENTS SHOWN HEREON ARE OF THE CHARACTER AND OCCUPY THE POSITIONS INDICATED AND ARE SUFFICIENT TO ENABLE THE SURVEY TO BE RETRACED.

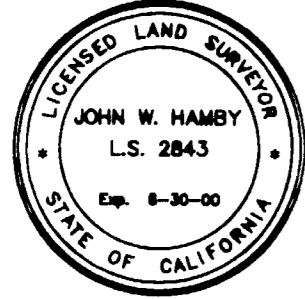

DATED: 8-20-99

John W. Hamby  
JOHN W. HAMBY L.S. 2843

COUNTY BOARD CLERK'S CERTIFICATE

I, NANCY DAFORNO, CLERK TO THE PLUMAS COUNTY BOARD OF SUPERVISORS, HEREBY CERTIFY THAT THE HEREIN EMBODIED MAP WAS APPROVED BY SAID BOARD OF SUPERVISORS CONVENED IN A REGULAR MEETING UPON THE DAY OF August, 1999. THE OFFER OF DEDICATION FOR EASEMENTS AS SHOWN ON THE MAP WERE ACCEPTED FOR THE USES NOTED.

DATED: 8/31/99

Nancy DAFORNO  
NANCY DAFORNO  
CLERK TO THE BOARD OF SUPERVISORS

COUNTY SURVEYOR'S STATEMENT

I HAVE EXAMINED THIS MAP AND FIND IT IS SUBSTANTIALLY THE SAME AS IT APPEARED ON THE TENTATIVE MAP AND ANY APPROVED ALTERATIONS THEREOF. ALL PROVISIONS OF THE SUBDIVISION MAP ACT AND ANY LOCAL ORDINANCES APPLICABLE AT THE TIME OF APPROVAL OF THE TENTATIVE MAP HAVE BEEN COMPLIED WITH, AND I AM SATISFIED THAT THE MAP IS TECHNICALLY CORRECT.

DATED 9-1-99

R. Tom Hunter  
R. TOM HUNTER R.C.E.30515  
PLUMAS COUNTY SURVEYOR  
LICENSE EXP. DATE 3-31-00

COUNTY TAX COLLECTOR'S CERTIFICATE

I, BARBARA J. COATES, TAX COLLECTOR OF THE COUNTY OF PLUMAS, STATE OF CALIFORNIA, DO HEREBY CERTIFY THEY THERE ARE NO TAX LIENS AGAINST THE LOTS AS SHOWN HEREON FOR UNPAID STATE, COUNTY, MUNICIPAL OR LOCAL TAXES OR SPECIAL ASSESSMENTS COLLECTED AS TAXES, EXCEPT TAXES OR ASSESSMENTS NOT YET PAYABLE. TAXES OR ASSESSMENTS WHICH ARE A LIEN BUT NOT YET PAYABLE ARE ESTIMATED TO BE IN THE AMOUNT OF \$0.00.

DATED: 8-24-99

Barbara J. Coates by: Henry Dunbar, aud.  
BARBARA J. COATES  
PLUMAS COUNTY TAX COLLECTOR

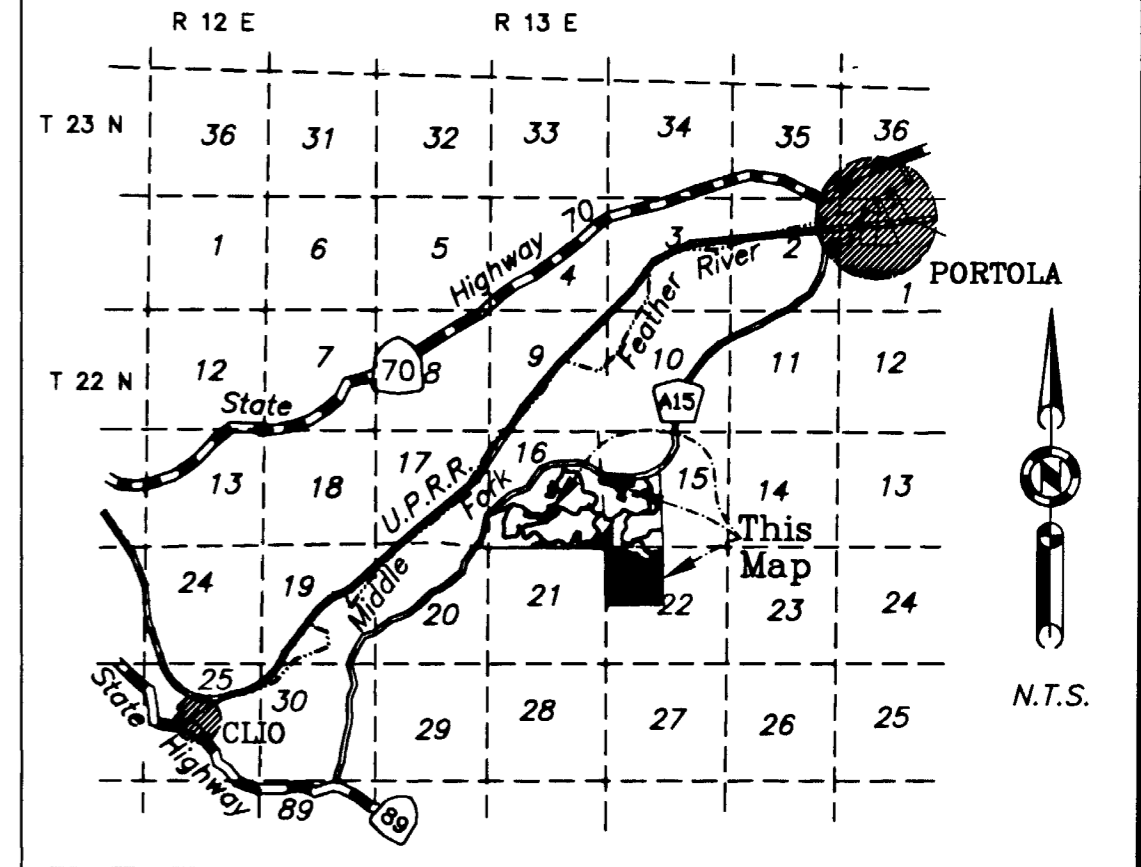

LOCATION MAP

TRUSTEE'S CERTIFICATE

CAL-SIERRA TITLE COMPANY, AS TRUSTEE UNDER A DEED OF TRUST DATED APRIL 19, 1995, AND RECORDED IN BOOK 653 OF OFFICIAL RECORDS AT PAGE 563, DOES HEREBY CONSENT TO THE PREPARATION AND RECORDING OF THIS MAP.

CAL - SIERRA TITLE COMPANY

DATED: Aug 23, 1999

David O. Windle  
DAVID O. WINDLE

PRESIDENT

OWNER'S STATEMENT

GOLD MOUNTAIN RANCH, INC., A CALIFORNIA CORPORATION, HAVING RECORD TITLE INTEREST IN THE HEREIN SUBDIVIDED LANDS, DOES HEREBY CONSENT TO THE PREPARATION AND RECORDATION OF THIS MAP.

EAGLES NEST, CLOUDS REST, STAR TOP, BLAZING STAR, BEAR PAW, RED SKY, MOON SHADOW AND MORNING STAR AND THE 10' SNOW STORAGE AND P.U.E. EASEMENTS AS SHOWN ON THE MAP ARE HEREBY OFFERED FOR DEDICATION AS PUBLIC UTILITY EASEMENTS FOR UNDERGROUND UTILITIES AND AS ACCESS FOR MAINTENANCE THEREOF AND WILL BE GRANTED TO THE GOLD MOUNTAIN HOME OWNERS ASSOCIATION AS PRIVATE ROADS AND P.U.E.'S FOR COMMON USE OF THE OWNERS OF GOLD MOUNTAIN PLANNED DEVELOPMENT. SAID PRIVATE ROADS WILL BE MAINTAINED BY THE GOLD MOUNTAIN HOMEOWNERS ASSOCIATION.

GOLD MOUNTAIN RANCH, INC.

Daniel D. Garner  
DARIEL D. GARNER, President

Margaret M. Garner  
MARGARET M. GARNER, Secretary

State of CALIFORNIA }  
County of PLUMAS }

On Aug 23, 1999 before me, S. Paulsen  
personally appeared David O. Windle

personally known to me - OR - proved to me on the basis of satisfactory evidence to be the person whose name is subscribed to the within instrument and acknowledged to me that he executed the same in his authorized capacity, and that by his signature on the instrument the person or the entity upon behalf of which the person acted, executed the instrument.

My Commission expires 5-10-2003

WITNESS my hand and official seal.  
S. Paulsen  
#1218918

State of California }  
County of Plumas }

On August 20, 1999 before me, Paulette Thomas, Notary Public  
personally appeared DARIEL D. GARNER and MARGARET M. GARNER

personally known to me - OR - proved to me on the basis of satisfactory evidence to be the persons whose names are subscribed to the within instrument and acknowledged to me that they executed the same in their authorized capacities, and that by their signatures on the instrument the persons or the entity upon behalf of which the persons acted, executed the instrument.

My Commission expires July 3, 2000

WITNESS my hand and official seal.  
Paulette Thomas  
#1104694

AREA TABULATION

177.51 net acres in Lots  
13.42 acres in road easements  
190.93 acres total

COUNTY RECORDER'S CERTIFICATE

FILED THIS 1st DAY OF September 1999, AT 1:58 P.M. IN BOOK 8 OF MAPS AT PAGE 123 - 133 AT THE REQUEST OF THE COUNTY SURVEYOR.

FEE \$28.00

FILE NO. 6895

JUDITH WELLS, COUNTY RECORDER

By Deborah A. Housem  
DEPUTY

GOLD MOUNTAIN  
UNIT 15 "EAGLES NEST"  
a Planned Development  
for  
Gold Mountain Ranch, Inc.

A Portion of Sections 15, 16 & 22  
T. 22 N., R 13 E., M.D.M.  
Plumas County, California  
Scale 1" = 100' July, 1999

Hamby Surveying Inc.  
P.O. Box 1209  
Portola, CA 96122  
(530) 832-5571