

OWNER'S STATEMENT

I, DAVID C. NORTON, HAVING RECORD TITLE INTEREST IN THE HEREON SUBDIVIDED LANDS DO HEREBY CONSENT TO THE PREPARATION AND RECORDATION OF THIS MAP. I DO HEREBY OFFER FOR DEDICATION FOR PUBLIC UTILITY PURPOSES UPPER MEADOW WAY, LOWER MEADOW WAY AND THE 10 FOOT EASEMENTS ADJACENT TO THE SIDELINES OF SAID ROADS. UPPER MEADOW WAY AND LOWER MEADOW WAY ARE PRIVATE EASEMENTS NOT SUBJECT TO IMPROVEMENT OR MAINTENANCE BY PLUMAS COUNTY. SUCH EASEMENTS WILL NOT BECOME EFFECTIVE UNLESS AND UNTIL RESERVATIONS AND GRANTS ARE INCLUDED IN THE RESPECTIVE DEEDS.

DATED: 9/25/01

David C. Norton
DAVID C. NORTON

NOTARY

STATE OF CALIFORNIA

COUNTY OF PLUMAS

ON 9/25/01 BEFORE ME Delphine E. Eisler PERSONALLY APPEARED DAVID C. NORTON PERSONALLY KNOWN TO ME OR PROVED ON THE BASIS OF SATISFACTORY EVIDENCE TO BE THE PERSON WHOSE NAME IS SUBSCRIBED TO THE WITHIN INSTRUMENT AND ACKNOWLEDGED TO ME THAT HE EXECUTED THE SAME IN HIS AUTHORIZED CAPACITY, AND THAT BY HIS SIGNATURE ON THE INSTRUMENT, THE PERSONS OR ENTITY UPON BEHALF OF WHICH HE ACTED, EXECUTED THE INSTRUMENT.

WITNESS MY HAND AND OFFICIAL SEAL.

Delphine E. Eisler
SIGNATURE OF NOTARY

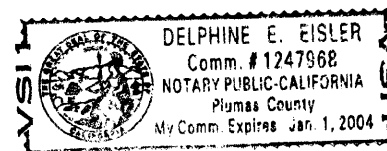

MY COMMISSION EXPIRES January 1, 2004

COUNTY BOARD CLERK'S CERTIFICATE

I, NANCY DAFORNO, CLERK TO PLUMAS COUNTY BOARD OF SUPERVISORS, HEREBY CERTIFY THAT THE HEREIN EMBODIED MAP WAS APPROVED BY SAID BOARD OF SUPERVISORS CONVENED IN A REGULAR MEETING UPON THE 27th DAY OF Oct, 2001. THE OFFER OF DEDICATION FOR EASEMENTS AS SHOWN ON THE MAP WERE ACCEPTED FOR THE USES NOTED.

DATED: 10/02/01

Nancy DeForno
Nancy DeForno
Clerk to the Board of Supervisors

SURVEYOR'S STATEMENT

THIS MAP AND THE SURVEY PERFORMED THEREFORE IN SEPTEMBER, 2000 WERE MADE BY ME OR UNDER MY DIRECTION. THE SURVEY IS TRUE AND COMPLETE AS SHOWN. ALL OF THE MONUMENTS SHOWN HEREON ARE OF THE CHARACTER AND OCCUPY THE POSITIONS INDICATED AND ARE SUFFICIENT TO ENABLE THE SURVEY TO BE RETRACED.

DATED: Dec 22, 2000

Gerald Joseph Tibbedeaux
GERALD JOSEPH TIBBEDEAUX
P.L.S. 6051
LICENSE EXPIRES 06/30/05

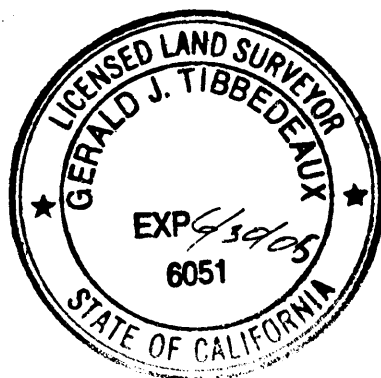

COUNTY SURVEYOR'S STATEMENT

I HAVE EXAMINED THIS MAP AND FIND IT TO BE SUBSTANTIALLY THE SAME AS IT APPEARED ON THE TENTATIVE MAP AND ANY APPROVED ALTERATIONS THEREOF. ALL PROVISIONS OF THE SUBDIVISION MAP ACT AND ANY LOCAL ORDINANCE APPLICABLE AT THE TIME OF APPROVAL OF THE TENTATIVE MAP HAVE BEEN COMPLIED WITH AND I AM SATISFIED THAT THE MAP IS TECHNICALLY CORRECT.

DATED: 10/2/01

R. Tom Hunter
R. TOM HUNTER, R.C.E. 30515
PLUMAS COUNTY SURVEYOR
LICENSE EXPIRATION DATE 03/31/04

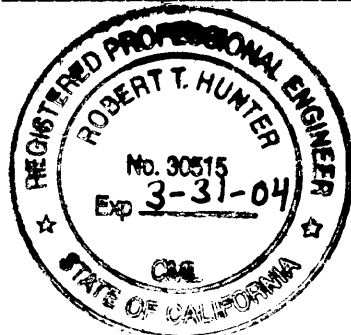

COUNTY RECORDER'S STATEMENT

FILED THIS 3rd DAY OF October, 2001, AT 3:09 P.M.
IN BOOK 9 OF MAPS AT PAGE 39-41 AT THE REQUEST OF THE COUNTY SURVEYOR.

JUDITH WELLS
COUNTY RECORDER

BY: *Debbie Samuel*
DEPUTY

FEE \$12.00
FILE No. 2001-08440

COUNTY TAX COLLECTOR'S CERTIFICATE

I, BARBARA J. COATES, TAX COLLECTOR OF THE COUNTY OF PLUMAS, STATE OF CALIFORNIA, DO HEREBY CERTIFY THAT THERE ARE NO TAX LIENS AGAINST THE LOTS, AS SHOWN HEREON, FOR UNPAID STATE, COUNTY, MUNICIPAL, OR LOCAL TAXES OR SPECIAL ASSESSMENTS COLLECTED AS TAXES, EXCEPT TAXES OR ASSESSMENTS NOT YET PAYABLE. TAXES OR ASSESSMENTS WHICH ARE A LIEN BUT NOT YET PAYABLE, ARE ESTIMATED TO BE IN THE AMOUNT OF \$ 1583.00.

DATED: 9-25-01

Barbara J. Coates by Ginny Dunbar
BARBARA J. COATES
PLUMAS COUNTY TAX COLLECTOR

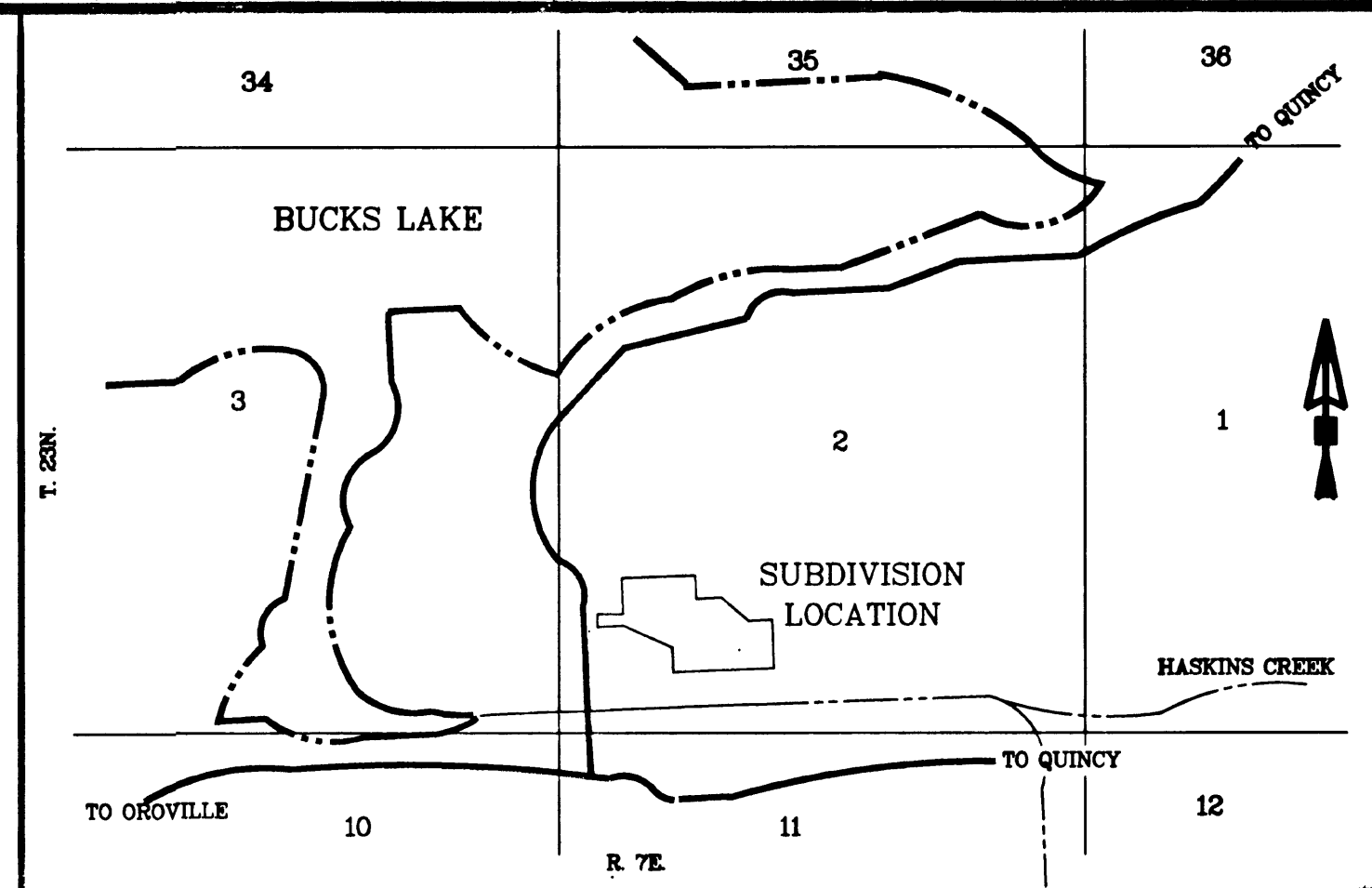

VICINITY MAP N.T.S.

NORTON MEADOWS UNIT No. 1
A SUBDIVISION AND PLANNED DEVELOPMENT
FOR
DAVID C. NORTON
A PART OF THE PROPERTY SHOWN IN
BOOK 11 OF RECORDS OF SURVEYS AT PAGE 98
AND A PORTION OF SEC. 2, T. 23N., R. 7E., M.D.M.
PLUMAS COUNTY CALIFORNIA
SEPTEMBER, 2004

Tibbedeaux Surveying
P.O. Box 1960 / 585 Ridge St.
Portola, CA 96122
(530) 832-5772

D:\00-13DN\00-13-5

SHEET 1 OF 3