

SURVEYOR'S STATEMENT

THIS MAP AND THE SURVEY PERFORMED THEREFOR IN DECEMBER, 2003, WERE MADE BY ME OR UNDER MY DIRECTION. THE SURVEY IS TRUE AND COMPLETE AS SHOWN. ALL OF THE MONUMENTS SHOWN HEREON ARE OF THE CHARACTER AND OCCUPY THE POSITIONS INDICATED AND ARE SUFFICIENT TO ENABLE THE SURVEY TO BE RETRACED.

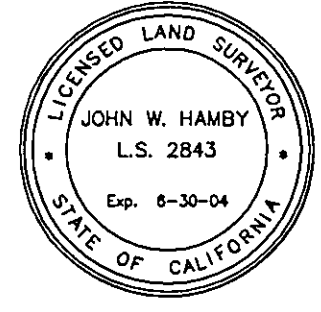

DATED: 4/01/04

John W. Hamby L.S. 2843

COUNTY TAX COLLECTOR'S CERTIFICATE

I, GINNY DUNBAR, TAX COLLECTOR OF THE COUNTY OF PLUMAS, STATE OF CALIFORNIA, DO HEREBY CERTIFY THAT THERE ARE NO TAX LIENS AGAINST THE LOTS AS SHOWN HEREON FOR UNPAID STATE, COUNTY, MUNICIPAL OR LOCAL TAXES OR SPECIAL ASSESSMENTS COLLECTED AS TAXES, EXCEPT TAXES OR ASSESSMENTS NOT YET PAYABLE. TAXES OR ASSESSMENTS WHICH ARE A LIEN BUT NOT YET PAYABLE ARE ESTIMATED TO BE IN THE AMOUNT OF 11,392.00.

DATED: 4-19-04

Ginny Dunbar GINNY DUNBAR PLUMAS COUNTY TAX COLLECTOR

COUNTY SURVEYOR'S STATEMENT

I HAVE EXAMINED THIS MAP AND FIND IT IS SUBSTANTIALLY THE SAME AS IT APPEARED ON THE TENTATIVE MAP AND ANY APPROVED ALTERATIONS THEREOF. ALL PROVISIONS OF THE SUBDIVISION MAP ACT AND ANY LOCAL ORDINANCES APPLICABLE AT THE TIME OF APPROVAL OF THE TENTATIVE MAP HAVE BEEN COMPLIED WITH, AND I AM SATISFIED THAT THE MAP IS TECHNICALLY CORRECT.

DATED 4/20/04

R. Tom Hunter R. TOM HUNTER R.C.E.30515 PLUMAS COUNTY SURVEYOR LICENSE EXP. DATE 3-31-06

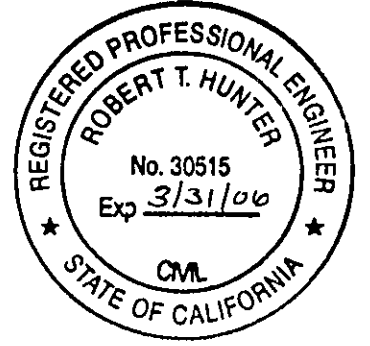

OWNER'S STATEMENT

GRIZZLY CREEK DEVELOPMENT, L.L.C., HAVING RECORD TITLE INTEREST IN THE HEREIN SUBDIVIDED LANDS, DOES HEREBY CONSENT TO THE PREPARATION AND RECORDATION OF THIS MAP.

BLACKTAIL POINTE, ARROWLEAF ROAD, BLUE GROUSE LANE, YARROW LANE, AND SNOWBUSH WAY AND P.U.E. EASEMENTS AS SHOWN ON THE MAP ARE HEREBY OFFERED FOR DEDICATION AS PUBLIC UTILITY EASEMENTS FOR UNDERGROUND UTILITIES, AND AS ACCESS FOR MAINTENANCE THEREOF AND WILL BE GRANTED TO THE GRIZZLY RANCH ASSOCIATION AS PRIVATE ROADS, P.U.E.S AND SNOW STORAGE EASEMENTS FOR COMMON USE OF THE OWNERS OF GRIZZLY RANCH ASSOCIATION. SAID PRIVATE ROADS WILL BE MAINTAINED BY THE GRIZZLY RANCH ASSOCIATION.

GRIZZLY CREEK DEVELOPMENT, L.L.C. A DELAWARE LIMITED LIABILITY COMPANY

BY: GRIZZLY CREEK MANAGER, L.L.C. A CALIFORNIA LIMITED LIABILITY COMPANY ITS MANAGING MEMBER

BY: DDC GRIZZLY CREEK, INC., A CALIFORNIA CORPORATION ITS MANAGER

Michael A. Mohler SENIOR VICE PRESIDENT

J. R. Tash VICE PRESIDENT & CONTROLLER

TRUSTEE'S CERTIFICATE

CAL-SIERRA TITLE COMPANY, AS TRUSTEE UNDER A DEED OF TRUST DATED 1-09-2002, AND RECORDED ON 1-11-2002 AS DOCUMENT NO. 2002-000405 OF OFFICIAL RECORDS, DOES HEREBY CONSENT TO THE PREPARATION AND RECORDING OF THIS MAP AND CONSENTS TO THE DEDICATION FOR UNDERGROUND PUBLIC UTILITY EASEMENTS AND ACCESS FOR MAINTENANCE AS SHOWN.

DATED: 4/2/04

CAL - SIERRA TITLE COMPANY By: David O. Windle PRESIDENT

State of CALIFORNIA } County of PLUMAS }

On 4-2-04 before me, Tiffany Walsh personally appeared David O. Windle

personally known to me - OR - [] proved to me on the basis of satisfactory evidence to be the person whose name is subscribed to the within instrument and acknowledged to me that he executed the same in his authorized capacity, and that by his signature on the instrument the person or the entity upon behalf of which the person acted, executed the instrument.

My Commission expires 11/18/06 WITNESS my hand and official seal.

11/18/06 COMM.# 1385163

State of California } County of Plumas }

On April 1, 2004 before me, M. Eschenbaum personally appeared Michael A. Mohler and J.R. Tash

[X] personally known to me - OR - [] proved to me on the basis of satisfactory evidence to be the persons whose names are subscribed to the within instrument and acknowledged to me that they executed the same in their authorized capacities, and that by their signatures on the instrument the persons or the entity upon behalf of which the persons acted, executed the instrument.

My Commission expires March 22, 2006 WITNESS my hand and official seal.

M. Eschenbaum

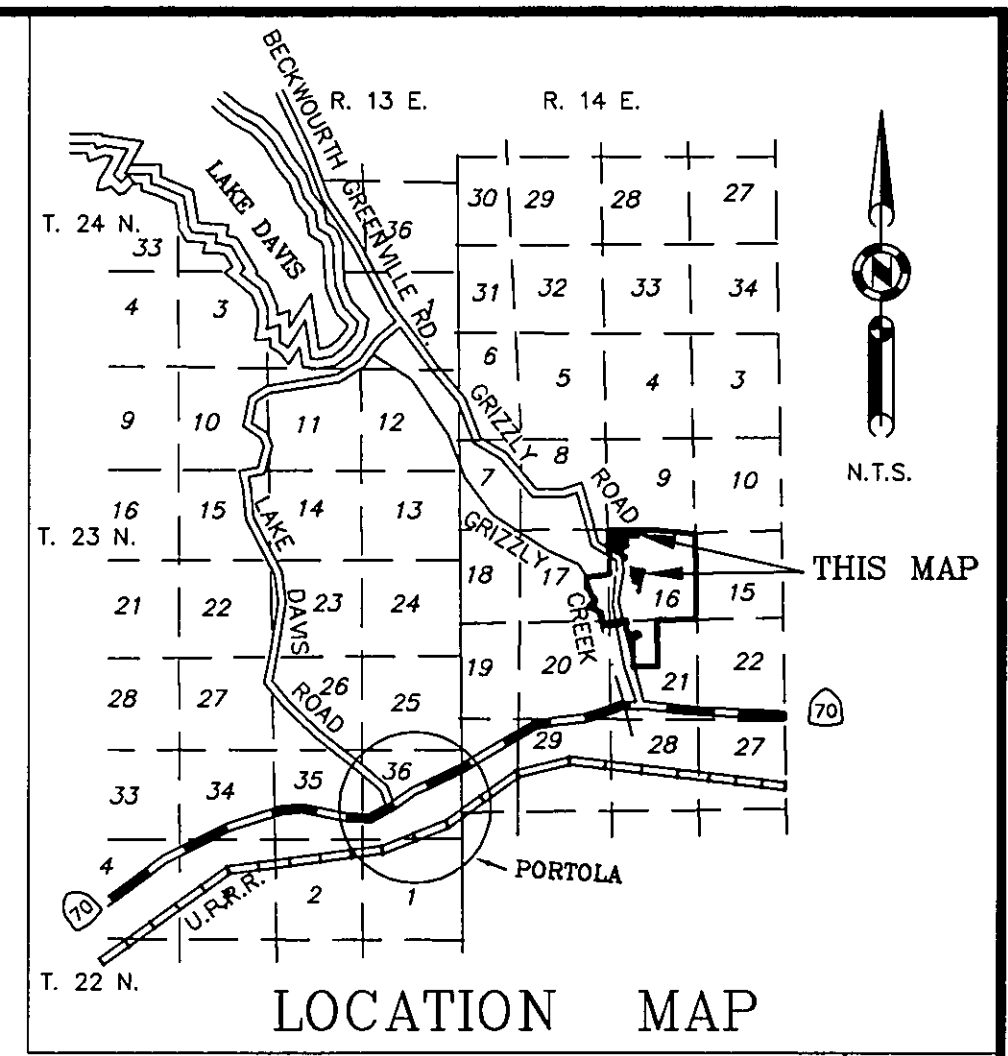

AREA TABULATION

Table with 2 columns: Area Type, Acres. Rows: 49.67 acres in Lots, 4.76 acres in roads, 54.43 acres total.

COUNTY BOARD CLERK'S CERTIFICATE

I, NANCY DAFORNO, CLERK TO THE PLUMAS COUNTY BOARD OF SUPERVISORS, HEREBY CERTIFY THAT THE HEREIN EMBODIED MAP WAS APPROVED BY SAID BOARD OF SUPERVISORS CONVENED IN A REGULAR MEETING UPON THE DAY OF April, 2004. THE OFFER OF DEDICATION FOR UNDERGROUND PUBLIC UTILITY EASEMENTS AND ACCESS FOR MAINTENANCE AS SHOWN ON THE MAP WERE ACCEPTED FOR THE USES NOTED.

DATED: 4/20/04

Nancy Daforno NANCY DAFORNO CLERK TO THE BOARD OF SUPERVISORS

COUNTY RECORDER'S CERTIFICATE

FILED THIS 21st DAY OF April 2004, AT 2:11 P.M. IN BOOK 9 OF MAPS AT PAGE 113-119 AT THE REQUEST OF THE COUNTY SURVEYOR.

FEE \$20.00

FILE NO. 2004-370B

KATHLEEN WILLIAMS, COUNTY RECORDER

Jenny Dillinger DEPUTY

GRIZZLY RANCH, UNIT 2 a Planned Development For Grizzly Creek Development, L.L.C.

Parcel E & Parcel I of 9 M 88 and a portion of Section 16 T. 23 N., R. 14E., M.D.M.

Plumas County ~ California Scale 1" = 100' December, 2003

Hamby Surveying Inc. P.O. Box 1209 Portola, CA 96122 (530) 832-5571