

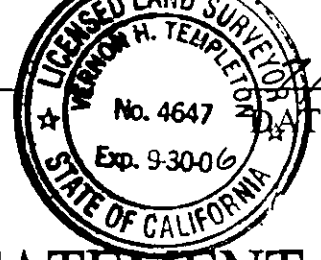

### SURVEYOR'S STATEMENT

This map was prepared by me or under my direction and is based upon a field survey in conformance with the requirements of the Subdivision Map Act and local ordinance at the request of Douglas Dunn in March, 2004. I hereby state that this Final Map substantially conforms to the conditionally approved Tentative Map. All of the monuments shown hereon are of the character and occupy the positions indicated, or they will be set in such positions on or before one year after the recordation of this map by the Plumas County Recorder and the monuments are or will be sufficient to enable the survey to be retraced.

*Vernon H. Templeton*  
VERNON H. TEMPLETON, LS 4647  

### COUNTY SURVEYOR'S STATEMENT

I have examined this map and find it is substantially the same as it appeared on the tentative map and any approved alterations thereof. All provisions of the Subdivision Map Act and any local ordinances applicable at the time of approval of the tentative map have been complied with and I am satisfied that the map is technically correct.

*Tom Hunter*  
R. TOM HUNTER, RCE 30515  
PLUMAS COUNTY SURVEYOR  
(lic. exp. 3/31/06)  

### COUNTY TAX COLLECTOR'S CERTIFICATE

I, Ginny Dunbar, Tax Collector of the County of Plumas, State of California, do hereby certify that there are no tax liens against the lots, as shown hereon, for unpaid State, County, Municipal, or Local taxes or special assessments collected as taxes, except taxes or assessments not yet payable. Taxes or assessments which are a lien but not yet payable, are estimated to be in the amount of 4,401.00

*Ginny Dunbar*  
Ginny Dunbar  
Plumas County Tax Collector  
ASSY TTC  
DATE 8/2/04

### COUNTY RECORDER'S STATEMENT

Filed this 6<sup>th</sup> day of August, 2004 at 9:50 a.m. in Book 9 of Maps at page 137-138 at the request of the County Engineer.  
FEE: \$10.00 FILE No. 2004-07990

Kathleen Williams, County Recorder  
by *Laura L. Davis*  
Deputy

### COUNTY BOARD CLERK'S CERTIFICATE

I, Nancy DaForno, clerk to the Plumas County Board of Supervisors, hereby certify that the herein embodied map was approved by said Board convened in a regular meeting on the 3rd day of Aug, 2004.

*Nancy DaForno*  
Nancy DaForno  
Clerk to the Board of Supervisors  
DATE 8/6/04

### OWNER'S STATEMENT

Capital Management Resources & ANDINA Company, LLC, having record title interest in the hereon subdivided lands do hereby consent to the preparation and recordation of this map.

CAPTIAL MANAGEMENT RESOURCES  
By: NEXUS FIDUCIARY FOUNDATION, Trustee

By: *Jason Beck* EXEC. SECRETARY Date: 7/20/04  
Jason Beck, Executive Secretary  
Capital Management Resources

ANDINA Company, LLC,

By: *Jo Evelyn Giusti* Date: 8-26-04  
Jo Evelyn Giusti, Manager  
Capital Management Resources

**CONCURRENT MAP TRUSTEE'S STATEMENT**  
A TRUSTEE'S CERTIFICATE CONSENTING TO THE PREPARATION AND RECORDING OF THIS MAP IS ON FILE WITH THE COUNTY RECORDER AS DOCUMENT No. 2004-07989 OF OFFICIAL RECORDS.

### NOTARY ACKNOWLEDGEMENT

STATE OF CALIFORNIA )  
 ) SS  
COUNTY OF NAPA )

On July 26, 2004 before me, the undersigned, a Notary Public in and for said State, personally appeared Jo Evelyn Giusti, personally known to me (or proved to me on the basis of satisfactory evidence) to be the person[s] whose name[s] is/are subscribed to the within instrument and acknowledge to me that he/she/they executed the same in his/her/their authorized capacity[ies], and that by his/her/their signature[s] on the instrument the person[s], or the entity upon behalf of which the person[s] acted, executed the instrument.

WITNESS my hand and official seal.

Signature *Ronald L. Crews*

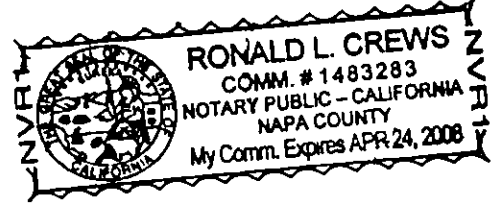

### NOTARY ACKNOWLEDGEMENT

STATE OF Texas )  
 ) SS  
COUNTY OF Montgomery )

On July 20, 2004 before me, the undersigned, a Notary Public in and for said State, personally appeared Jason Beck, personally known to me (or proved to me on the basis of satisfactory evidence) to be the person[s] whose name[s] is/are subscribed to the within instrument and acknowledge to me that he/she/they executed the same in his/her/their authorized capacity[ies], and that by his/her/their signature[s] on the instrument the person[s], or the entity upon behalf of which the person[s] acted, executed the instrument.

WITNESS my hand and official seal.

Signature *Tammy Anderson*

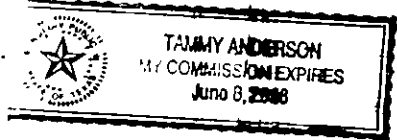

### NOTARY ACKNOWLEDGEMENT

STATE OF Arkansas )  
 ) SS  
COUNTY OF Boone )

On July 22, 2004 before me, the undersigned, a Notary Public in and for said State, personally appeared A. Scott Peterson, personally known to me (or proved to me on the basis of satisfactory evidence) to be the person[s] whose name[s] is/are subscribed to the within instrument and acknowledge to me that he/she/they executed the same in his/her/their authorized capacity[ies], and that by his/her/their signature[s] on the instrument the person[s], or the entity upon behalf of which the person[s] acted, executed the instrument.

WITNESS my hand and official seal.

Signature *Scott Peterson*

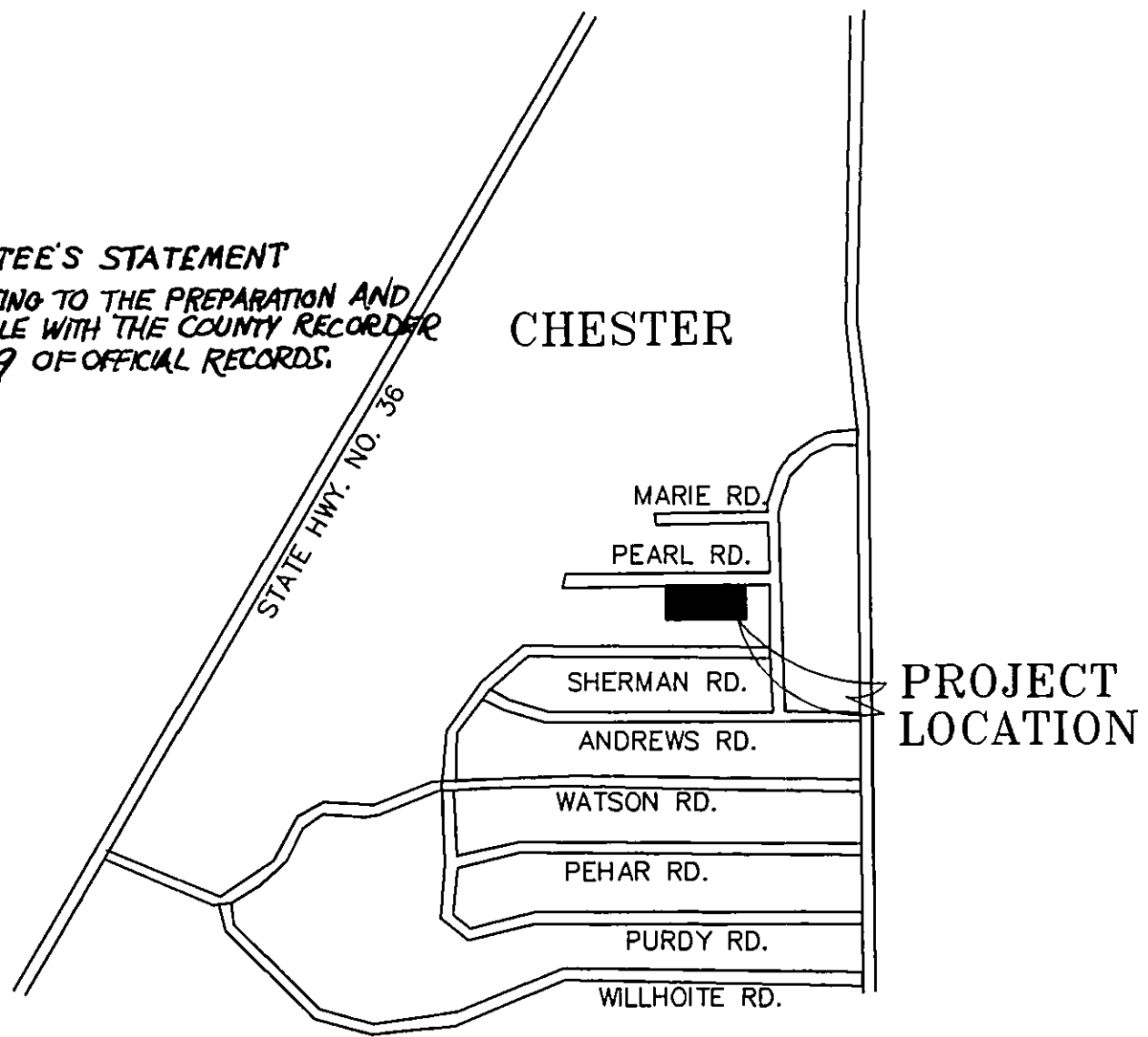
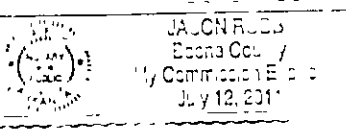

 **VICINITY MAP**  
NOT TO SCALE

### TRUSTEE CERTIFICATE *A. Scott Peterson* EXECUTIVE TRUSTEE

A. Scott Peterson, Executive Trustee of Eastcourt Pension Fund, a Complex Trust recorded in Maricopa County Arizona, as trustee under a Deed of Trust dated 9/10/2002 and recorded as document # 2003-0005191, does hereby consent to the preparation and recording of this map.

### PLANNED DEVELOPMENT STATEMENT

The property shown herein is subject to a Planned Development Permit approved February 11, 2004 which is recorded as Document # 2004-0007988 of Plumas County Official Records. Future Development of this property will be subject to the conditions of said permit.

## SUBDIVISION MAP OF WEST LAKE ESTATES

IN SECTION 8, T28N, R7E MDB&M  
LOTS 6,7 & 8, BLOCK C, VISION LAKE TRACT  
TOWN OF CHESTER, PLUMAS COUNTY, CALIFORNIA

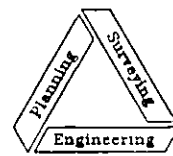
 **NST Engineering, Inc.**  
1495 Riverside Drive  
Susanville, CA 96130  
(530) 257-5173