

SURVEYOR'S STATEMENT

THIS MAP WAS PREPARED BY ME OR UNDER MY DIRECTION AND IS BASED UPON A FIELD SURVEY IN CONFORMANCE WITH THE REQUIREMENTS OF THE SUBDIVISION MAP ACT AND LOCAL ORDINANCE AT THE REQUEST OF GORDON HORSLEY IN SEPTEMBER, 2004. I HEREBY STATE THAT THIS FINAL MAP SUBSTANTIALLY CONFORMS TO THE CONDITIONALLY APPROVED TENTATIVE MAP. ALL OF THE MONUMENTS SHOWN HEREON ARE OF THE CHARACTER AND OCCUPY THE POSITIONS INDICATED AND THE MONUMENTS ARE SUFFICIENT TO ENABLE THE SURVEY TO BE RETRACED.

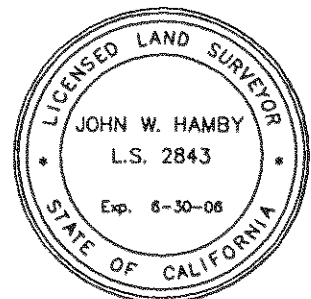

DATED: 7/19/05

John W. Hamby
JOHN W. HAMBY L.S. 2843
LICENSE EXPIRES 6-30-06

COUNTY SURVEYOR'S STATEMENT

I HAVE EXAMINED THIS MAP AND FIND IT IS SUBSTANTIALLY THE SAME AS IT APPEARED ON THE TENTATIVE MAP AND ANY APPROVED ALTERATIONS THEREOF. ALL PROVISIONS OF THE SUBDIVISION MAP ACT AND ANY LOCAL ORDINANCES APPLICABLE AT THE TIME OF APPROVAL OF THE TENTATIVE MAP HAVE BEEN COMPLIED WITH, AND I AM SATISFIED THAT THE MAP IS TECHNICALLY CORRECT.

DATED 8/16/05

R. Tom Hunter
R. TOM HUNTER R.C.E.30515
PLUMAS COUNTY SURVEYOR
LICENSE EXP. DATE 3-31-06

EASEMENT NOTES:
THE SOUTHEAST 1/4 OF SECTION 8 IS SUBJECT TO CERTAIN EASEMENTS OF RECORD.

FEATHER RIVER T.V. CBLE SYSTEMS PER 512 O.R. 31
BOCA & LOYALTON RAILROAD PER 30 DEEDS 425

COUNTY TAX COLLECTOR'S CERTIFICATE

I, GINNY DUNBAR, TAX COLLECTOR OF THE COUNTY OF PLUMAS, STATE OF CALIFORNIA, DO HEREBY CERTIFY THERE ARE NO TAX LIENS AGAINST THE LOTS AS SHOWN HEREON FOR UNPAID STATE, COUNTY, MUNICIPAL OR LOCAL TAXES OR SPECIAL ASSESSMENTS COLLECTED AS TAXES, EXCEPT TAXES OR ASSESSMENTS NOT YET PAYABLE. TAXES OR ASSESSMENTS WHICH ARE A LIEN BUT NOT YET PAYABLE ARE ESTIMATED TO BE IN THE AMOUNT OF 16,210.00.

DATED: 7-26-05

Ginny Dunbar
GINNY DUNBAR
PLUMAS COUNTY TAX COLLECTOR

OWNER'S STATEMENT

THE VILLAGE AT PLUMAS PINES, LLC, A NEVADA LIMITED LIABILITY COMPANY, HAVING RECORD TITLE INTEREST IN THE HEREIN SUBDIVIDED LANDS, DOES HEREBY CONSENT TO THE PREPARATION AND RECORDATION OF THIS MAP.

[Redacted signature]

"EUREKA SPRINGS DRIVE", THE 10 FOOT P.U.E.'S AND THE 15 FOOT P.U.E. AS SHOWN ON THE MAP ARE HEREBY OFFERED FOR DEDICATION AS PUBLIC UTILITY EASEMENTS FOR UNDERGROUND UTILITIES, AND AS ACCESS FOR MAINTENANCE OF THOSE UTILITIES.

"LOT A" AS SHOWN ON THE MAP WILL BE GRANTED TO THE HOMEOWNERS ASSOCIATION FOR THE USE NOTED.

"EUREKA SPRINGS DRIVE", SNOWSTORAGE EASEMENT, AND DRAINAGE EASEMENTS AS SHOWN ON THE MAP WILL BE GRANTED TO THE HOMEOWNERS ASSOCIATION AS A PRIVATE ROAD FOR MAINTENANCE, SNOW REMOVAL, AND COMMON USE OF THE OWNERS OF THE HOMEOWNERS ASSOCIATION. SAID PRIVATE ROADS AND DRAINAGE EASEMENTS WILL BE MAINTAINED BY THE HOMEOWNERS ASSOCIATION.

THE EMERGENCY SECONDARY ACCESS EASEMENT" AS SHOWN ON THE MAP WILL BE GRANTED TO THE HOMEOWNERS ASSOCIATION FOR THE USE NOTED, AND FOR MAINTENANCE OF THE ROAD AND SITE DISTANCE ALONG SAID ROAD.

THE VILLAGE AT PLUMAS PINES, LLC,
A NEVADA LIMITED LIABILITY COMPANY

DATED: 7-19-05

Gordon Horsley
BY: GORDON HORSLEY
PRESIDENT

State of California }
County of Plumas }

On July 19, 2005 before me, Thomas F. Joyce
personally appeared Gordon Horsley

personally known to me - OR - proved to me on the basis of satisfactory evidence to be the persons whose names are subscribed to the within instrument and acknowledged to me that they executed the same in their authorized capacities, and that by their signatures on the instrument the persons or the entity upon behalf of which the persons acted, executed the instrument.

My Commission expires

July 26, 2006

WITNESS my hand and official seal.

Thomas F. Joyce

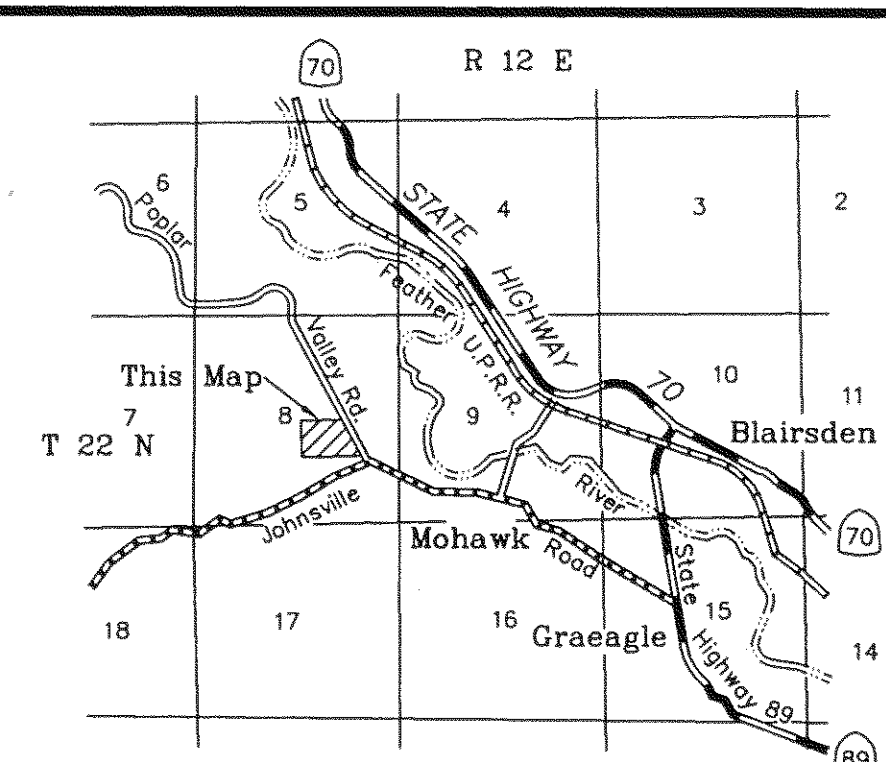
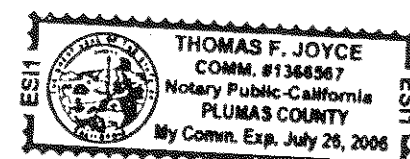

LOCATION MAP

1" = 1 Mile

AREA TABULATION

10.82 acres in Lots
1.55 acres in roads
12.37 acres total

COUNTY BOARD CLERK'S CERTIFICATE

I, NANCY DAFORNO, CLERK TO THE PLUMAS COUNTY BOARD OF SUPERVISORS, HEREBY CERTIFY THAT THE HEREIN EMBODIED MAP WAS APPROVED BY SAID BOARD OF SUPERVISORS CONVENED IN A REGULAR MEETING UPON THE DAY OF August, 2005. THE OFFER OF DEDICATION FOR UNDERGROUND PUBLIC UTILITY/EASEMENTS AND ACCESS FOR MAINTENANCE AS SHOWN ON THE MAP WERE ACCEPTED FOR THE USES NOTED.

DATED: 8/16/05

Nancy Daforno
NANCY DAFORNO
CLERK TO THE BOARD OF SUPERVISORS

COUNTY RECORDER'S CERTIFICATE

FILED THIS 17th DAY OF August 2005, AT 10:28 A.M. IN BOOK 10 OF MAPS AT PAGE 27-29 AT THE REQUEST OF THE COUNTY SURVEYOR.

FEE \$12.00

FILE NO. 2005-0008569

KATHLEEN WILLIAMS, COUNTY RECORDER

Laura L. Davis
DEPUTY

THE VILLAGE AT PLUMAS PINES PHASE 1
for
The Village at Plumas Pines, LLC,
a Nevada Limited Liability Company
A portion of the SE 1/4 of Section 8, T. 22 N., R. 12 E., M.D.M.
being a portion of Mapes Ranch Parcel of 9 RS 75
Plumas County, California
Scale 1"=100' September, 2004

Hamby Surveying Inc.
P.O. Box 1209
Portola, CA 96122
(530) 832-5571