

## OWNER'S STATEMENT

ROBERT F. SCHOENSEE AND JEAN C. SCHOENSEE, HAVING RECORD TITLE INTEREST IN THE HEREON SUBDIVIDED LANDS DO HEREBY CONSENT TO THE PREPARATION AND RECORDATION OF THIS MAP.

THE COUNTY ROAD RIGHT OF WAY AND PUBLIC UTILITY EASEMENT AS SHOWN ON THE MAP AT THE INTERSECTION OF COUNTY ROAD 506 AND 506B IS GRANTED TO PLUMAS COUNTY BY SEPARATE DOCUMENT FILED IN DOCUMENT NO. 2010-0002932, PLUMAS COUNTY RECORDS.

BY: Robert F. Schoensee  
ROBERT F. SCHOENSEE,  
CO-TRUSTEE OF THE ROBERT F. AND JEAN C. SCHOENSEE TRUST DATED NOVEMBER 5, 2003

BY: Jean C. Schoensee  
JEAN C. SCHOENSEE  
CO-TRUSTEE OF THE ROBERT F. AND JEAN C. SCHOENSEE TRUST DATED NOVEMBER 5, 2003

STATE OF CALIFORNIA  
COUNTY OF PLUMAS

ON April 07, 2010, BEFORE ME, Debra Beever, Notary Public PERSONALLY APPEARED ROBERT F. SCHOENSEE AND JEAN C. SCHOENSEE WHO PROVED TO ME ON THE BASIS OF SATISFACTORY EVIDENCE TO BE THE PERSON(S) WHOSE NAME(S) IS/ARE SUBSCRIBED TO THE WITHIN INSTRUMENT AND ACKNOWLEDGED TO ME THAT HE/SHE/THEY EXECUTED THE SAME IN HIS/HER/THEIR AUTHORIZED CAPACITY(IES), AND THAT BY HIS/HER/THEIR SIGNATURE(S) ON THE INSTRUMENT THE PERSON(S), OR THE ENTITY UPON BEHALF OF WHICH THE PERSON(S) ACTED, EXECUTED THE INSTRUMENT.

I CERTIFY UNDER PENALTY OF PERJURY UNDER THE LAWS OF THE STATE OF CALIFORNIA THAT THE FOREGOING PARAGRAPH IS TRUE AND CORRECT.

WITNESS MY HAND AND OFFICIAL SEAL.

Debra Beever

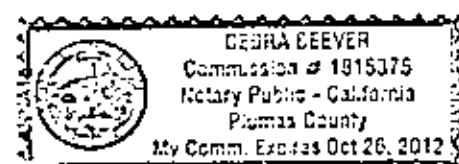

## SURVEYOR'S STATEMENT

THIS MAP WAS PREPARED BY ME OR UNDER MY DIRECTION AND IS BASED UPON A FIELD SURVEY IN CONFORMANCE WITH THE REQUIREMENTS OF THE SUBDIVISION MAP ACT AND LOCAL ORDINANCE AT THE REQUEST OF ROBERT F. SCHOENSEE IN JULY OF 2009. I HEREBY STATE THAT ALL THE MONUMENTS ARE OF THE CHARACTER AND OCCUPY THE POSITIONS INDICATED AND THAT THE MONUMENTS ARE SUFFICIENT TO ENABLE THE SURVEY TO BE RETRACED, AND THAT THIS FINAL MAP SUBSTANTIALLY CONFORMS TO THE CONDITIONALLY APPROVED TENTATIVE MAP.

DATED: April 9, 2010

Daniel B. Bastian  
DANIEL B. BASTIAN  
L.S. 7045  
LICENSE EXP. DATE: 12/31/10



## NOTES:

1. THE DESIGNATED WELL SITE, AS SHOWN WITHIN LOT 2 ON SHEET 4, THE ADDITIONAL INFORMATION MAP SHEET, WILL BE USED TO SUPPLY WATER TO LOT 1 AND TO LOT 2. EASEMENTS FOR THE WELL AND APPURTENANCES TO LOT 1 WILL BE GRANTED AT THE TIME OF CONVEYANCE OF LOT 1.
2. THE EXISTING WELL SITE, AS SHOWN WITHIN LOT 2 ON SHEET 4, THE ADDITIONAL INFORMATION MAP SHEET, WILL BE USED FOR WATER TO LOT 3. EASEMENTS FOR THE WELL AND APPURTENANCES WILL BE GRANTED AT THE TIME OF CONVEYANCE OF LOT 3.
3. THE EXISTING SEWAGE DISPOSAL SITE, AS SHOWN WITHIN LOT 3 ON SHEET 4, THE ADDITIONAL INFORMATION MAP SHEET, IS USED BY LOT 4. EASEMENTS FOR THE DISPOSAL SITE AND APPURTENANCES WILL BE GRANTED AT THE TIME OF CONVEYANCE OF LOT 4.

## COUNTY SURVEYOR'S STATEMENT

I HAVE EXAMINED THIS MAP AND FIND IT IS SUBSTANTIALLY THE SAME AS IT APPEARED ON THE TENTATIVE MAP AND ANY APPROVED ALTERATIONS THEREOF. ALL PROVISIONS OF THE SUBDIVISION MAP ACT AND ANY LOCAL ORDINANCES APPLICABLE AT THE TIME OF APPROVAL OF THE TENTATIVE MAP HAVE BEEN COMPLIED WITH AND I AM SATISFIED THAT THE MAP IS TECHNICALLY CORRECT.

DATED: May 10, 2012



R. Tom Hunter  
R. TOM HUNTER, R.C.E. 30515  
PLUMAS COUNTY SURVEYOR  
LICENSE EXP. DATE: 3/31/12

## COUNTY TAX COLLECTOR'S CERTIFICATE

I, SUSAN BRYANT GRANT, TAX COLLECTOR OF THE COUNTY OF PLUMAS, STATE OF CALIFORNIA, DO HEREBY CERTIFY THAT THERE ARE NO TAX LIENS AGAINST THE LOTS, AS SHOWN HEREON, FOR UNPAID STATE, COUNTY, MUNICIPAL, OR LOCAL TAXES OR SPECIAL ASSESSMENTS COLLECTED AS TAXES, EXCEPT TAXES OR ASSESSMENTS NOT YET PAYABLE. TAXES OR ASSESSMENTS WHICH ARE A LIEN BUT NOT YET PAYABLE, ARE ESTIMATED TO BE IN THE AMOUNT OF \$1775.04

DATED: 4/22/10

Susan T. Bryant Grant, T.C.  
SUSAN BRYANT GRANT  
PLUMAS COUNTY TAX COLLECTOR

## COUNTY BOARD CLERK'S CERTIFICATE

I, NANCY DeFORNO, CLERK TO THE PLUMAS COUNTY BOARD OF SUPERVISORS, HEREBY CERTIFY THAT THE HEREIN EMBODIED MAP WAS APPROVED BY SAID BOARD OF SUPERVISORS CONVENED IN A REGULAR MEETING UPON THE DAY OF May, 2010.

THE GRANT OF EASEMENT FOR THE COUNTY ROAD RIGHT OF WAY AND PUBLIC UTILITY EASEMENT, AS SHOWN ON THE MAP, IS ACCEPTED FOR THE USES NOTED.

DATED: 5/18/10

Nancy DeForno  
NANCY DeFORNO  
CLERK TO THE BOARD OF SUPERVISORS

## COUNTY RECORDER'S CERTIFICATE

FILED THIS 19 DAY OF May, 2010, AT 1:29 P.M. IN BOOK 10 OF MAPS, AT PAGE 101-104 AT THE REQUEST OF THE COUNTY SURVEYOR.

FEE: \$14.00

DOCUMENT NO. 2010-0002930

KATHLEEN WILLIAMS  
COUNTY RECORDER

BY: Laura L. Davis  
DEPUTY

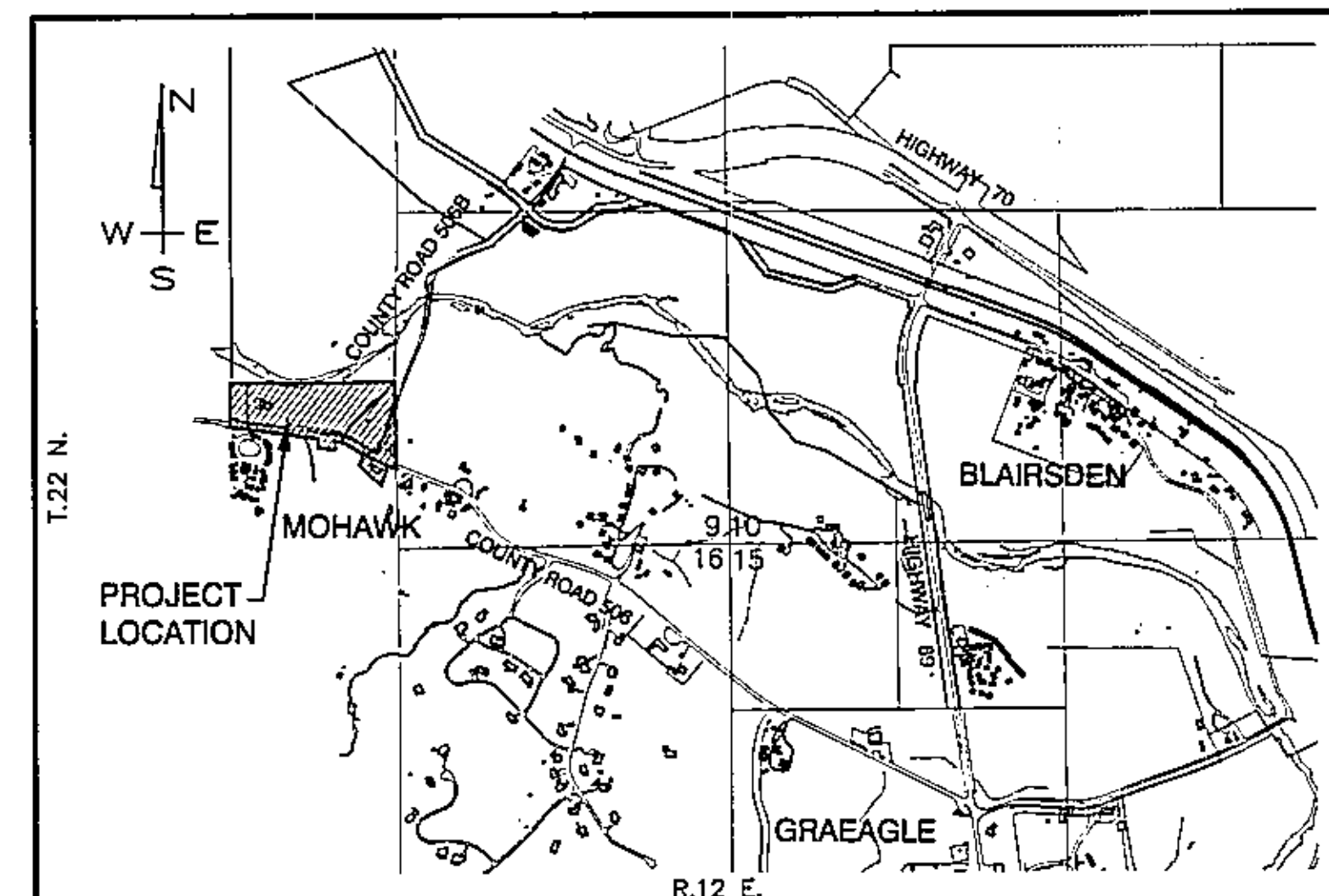

LOCATION MAP

SCALE: 1"=1320'±

## AREA TABULATION

LOTS 1-5 NET ACREAGE = 12.57 AC.  
ROAD EASEMENT ACREAGE = 2.95 AC.

TOTAL = 15.52 AC.

## SCHOENSEE SUBDIVISION

FOR  
ROBERT F. SCHOENSEE  
WITHIN A PORTION OF: SECTION 9, T. 22 N., R. 12 E., M.D.M.  
PLUMAS COUNTY, CALIFORNIA

PREPARED BY:  
BASTIAN ENGINEERING  
P.O. BOX 280  
GRAEAGLE, CALIFORNIA 96103  
L.S. 7045

AUGUST 2009

SHEET 1 OF 4