

**SURVEYOR'S CERTIFICATE**

THIS MAP WAS PREPARED BY ME OR UNDER MY DIRECTION AND IS BASED UPON RECORD DATA IN CONFORMANCE WITH THE REQUIREMENTS OF THE SUBDIVISION MAP ACT AT THE REQUEST OF EUREKA ENTERPRISES IN JANUARY, 1968. I HEREBY CERTIFY THAT IT CONFORMS TO THE APPROVED TENTATIVE MAP AND THE CONDITIONS OF APPROVAL THEREOF, AND THAT ALL PROVISIONS OF APPLICABLE STATE LAW AND LOCAL ORDINANCES HAVE BEEN COMPLIED WITH.

*Edward P. Norris*  
EDWARD P. NORRIS, L.S. 2846

**LEGEND**

FOUND 3/4" IRON PIPE MARKED RCE 7294  
SET 3/4" IRON PIPE MARKED RCE 7294

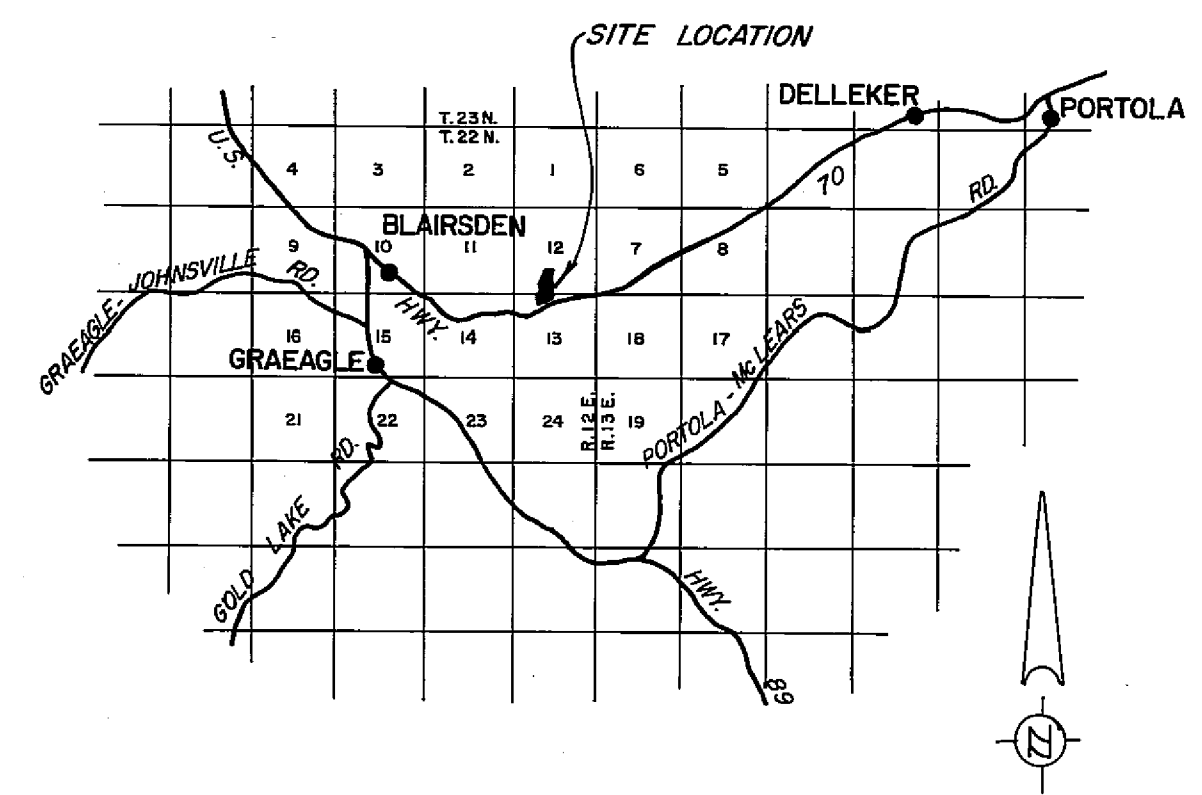

**LOCATION MAP**

SCALE: 1" = 2-1/4 Miles

**RECORDER'S CERTIFICATE**

FILED THIS 19<sup>th</sup> DAY OF March, 1968, AT 10:45 A.M.  
IN BOOK 2 OF PARCEL MAPS AT PAGE 17 AT THE REQUEST OF  
WALTER B. GRIMES. RECORDING NO. 3227

FEE 5<sup>00</sup>

*Ida Hogen Gronwald*  
COUNTY RECORDER

BY \_\_\_\_\_  
DEPUTY

**COUNTY ENGINEER'S CERTIFICATE**

THIS MAP HAS BEEN EXAMINED FOR CONFORMANCE WITH THE REQUIREMENTS OF SECTION 11575 OF THE SUBDIVISION MAP ACT THIS 19<sup>th</sup> DAY OF March, 1968.

*Dannell P. Payne* 8696  
LAWRENCE J. BROCK, R.C.E. 13528  
Asst. County Surveyor

**NOTES**

THE BASIS OF BEARING IS THE NORTH LINE OF LOT 9 OF MOHAWK VISTA SUBDIVISION, GIVEN AS S 88° 59' W ON THE FILED MAP THEREOF.

TOTAL ACREAGE 23.18 AC.

**PARCEL MAP**

LOT 8 OF MOHAWK VISTA SUBDIVISION  
PLUMAS COUNTY, CALIFORNIA

MAP OF THE LANDS OF  
**EUREKA ENTERPRISES**

SCALE: 1" = 200' JANUARY, 1968

**G** WALTER B. **A**  
RIMES ASSOC.  
CIVIL ENGINEERS & LAND SURVEYORS  
1356 MANGROVE AVENUE, CHICO, CALIFORNIA