

NOTES

- Indicates found 3/4" iron pipe marked L.S. 2843
- Indicates set 3/4" iron pipe marked L.S. 2843

The basis of bearings is the Parcel Map, filed March 28, 1966, in Volume 1 of Parcel Maps, at page 15.

SURVEYORS CERTIFICATE

This map was prepared by me or under my direction and was compiled from record data and is based upon a field survey in conformance with the requirements of the SUBDIVISION MAP ACT at the request of Mr. E.A. McNALLY in March, 1968. I hereby certify that it conforms to the approved Tentative Map and the conditions of approval thereof: That all provisions of applicable State Law and Local Ordinance have been complied with.

John W. Hamby
John W. Hamby L.S. 2843

COUNTY ENGINEERS CERTIFICATE

This Map has been examined this 25th day of April, 1968, for conformance with the requirements of Section 11575 of the SUBDIVISION MAP ACT.

Darrell P. Payne RCE 8596
Lawrence J. Brock - R.C.E. 13528

RECORDERS CERTIFICATE

Filed this 25th day of April, 1968, at 10:30 A.M. in Book 2 of PARCEL MAPS at Page 22, at the request of Darrell P. Payne

Lee Hagan Trautman
County Recorder
Deputy

SERIAL NO. 3655

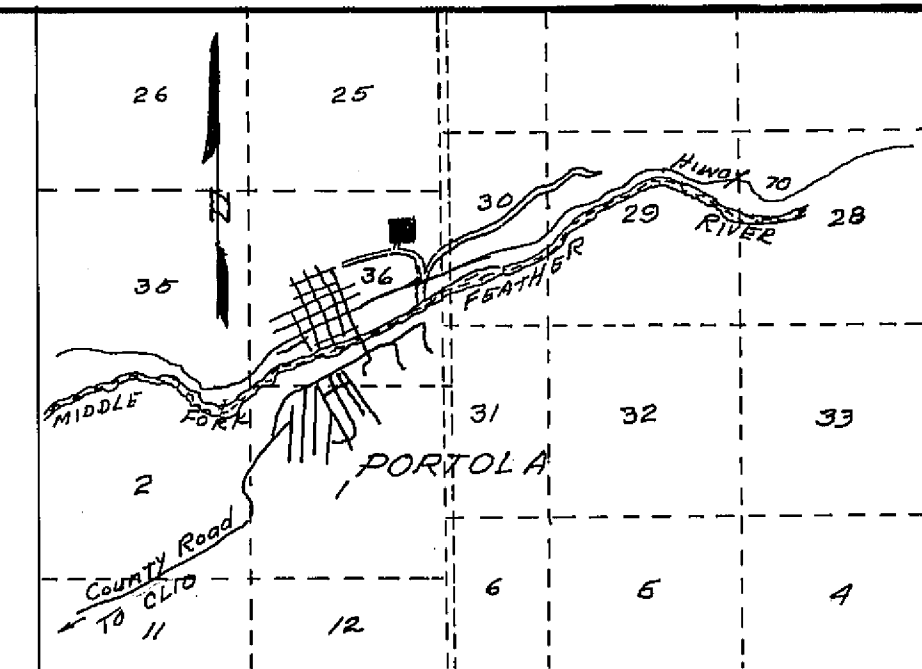

LOCATION MAP
SCALE 1" = 5280'

PARCEL MAP

PORTION OF THE NE 1/4 OF SECTION 36, T23N R13E, MDB&M.
BEING PARCEL 3 OF PARCEL MAP FILED IN
VOLUME 1 OF PARCEL MAPS AT PAGE 15.

PLUMAS COUNTY

CALIFORNIA

FOR
MR. E.A. McNALLY - Portola

Scale 1" = 100'

March, 1968

by John W. Hamby L.S. 2843
Paradise, Calif.