

- LEGEND**
- Found monuments as indicated
  - o Set monuments as indicated
  - Fd. Found
  - I.P. & T. Iron Pipe and Tag
  - R/W Right-of-Way
  - P Property Line
  - Md. Mound
  - Rec. Record (from deed, Record of Survey, Parcel Map, etc.)
  - Meas. Measured
  - R.C.E. Registered Civil Engineer

**NOTE**

Tentative Map approved by Plumas County Planning Commission October 28, 1968.



**SURVEYOR'S CERTIFICATE**

This map was prepared by me or under my direction (and is based upon a field survey) in conformance with the requirements of the Subdivision Map Act at the request of Arol King, October 1, 1968. I hereby certify that it conforms to the approved tentative map and the conditions of approval thereof; that all provisions of applicable state law and local ordinances have been complied with.

*John C. Simpson*  
John C. Simpson  
R.C.E. 11173

**COUNTY SURVEYOR'S CERTIFICATE**

This map has been examined this 30<sup>th</sup> day of OCTOBER, 1968, for conformance with the requirements of Section 11575 of the Subdivision Map Act.

*Darrell P. Payne* RCE 8596  
Plumas County Surveyor

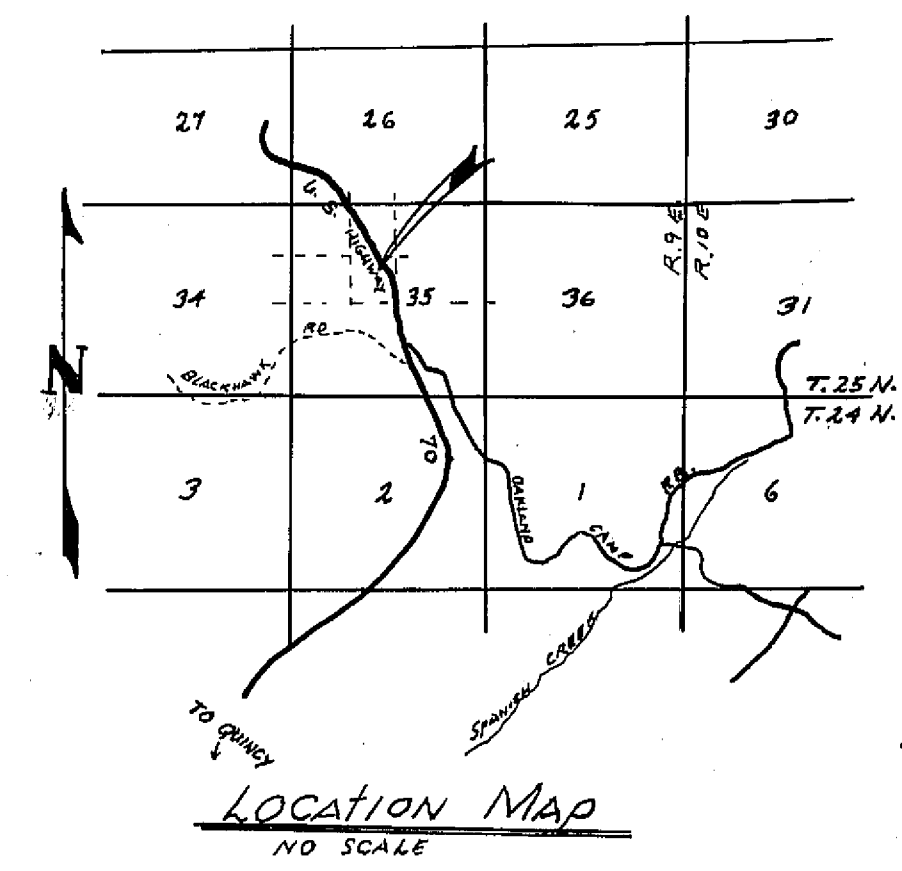

**PARCEL MAP**  
OF  
SUBDIVISION OF ONE PARCEL  
A PORTION OF THE LANDS OF  
**AROL KING**  
RECORD OWNER  
IN  
PLUMAS COUNTY-CALIFORNIA

JOHN C. SIMPSON, P.E.  
CIVIL ENGINEER  
QUINCY-CALIFORNIA

**RECORDER'S CERTIFICATE**

Filed this 31<sup>st</sup> day of October 1968, at 2:05 P.M. in Book 2 of Parcel Maps at Page 42 at the request of John C. Simpson.

*John C. Simpson*  
Fee \$5.00  
Wile No. 16a Hogan Gronvold  
Plumas County Recorder