

NOTES

THE BASIS OF BEARING IS THE NORTH LINE OF PARCEL 6 AS SHOWN ON THE MAP ENTITLED "AMENDED RECORD OF SURVEY MAP" FILED DECEMBER 26, 1967, IN BOOK 3 OF RECORD OF SURVEY AT PAGE 108, RECORDING NO. 2695 IN THE OFFICIAL RECORDS OF COUNTY OF PLUMAS, STATE OF CALIFORNIA, GIVEN AS N 89° 36' 06" W.

TOTAL ACREAGE 40.00 ac.
BEING ALL OF PARCEL 6 OF THAT CERTAIN AMENDED RECORD OF SURVEY MAP FILED DECEMBER 26, 1967, IN BOOK 3 OF RECORD OF SURVEYS AT PAGE 108, OFFICIAL RECORDS OF PLUMAS COUNTY.

SURVEYOR'S CERTIFICATE

THIS MAP WAS PREPARED BY ME OR UNDER MY DIRECTION AND IS BASED UPON A FIELD SURVEY IN CONFORMANCE WITH THE REQUIREMENTS OF THE SUBDIVISION MAP ACT AT THE REQUEST OF D.R. KLEINHANS IN AUGUST, 1969. I HEREBY CERTIFY THAT IT CONFORMS TO THE APPROVED TENTATIVE MAP AND THE CONDITIONS OF APPROVAL THEREOF, AND THAT ALL PROVISIONS OF APPLICABLE STATE LAW AND LOCAL ORDINANCES HAVE BEEN COMPLIED WITH.

Max L. Albert
MAX L. ALBERT, L.S. 3336

RECORDERS CERTIFICATE

FILED FOR RECORD THIS 26th DAY OF November, 1969, AT 3:05 P.M.
IN BOOK 2 OF PARCEL MAPS AT PAGE 103 AT THE REQUEST OF
WALTER B. GRIMES. Recording No. 2836
Feb 5th
W. Hogan Gronwald
COUNTY RECORDER

COUNTY ENGINEERS CERTIFICATE

THIS MAP HAS BEEN EXAMINED FOR CONFORMANCE WITH THE REQUIREMENTS OF SECTION 11575 OF THE SUBDIVISION MAP ACT THIS 26th DAY OF November, 1969.

Darrell P. Payne
DARRELL P. PAYNE, R.C.E. 8596

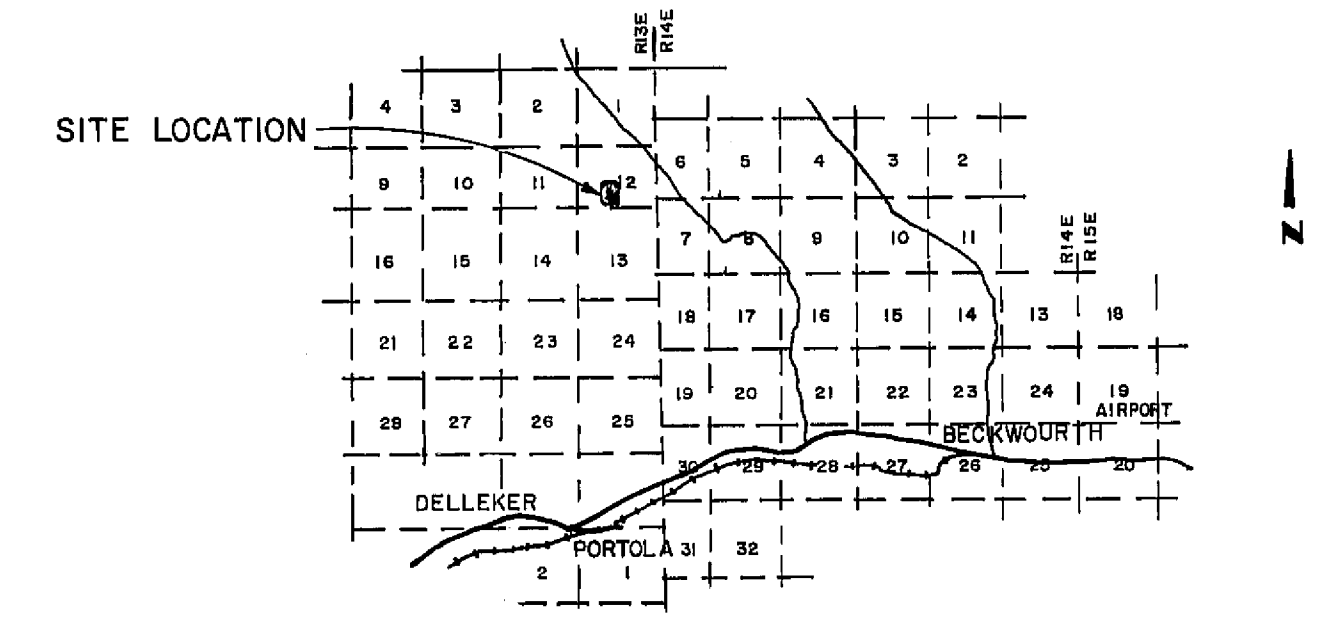

LOCATION MAP
SCALE: 1" = 2.5 MI.

LEGEND

- SET 3/4" IRON PIPE TAGGED L.S. 3336
- FOUND 3/4" IRON PIPE TAGGED L.S. 2846

PARCEL MAP

A PORTION OF SECTION 12 T.23N., R.13E., M.D.B. & M.

PLUMAS COUNTY

CALIFORNIA

MAP OF THE LANDS OF
PORTOLA LAND CO.-LIMITED PARTNERSHIP
1021 LINCOLN BLVD., SANTA MONICA, CALIFORNIA

SCALE 1" = 200'

AUGUST, 1969

G. WALTER B. RIMES AND ASSOC.
CIVIL ENGINEERS & LAND SURVEYORS
1356 MANGROVE AVENUE, CHICO, CALIFORNIA