

COUNTY ENGINEERS CERTIFICATE
 THIS MAP HAS BEEN EXAMINED FOR CONFORMANCE WITH THE REQUIREMENTS OF SECTION 11575 OF THE SUBDIVISION MAP ACT THIS 21ST DAY OF October 1970.

Darrell P. Payne
 DARRELL P. PAYNE R.C.E. 8596

RECORDERS CERTIFICATE
 FILED THIS 22ND DAY OF Oct., 1970 AT 9:52 A.M. IN BOOK 3 OF PARCEL MAPS AT PAGE 24 AT THE REQUEST OF GERALD C. HENDERSON.

RECORDING NUMBER 2645
John Vogan Gronwall
 COUNTY RECORDER

PARCEL MAP
 A PORTION OF SECTION 14
 T.22N., R.12E., M.D., B. & M.
 SURVEY OF THE LAND OF E. VOESTER

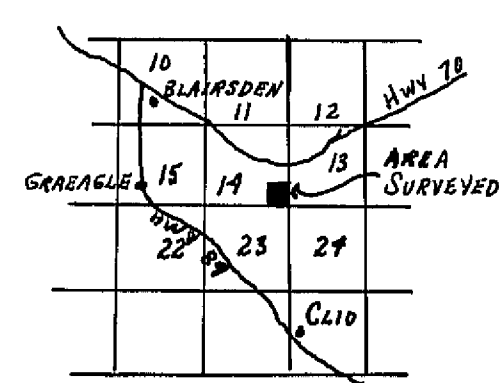

SURVEYORS CERTIFICATE
 THIS MAP WAS PREPARED BY ME OR UNDER MY DIRECTION AND IS BASED UPON A FIELD SURVEY IN CONFORMANCE WITH THE REQUIREMENTS OF THE SUBDIVISION MAP ACT AT THE REQUEST OF E. VOESTER APRIL 1970. I HEREBY CERTIFY THAT IT CONFORMS TO THE APPROVED TENTATIVE MAP AND THE CONDITIONS OF APPROVAL THEREOF, AND THAT ALL PROVISIONS OF APPLICABLE STATE LAW AND LOCAL ORDINANCES HAVE BEEN COMPLIED WITH.

Gerald C. Henderson
 GERALD C. HENDERSON L.S. 3297
 P.O. Box 13
 PORTOLA, CALIFORNIA 96122

LEGEND
 FND 3/4" IP AS SHOWN ●
 SET 3/4" IP TAGGED LS 3297 ○
 SEWER SETBACK LINE

SCALE 1" = 100'

NOTE
 BASIS OF BEARING IS THE EAST LINE OF THIS MAP AS SHOWN ON RECORD OF SURVEY, BOOK 3, PAGE 72, AND BOOK 3, PAGE 89. FOR CONTINUATION OF ROAD EASEMENT SEE OFFICIAL RECORDS BOOK 198 PAGE 252, AND BOOK 198 PAGE 254. THESE EASEMENTS CONTINUE TO A ROAD EASEMENT AS SHOWN ON PARCEL MAP BOOK 3 PAGE 10, THERE BY CONNECTING TO EXISTING PUBLIC ROAD EASEMENTS.