

E. VOESTER
3 RS 89
3 PM 24

J. CLAYTON
3 RS 84

D. PARIS
3 RS 148

- ROADWAY TRAVERSE
- A. S 18° 13' E 61.96'
 - B. S 71° 14' E 109.00'
 - C. S 34° 18' E 143.00'
 - D. S 12° 34' W 246.00'
 - E. S 02° 14' W 217.00'
 - F. S 70° 46' E 109.00'
 - G. S 89° 19' E 135.61'

LEGEND
 FND 3/4" OR 1/2" IP AS SHOWN ABOVE ○
 SET 3/4" OR 1/2" IP TAGGED L.S. 3297 ●

NOTE
 BASIS OF BEARING IS THE SOUTH BOUNDARY LINE
 OF SECTION 14 AS SHOWN ON THAT CERTAIN MAP
 FILED IN BOOK 3 OF PARCEL MAPS AT PAGE 24.

SCALE 1" = 200'

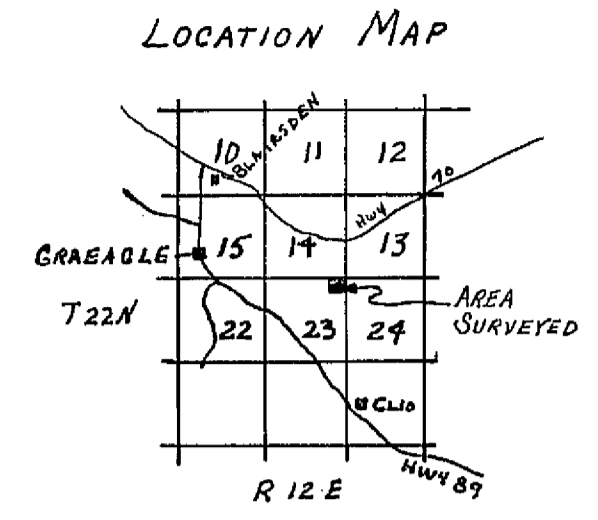

SURVEYOR'S CERTIFICATE

THIS MAP WAS PREPARED BY ME OR UNDER MY DIRECTION AND IS BASED UPON A FIELD SURVEY IN CONFORMANCE WITH THE REQUIREMENTS OF THE SUBDIVISION MAP ACT AT THE REQUEST OF JOHN CHASE IN MARCH OF 1971. I HEREBY CERTIFY THAT IT CONFORMS TO THE APPROVED TENTATIVE MAP AND THE CONDITIONS OF APPROVAL THEREOF, AND THAT ALL PROVISIONS OF APPLICABLE STATE LAW AND LOCAL ORDINANCES HAVE BEEN COMPLIED WITH.

Gerald C. Henderson
 GERALD C. HENDERSON LS 3297

COUNTY SURVEYOR'S CERTIFICATE

THIS MAP HAS BEEN EXAMINED FOR CONFORMANCE WITH THE REQUIREMENTS OF SECTION 11575 OF THE SUBDIVISION MAP ACT THIS 17th DAY OF August 1971.

Darrell P. Payne
 DARRELL P. PAYNE RCE 8596

COUNTY RECORDER'S CERTIFICATE

FILED THIS 17th DAY OF August, 1971 AT 2:51 P.M., IN BOOK 3 OF PARCEL MAPS AT PAGE 72, AT THE REQUEST OF GERALD C. HENDERSON.

RECORDING No. 885
 FEE. 5.00

Dorothy New Markey
 COUNTY RECORDER

PARCEL MAP
 A PORTION OF SECTION 23
 T.22.N, R.12.E., M.D. B. & M.
 PLUMAS COUNTY, CALIFORNIA

A SURVEY OF THE LAND OF
 JOHN CHASE

GERALD C. HENDERSON
 LICENSED LAND SURVEYOR
 P.O. Box 13, PORTOLA, CALIFORNIA