

PARCEL MAP  
BOOK 4-PAGE 28

EXIST 60' EASEMENT  
BOOK 3 OF MAPS AT PAGE 112

S. 72° 05' 00" E. 178.66' (Rec. & Meas)

PARCEL-1  
(12,103.29 ± Sq. Ft.)

N. 76° 21' 48" W. 174.93'

PARCEL-2  
(12,103.29 ± Sq. Ft.)

EXIST 10' EASEMENT  
BOOK 3 OF MAPS - P. 112

EXIST 60' EASEMENT  
(O.R. BK. 237 P. 102)

N. 80° 48' 13" W. 172.21' (Rec. & Meas)

7-B  
(P.M. BK. 4 - P. 108)

BEING ALL OF PARCEL 7A FILED IN  
BOOK 4 OF PARCEL MAPS - PAGE 108

STONE, et. al.  
(O.R. 189 - p. 57)  
RECORD OF SURVEY  
(BOOK 3 - PAGE 22)

BASIS OF BEARINGS  
NORTH 156.12' (Rec. & Meas)

78.06'

78.06'

64.39'  
SOUTH 128.68' (Rec. & Meas)

ERIC LEONHARDT

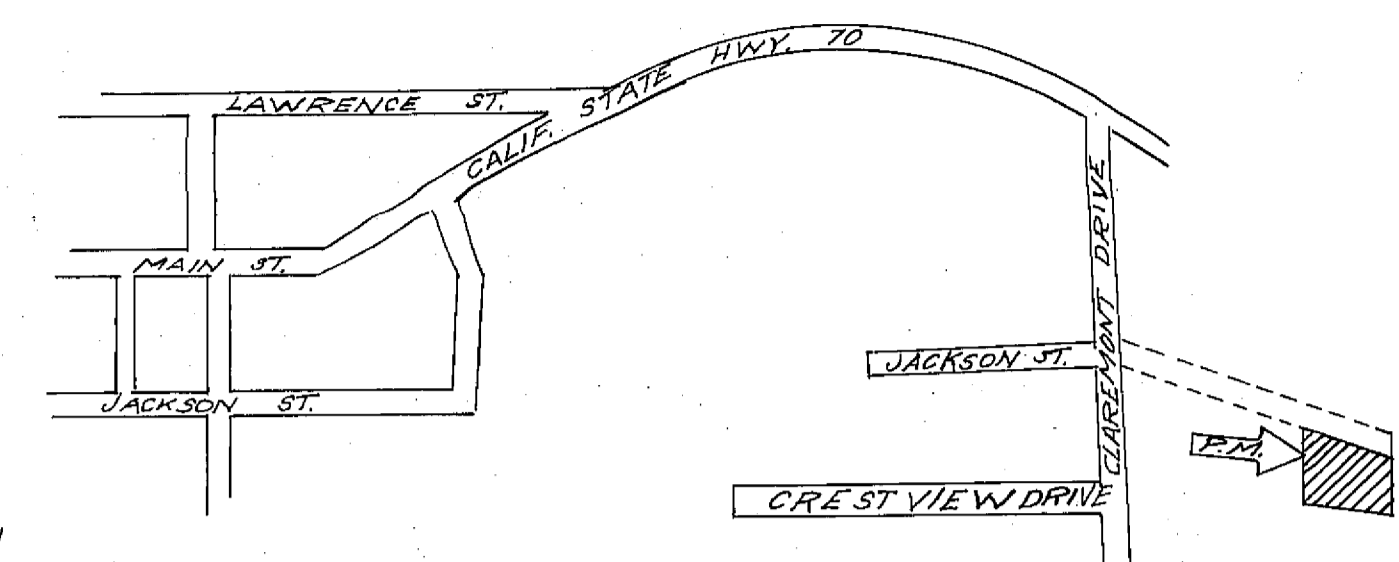

LOCATION MAP  
NO SCALE

LEGEND

- Found 1/2" Steel Pin with plastic cap stamped R.O.E. 11173
- Set 1/2" Steel Pin with plastic cap stamped R.O.E. 11173
- Rec. Record (from deed, record map, etc.)
- Meas. Measured
- P.M. Parcel Map
- O.R. Official Records, Plumas County records
- Bk. Book
- p. Page

NOTE

Tentative Parcel Map approved by Plumas County  
Zoning Administrator October 17, 1974.

COUNTY TAX COLLECTOR'S CERTIFICATE

I, the undersigned, County Tax Collector of the County of Plumas, State of California, do hereby certify that there are no tax liens against Parcels 1 and 2 as shown hereon or unpaid state, county, municipal or local taxes, or spl. assessments collected as taxes, except taxes or assessments not yet payable. Taxes or assessments which are a lien but not yet payable are estimated to be in the amount of None.

Douglas S. Redstrake  
Douglas S. Redstrake  
Plumas County Tax Collector

SURVEYOR'S CERTIFICATE

This map was prepared by me or under my direction (and is based upon a field survey) in conformance with the Subdivision Map Act at the request of Richard P. DeMars, October 18, 1974. I hereby certify that it conforms to the approved tentative map and the conditions of approval thereof; that all provisions of applicable state law and local ordinances have been complied with.

John C. Simpson  
John C. Simpson  
R.O.E. 11173



PARCEL MAP  
OF  
SUBDIVISION OF TWO PARCELS

WITHIN  
NW1/4NW1/4, SEC. 24, T.24N, R.9E, M.D.M.  
PLUMAS COUNTY, CALIFORNIA  
RECORD OWNERS  
RICHARD P. AND KAREN L. DEMARS

JOHN C. SIMPSON, P.E.  
CIVIL ENGINEER  
P.O. BOX 719  
QUINCY, CALIFORNIA

RECORDER'S CERTIFICATE

Filed this 8<sup>th</sup> day of November 1974,  
at 11:45 A.M. in Book 4 of Parcel  
Maps at Page 118 at the request of  
John C. Simpson.  
Donna New Mashey  
Plumas County Recorder

COUNTY SURVEYOR'S CERTIFICATE

This map has been examined this 7<sup>th</sup> day of November,  
1974, for conformance with the requirements of Section  
11575 of the Subdivision Map Act.  
Larry A. Fites  
Plumas County Surveyor,  
Larry A. Fites, R.O.E. 13225

Fee \$5.00  
File No. 3556