

S.W. Corner of the S.E. 1/4 of the N.W. 1/4 of Section 17.

LEGEND

- Indicates found 3/4" iron pipe marked L.S. 2846
- Indicates set 3/4" iron pipe marked L.S. 2843.

NOTES

The basis of bearings for this PARCEL MAP is the Record of Survey Map of the land of Geraldine Hixson, filed July 25, 1966, in Book 3 of RECORD OF SURVEYS, at Page 71.

This parcel is a subdivision of Parcel 1 as shown on map filed in book 3 of Parcel Maps at Page 67.

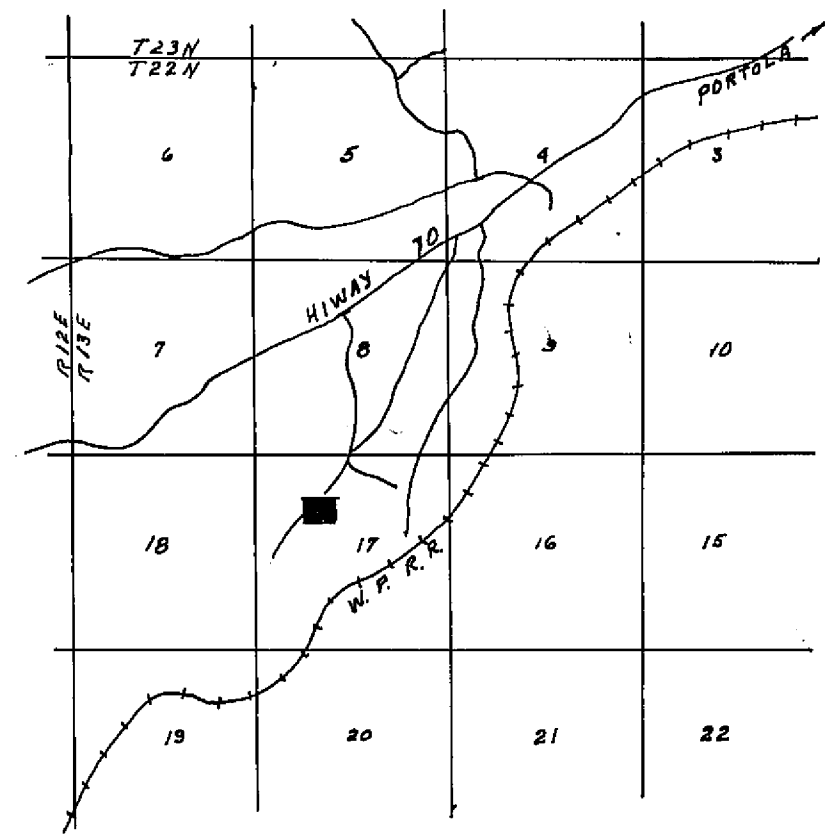

LOCATION MAP

SURVEYOR'S CERTIFICATE

This map was prepared by me or under my direction and was compiled from record data and is based upon a field survey in conformance with the requirements of the SUBDIVISION MAP ACT at the request of HAROLD STOY on August 21, 1972, I hereby certify that it conforms to the approved tentative map and the conditions of approval thereof. That all provisions of applicable state law and local ordinances have been complied with.

John W. Hamby
John W. Hamby - L.S. 2843
Licensed Land Surveyor

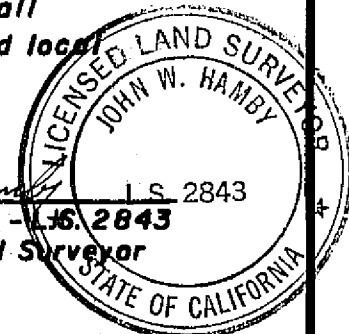

COUNTY ENGINEER'S CERTIFICATE

This map has been examined this 17th day of February, 1973, for conformance with the requirements of Section 11575 of the SUBDIVISION MAP ACT.

Darrell P. Payne
Darrell P. Payne - R.C.E. - 8596
County Engineer - Surveyor
PLUMAS County

RECORDER'S CERTIFICATE

Filed this 27th day of February, 1973, at 3:30 p.m. in Book 4 of PARCEL MAPS at page 22 at the request of County Engineer.

Dorothy New Masley
Dorothy New Masley
County Recorder
County of Plumas

SCALE 1" = 100'

by Deputy
SERIAL No. 3780

TAX COLLECTORS CERTIFICATE

I, the undersigned, County Tax Collector of the County of Plumas, State of California, do hereby certify that there are no tax liens against Parcels One through Four inclusive as shown hereon, or unpaid State, County, municipal, or local taxes, or special assessments collected as taxes, except taxes or assessments not yet payable. Taxes or assessments which are a lien but not yet payable are estimated to be in the amount of NONE.

Douglas S. Redstreake
DOUGLAS S. REDSTREAKE
Plumas County Tax Collector

PARCEL MAP

- FOR -

HAROLD STOY

The NW 1/4 of the S.E. 1/4 of the NW 1/4 of Section 17,
T 22 N R 13 E M.D.B. & M.
PLUMAS COUNTY CALIFORNIA

JOHN W. HAMBY L.S. 2843 LICENSED LAND SURVEYOR
651 PEARSON ROAD PARADISE, CALIFORNIA
AUGUST 21 1972

4/PM 22