

BASIS OF BEARINGS
 Book 3 of PARCEL MAPS at page
 10 of the Official Records of PLUMAS
 COUNTY.

— LEGEND —

- ◆ Found 1/4 corner as shown on Parcel Map
 filed in Book 3, Page 10, Plumas County
 Official Records.
- Set 3/4" rebar tagged R.C.E. 16895
- Theoretical Points
- ⊙ Found 3/4" iron pipe tagged L.S. 3336

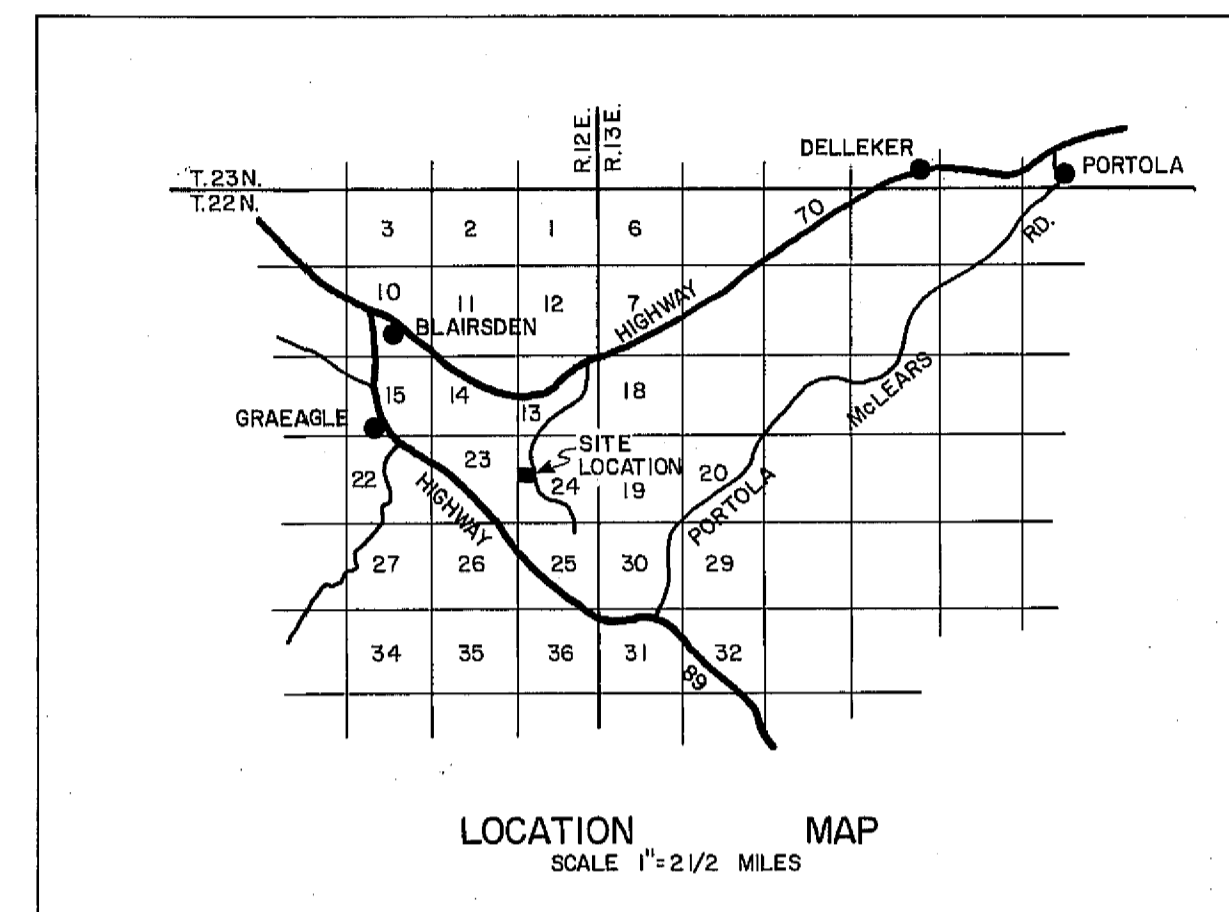

SURVEYOR'S CERTIFICATE

This map was prepared by me or under my direction and is based upon a field survey in conformance with the requirements of the Subdivision Map Act at the request of WAYNE D. and MARY J. PETERSON in September, 1975. I hereby certify that it conforms to the approved Tentative Map and the conditions of approval thereof, and that all provisions of applicable state law and local ordinances have been complied with.

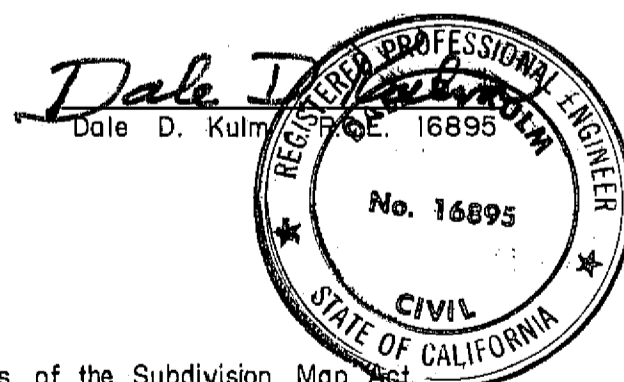

COUNTY ENGINEER'S CERTIFICATE

This map conforms with the requirements of the Subdivision Map Act and Local Ordinances.

Dated: 4-22-, 1976

Lang A. Fite
 Plumas County Engineer

OWNER'S CERTIFICATE

We hereby certify that we are the owners of the land shown on this Parcel Map and consent to the preparation and recording of this map, and that we are the only persons whose consent is required to pass title to said lands.

Wayne D. Peterson *Mary J. Peterson*
 Wayne D. Peterson Mary J. Peterson

**STATE OF NEVADA
 COUNTY OF WASHOE**

On 9-29-75, 1975, before me, the undersigned, a Notary Public in and for said County and State, personally appeared Wayne D. and Mary J. Peterson, known to me to be the persons whose names are subscribed to the within instrument and acknowledged that they executed the same.

Annnette S. Micheline

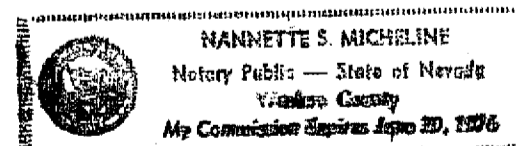

NOTE: No building permits will be approved for these parcels until the main access to Highway 70 is improved to County major standard and provisions made for maintenance.

RECORDER'S CERTIFICATE

Filed this 22ND day of APRIL, 1976, at 12:00 P.M. in Book 5 of PARCEL MAPS at page 74 at the request of WAYNE D. and MARY J. PETERSON.

RECORDING NO.: 5700 FEE: \$5.00

Dorothy Ann Marley
 County Recorder
 by *Kathy Splander*

COUNTY TAX COLLECTOR'S CERTIFICATE

I, the undersigned, County Tax Collector of the County of Plumas, State of California, do hereby certify that there are no tax liens against parcels as shown hereon or unpaid state, county, municipal or local taxes, or spl. assessments collected as taxes, except taxes or assessments not yet payable. Taxes or assessments which are a lien but not yet payable, are estimated to be in the amount of \$135.00.

Douglas S. Redstreak
 Douglas S. Redstreak
 Plumas County Tax Collector

by *Lois Alexander Deputy*
 PARCEL MAP
 FOR

WAYNE D. & MARY J. PETERSON
 THE S.W. 1/4 OF THE S.W. 1/4 OF THE N.W. 1/4,
 OF SECTION 24, T.22N., R.12E., M.D.B.&M.
 PLUMAS COUNTY, CALIFORNIA

Scale: 1" = 100' September, 1975

DALE D. KULM, R.C.E. 16895

Sheet 1 of 1

Doc of Esmt 252 OR 755