

NOTES

BASIS OF BEARING IS TAKEN FROM THAT CERTAIN MAP FILED IN BOOK 3 OF RECORD OF SURVEYS AT PAGE 146, PLUMAS COUNTY RECORDS.

CERTIFICATE OF OWNER'S CONSENT TO PREPARATION AND RECORDING OF THIS MAP IS ON FILE IN THE COUNTY ENGINEER'S OFFICE.

THE BUILDING FLOOR ELEVATION FOR ANY HABITABLE STRUCTURE FOR PARCEL "M" BE A MINIMUM OF 3 FEET ABOVE THE NATURAL GROUND TO PRECLUDE INUNDATION DURING PERIODS OF HIGH WATER.

LEGEND

SECTION CORNER OR 1/4 CORNER AS DESCRIBED HEREON COMPUTED CORNER LOCATION SET 1/2" IP TAGGED LS 3297 WITNESS CORNER LEACH SETBACK LINE 240 O.R. 750

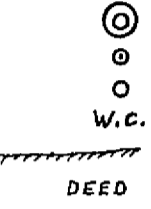

COUNTY TAX COLLECTOR'S CERTIFICATE

I, TAX COLLECTOR OF THE COUNTY OF PLUMAS, STATE OF CALIFORNIA, DO HEREBY CERTIFY THAT THERE ARE NO TAX LIENS AGAINST THE PARCELS, AS SHOWN HEREON, FOR UNPAID COUNTY, MUNICIPAL, OR LOCAL TAXES OR SPECIAL ASSESSMENTS COLLECTED AS TAXES EXCEPT TAXES OR ASSESSMENTS NOT YET PAYABLE. TAXES OR ASSESSMENTS WHICH ARE A LIEN BUT NOT YET PAYABLE ARE ESTIMATED TO BE IN THE AMOUNT OF \$580.00

Douglas S. Redstrake DOUGLAS S. REDSTRAKE PLUMAS COUNTY TAX COLLECTOR

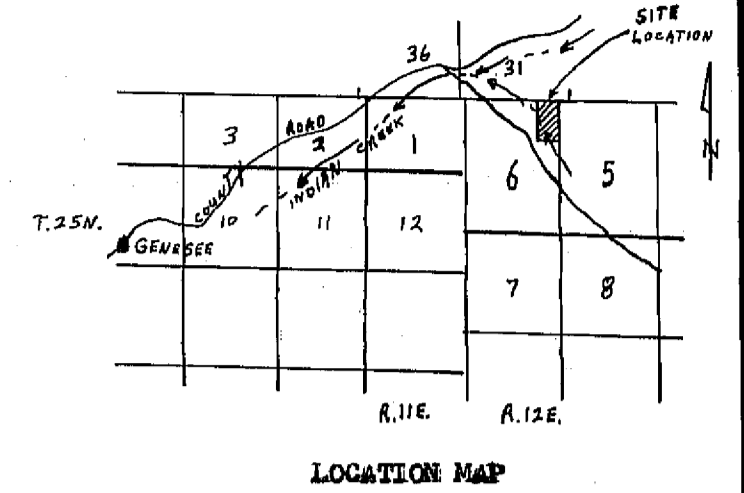

SURVEYOR'S CERTIFICATE

THIS MAP WAS PREPARED BY ME OR UNDER MY DIRECTION AND IS BASED UPON A FIELD SURVEY IN CONFORMANCE WITH THE REQUIREMENTS OF THE SUBDIVISION MAP ACT AT THE REQUEST OF J. LINDSAY IN NOVEMBER 1975. I HEREBY CERTIFY THAT IT CONFORMS TO THE APPROVED TENTATIVE MAP AND THE CONDITIONS OF APPROVAL THEREOF.

Gerald C. Henderson GERALD C. HENDERSON LS 3297

COUNTY SURVEYOR'S CERTIFICATE

THIS MAP CONFORMS WITH THE REQUIREMENTS OF THE SUBDIVISION MAP ACT AND LOCAL ORDINANCE.

DATED: 4-29-76

Larry A. Fites LARRY A. FITES RCE 13225 COUNTY ENGINEER

RECORDER'S CERTIFICATE

FILED THIS 29th DAY OF APRIL, 1976, AT 3:40 P.M. IN BOOK 5 OF PARCEL MAPS AT PAGE 76, AT THE REQUEST OF GERALD G. HENDERSON.

FEE: \$5.00

FILE NO. 5848

Dorothy Jean Marley DOBOTHY JEAN MARLEY by Kelly Japlander COUNTY RECORDER

PARCEL MAP

OF A SUBDIVISION INTO FOUR PARTS FOR JOHN LINDSAY ETAL NOVEMBER 1975 PORTION OF SECTION 6, T. 25N., R. 12E., M.D.M. PLUMAS COUNTY, CALIFORNIA

GERALD G. HENDERSON LICENSED LAND SURVEYOR P. O. BOX 13 PORTOLA, CALIFORNIA

Dec of Easement 253 OR 211 Dec of Rest RE-2.5 253 OR 212