

SCALE 1" = 100'

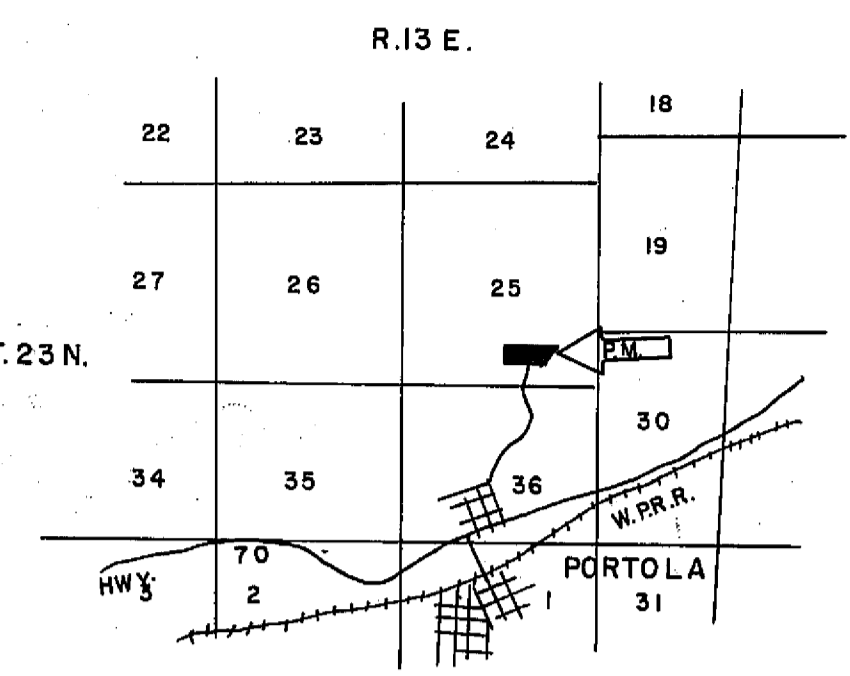

LOCATION MAP
NO SCALE

LEGEND

- Found 1/2" steel pin with plastic cap stamped L.S. 3297 except as noted
- Set 1/2" steel pin with plastic cap stamped L.S. 3297
- Rec. Meas. Record (From deed, Record Map, etc.)
- O.R. Measured
- BK. Official Record
- P. Book
- R/S Page
- Ac. Record of Survey
- I.P. Acre
- L.S. Iron Pipe
- R.C.E. Land Surveyor
- Registered Civil Engineer

NOTE

Tentative Parcel Map approved by Plumas County Zoning Administrator July 27, 1976.

Easement No. 1 to be for roadway and utility purposes for the benefit of Parcel 1, 2, and 3 hereon. A declaration of easement will be recorded concurrently with the filing of this map.

Easement No. 2 to be for roadway and utility purposes for the benefit of Parcel 1 and 2 hereon.

Easement No. 3 to be a public utility easement for an electric line.

NOTE
(OWNER'S CERTIFICATE)

Prior to the filing of this map a letter, signed by the owners of the land shown hereon, was filed with the County Engineer certifying that the signers are the owners of the lands shown on said map and that they are the only persons whose consent is required to pass title to said lands.

NOTE
LEACH EXCLUSION AREAS
50' FROM ALL SEASONAL DRAINAGE CHANNELS
100' FROM ALL WELLS
AND ALL MEADOW AREA

BEING ALL OF PARCEL 1 OF PARCEL MAP BOOK 5 OF PARCEL MAPS AT PAGE 95 AND ALSO A PORTION RECORD OF SURVEY, BOOK 3 OF RECORD OF SURVEYS AT PAGE 88

COUNTY ENGINEER'S CERTIFICATE

This map conforms with the requirements of the Subdivision Map Act and local ordinance.

Dated: 8-25-76

Larry A. Fites
Larry A. Fites, R.C.E. 13225
Plumas County Engineer

SURVEYOR'S CERTIFICATE

This map was prepared by me or under my direction and is based upon a field survey in conformance with the Subdivision Map Act at the request of Karl H. and Barbara Baumann on July 2, 1976. I, hereby certify that it conforms to the approved tentative map and the conditions of approval thereof.

Gerald C. Henderson
Gerald C. Henderson, L.S. 3297
SIERRA SURVEYING
LAND SURVEYOR
P. O. BOX 1199
QUINCY, CALIFORNIA

COUNTY TAX COLLECTOR'S CERTIFICATE

I, Tax Collector of the County of Plumas, State of California, do hereby certify that there are no liens against the Parcels as shown hereon for unpaid county, municipal, or local taxes, except taxes or assessments not yet payable. Taxes or assessments which are a lien but not yet payable are estimated to be in the amount of \$None

Douglas S. Redstreske
Douglas S. Redstreske
Plumas County Tax Collector

RECORDER'S CERTIFICATE

Filed this 25th day of August, 1976, at 2:50 M. in Book 5 of Parcel Maps at Page 100 at the request of Gerald C. Henderson.

Dorothy Neer Marley
Dorothy Neer Marley
Plumas County Recorder

Fee \$5.00
File No. 1389

PARCEL MAP
OF
SUBDIVISION INTO FOUR PARCELS
FOR
KARL H. AND BARBARA L. BAUMANN
WITHIN
1/2 SE 1/4, SEC. 25, T.23N., R.13E., M.D.M.
PLUMAS COUNTY, CALIFORNIA

Dec. of Easements 257 OR 697