

## NOTES

- CERTIFICATE OF OWNER'S CONSENT TO THE PREPARATION AND RECORDATION OF THIS MAP, DATED 9-12-79, IS ON FILE IN THE OFFICE OF THE COUNTY ENGINEER.
- EASEMENT NO. 1 IS A 40' WIDE PRIVATE ROADWAY EASEMENT FOR THE BENEFIT OF PARCEL 2.
- THE BASIS OF BEARING FOR THIS MAP IS THE EAST LINE OF PARCEL 1 OF 5 PM 141.

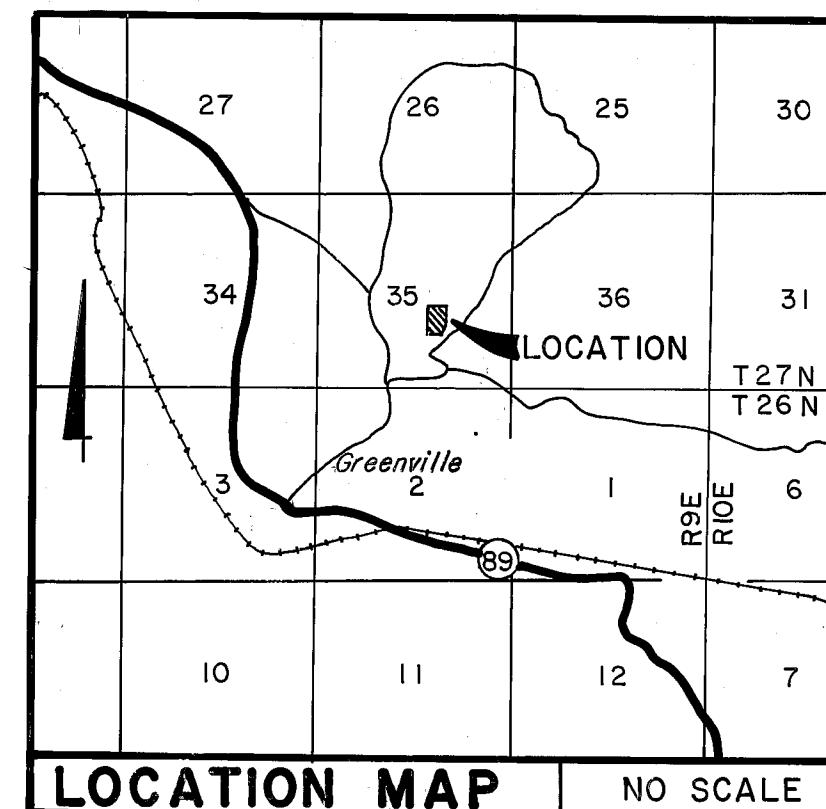

## ENGINEER'S CERTIFICATE

THIS MAP WAS PREPARED BY ME OR UNDER MY DIRECTION AND IS BASED UPON A FIELD SURVEY IN CONFORMANCE WITH THE REQUIREMENTS OF THE SUBDIVISION MAP ACT AND LOCAL ORDINANCE AT THE REQUEST OF MARY MURROW IN AUG. 1979. I HEREBY STATE THAT THE PARCEL MAP PROCEDURES OF THE LOCAL AGENCY HAVE BEEN COMPLIED WITH AND THAT THIS PARCEL MAP CONFORMS TO THE APPROVED TENTATIVE MAP AND THE CONDITIONS OF APPROVAL THEREOF WHICH WERE REQUIRED TO BE FULFILLED PRIOR TO THE FILING OF THE PARCEL MAP.

*Joseph G. Brandt*  
JOSEPH G. BRANDT R.C.E. 26870

## COUNTY SURVEYOR'S CERTIFICATE

THIS MAP CONFORMS WITH THE REQUIREMENTS OF THE SUBDIVISION MAP ACT AND LOCAL ORDINANCE.

*Lawrence J. Brock*  
DATED 9-26-79 LAWRENCE J. BROCK RCE 13528  
PLUMAS COUNTY SURVEYOR

## COUNTY TAX COLLECTOR'S CERTIFICATE

I, LOIS ALEXANDER, TAX COLLECTOR OF THE COUNTY OF PLUMAS, STATE OF CALIFORNIA, DO HEREBY CERTIFY THAT THERE ARE NO TAX LIENS AGAINST THE PARCELS, AS SHOWN HEREON, FOR UNPAID COUNTY, MUNICIPAL, OR LOCAL TAXES OR SPECIAL ASSESSMENTS COLLECTED AS TAXES, EXCEPT TAXES OR ASSESSMENTS NOT YET PAYABLE. TAXES OR ASSESSMENTS WHICH ARE A LIEN BUT NOT YET PAYABLE ARE ESTIMATED TO BE IN THE AMOUNT OF \$ 00.

DATED: 9-26-79 *Lois Alexander*  
LOIS ALEXANDER  
PLUMAS COUNTY TAX COLLECTOR

## COUNTY RECORDER'S CERTIFICATE

FILED THIS 26<sup>TH</sup> DAY OF September, 1979, AT 2:44 P.M. IN BOOK 7 OF PARCEL MAPS AT PAGE 16, AT THE REQUEST OF THE COUNTY ENGINEER.

ILA DIGGS  
COUNTY RECORDER

FEE \$ 500  
FILE NO. 2052

BY *Isabelle Andrews*  
DEPUTY

## PARCEL MAP

OF  
A SUBDIVISION OF TWO PARCELS  
WITHIN  
THE NW 1/4 OF THE SE 1/4 OF SEC 35  
T27N, R9E MDM  
PLUMAS COUNTY, CALIFORNIA

FOR  
RICHARD C. AND MARY M. MURROW  
**brandt & associates**  
CIVIL ENGINEERS~SURVEYORS

75 COURT STREET  
QUINCY, CALIFORNIA 95971

P.O. BOX 749  
916-283-1111

W.O. No. 790803

DATE: SEPT., 1979  
SHEET 1 OF 1