

ENGINEER'S CERTIFICATE

THIS MAP WAS PREPARED BY ME OR UNDER MY DIRECTION AND IS BASED UPON A FIELD SURVEY IN CONFORMANCE WITH THE REQUIREMENTS OF THE SUBDIVISION MAP ACT AND LOCAL ORDINANCE AT THE REQUEST OF THE GRAEAGLE LAND AND WATER COMPANY IN JULY, 1979. I HEREBY STATE THAT THIS PARCEL MAP SUBSTANTIALLY CONFORMS TO THE APPROVED OR CONDITIONALLY APPROVED TENTATIVE MAP, IF ANY.

Richard A. Lundy
RICHARD A. LUNDY
R.C.E. 15265

COUNTY SURVEYOR'S CERTIFICATE

THIS MAP CONFORMS WITH THE REQUIREMENTS OF THE SUBDIVISION MAP ACT AND LOCAL ORDINANCE.

DATED: Nov. 21, 1980

SIGNED *Lawrence J. Brock*
LAWRENCE J. BROCK R.C.E. 13528
PLUMAS COUNTY SURVEYOR

COUNTY TAX COLLECTOR'S CERTIFICATE

I, TAX COLLECTOR OF THE COUNTY OF PLUMAS, STATE OF CALIFORNIA, DO HEREBY CERTIFY THAT THERE ARE NO TAX LIENS AGAINST THE PARCELS, AS SHOWN HEREON, FOR UNPAID COUNTY, MUNICIPAL, OR LOCAL TAXES OR SPECIAL ASSESSMENTS COLLECTED AS TAXES, EXCEPT TAXES OR ASSESSMENTS NOT YET PAYABLE. TAXES OR ASSESSMENTS WHICH ARE A LIEN BUT NOT YET PAYABLE, ARE ESTIMATED TO BE IN THE AMOUNT OF \$ NONE.

DATED: 11/21/80

Lois Alexander
LOIS ALEXANDER
PLUMAS COUNTY TAX COLLECTOR
By *Barbara J. Coker, Deputy*

RECORDER'S CERTIFICATE

FILED THIS 21st DAY OF November, 1980, AT 4:00 P.M. IN BOOK 7 OF PARCEL MAPS AT PAGE 109, AT THE REQUEST OF THE COUNTY ENGINEER.

ILA DIGGS
COUNTY RECORDER

FEE: \$ 5.00

FILE NO.: 109

BY: *Frances Nicol*
DEPUTY

NOTES

1. THE BASIS OF BEARINGS IS THE LINE BETWEEN BASE LINE MONUMENTS "INTERSECTION" AND "SCHOOL" GIVEN AS N07°51'30"W IN BOOK 2 OF RECORDS OF SURVEY AT PAGE 119, PLUMAS COUNTY RECORDS.
2. A CERTIFICATE, SIGNED AND ACKNOWLEDGED BY THE OWNERS, CONSENTING TO THE PREPARATION AND RECORDATION OF THIS PARCEL MAP, DATED JANUARY 18, 1980, IS ON FILE IN THE COUNTY ENGINEERS OFFICE.
3. EASEMENTS NO. 1, 2, & 3 ARE 20' WIDE EASEMENTS ALONG THE EXISTING WATER LINES FOR MAINTENANCE AND OPERATION THEREOF.
4. EASEMENT NO. 4 IS A 20' WIDE PUBLIC UTILITY EASEMENT ALONG THE EXISTING POWER LINES FOR MAINTENANCE AND OPERATION THEREOF.
5. EASEMENT NO. 5 IS A 20' WIDE PUBLIC UTILITY EASEMENT ALONG THE EDGE OF PARCEL 4 WHICH IS ADJACENT TO MARICOPA TRAIL.
6. EASEMENTS FOR THE INSTALLATION AND MAINTENANCE OF UTILITIES AND DRAINAGE FACILITIES ARE OVER THE REAR 10 FEET AND EACH SIDE 10 FEET OF EACH PARCEL ON THIS MAP AS NOTED IN THE RECORDED DECLARATION OF ESTABLISHMENT OF EASEMENTS WHICH IS FILED CONCURRENTLY WITH THIS MAP.
7. MARICOPA TRAIL AND WASCO TRAIL ARE EASEMENTS FOR PRIVATE ROAD ACCESS, DRAINAGE, PUBLIC UTILITY, AND FUTURE PUBLIC ROAD PURPOSES.
8. ROADS SHOWN HEREON ARE PRIVATE EASEMENTS THAT ARE ESTABLISHED BY A DECLARATION FILED CONCURRENT WITH OR PRIOR TO RECORDATION OF THE MAP. SUCH EASEMENTS MAY NOT BECOME FULLY EFFECTIVE UNLESS AND UNTIL RESERVATIONS AND GRANTS ARE INCLUDED IN THE RESPECTIVE DEEDS.
9. ROADS SHOWN HEREON ARE PRIVATE ROADS NOT SUBJECT TO COUNTY IMPROVEMENT OR MAINTENANCE. IT WILL BE REQUIRED THAT SUCH ROADS BE IMPROVED TO COUNTY STANDARDS AT NO COST TO THE COUNTY BEFORE SUCH ROADS WILL BE ACCEPTED INTO THE COUNTY ROAD SYSTEM.

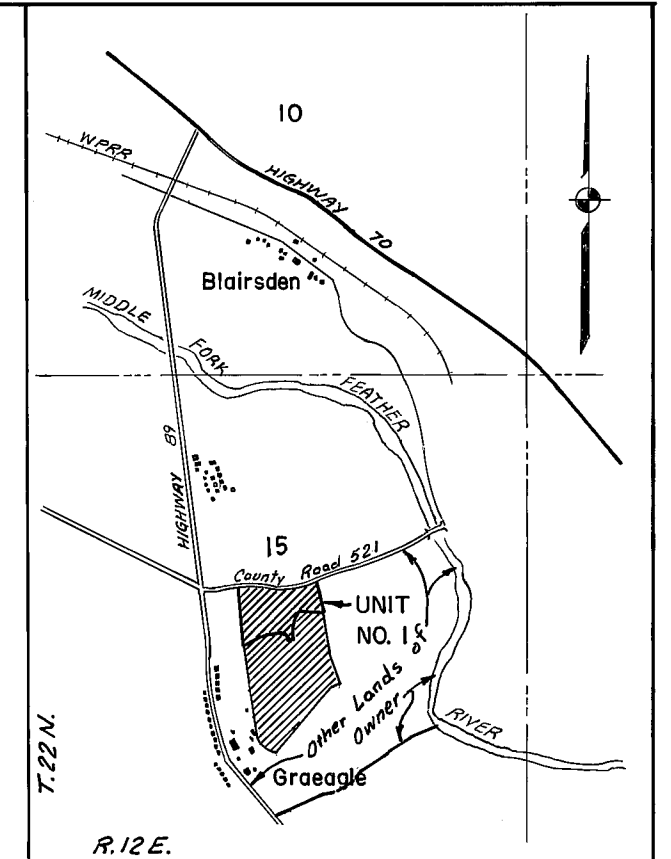

VICINITY MAP

SCALE: 1" = 2000'

LEGEND

- - SET 1/2" REBAR, CAPPED, R.C.E. 15265
- - FOUND MONUMENT AS DESCRIBED HEREON.

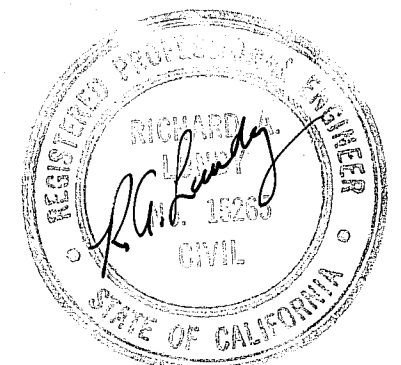

PARCEL MAP

OF
GRAEAGLE INDUSTRIAL PARK
UNIT NO. 1

WITHIN SECTION 15, T.22N., R.12E., M.D.B. & M.
IN PLUMAS COUNTY, CALIFORNIA
FOR

GRAEAGLE LAND AND WATER COMPANY

LUNDY ENGINEERING INC.
P.O. BOX 308
GRAEAGLE, CALIFORNIA
R.C.E. 15265

Date: FEB., 1980

Sheet 1 of 1