

Legend
 ○ Found 1/2" rebar RCE 22836 per LRS 86
 ● Set 1/2" rebar RCE 22836
 --- Approximate Leach Exclusion Boundary

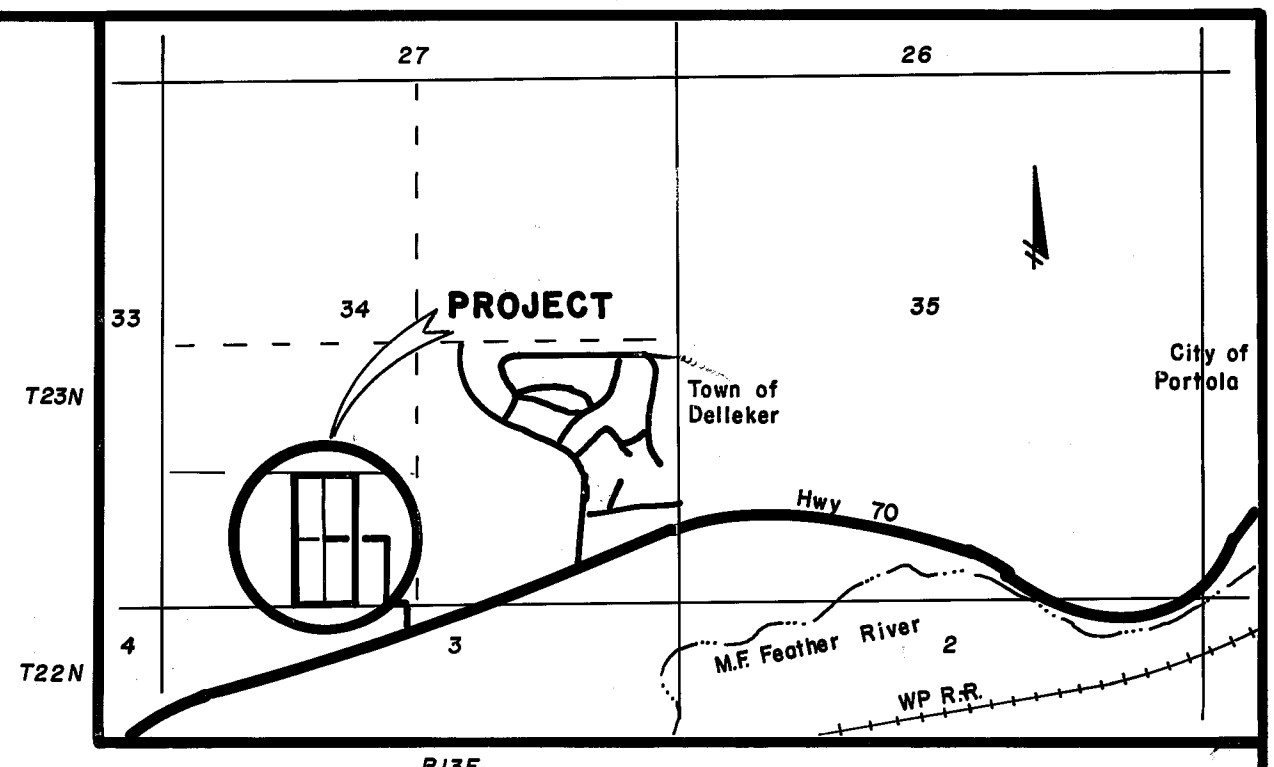

ENGINEER'S CERTIFICATE

This map was prepared by me or under my direction and is based upon a field survey in conformance with the requirements of the Subdivision Map Act and Local Ordinance at the request of Anna Anderson in September 1982. I hereby state that the parcel map procedures of the local agency have been complied with and that this parcel map conforms to the approved tentative map and the conditions of approval thereof which were required to be fulfilled prior to the filing of the parcel map.

Clifford R. Brown
 Clifford R. Brown RCE 22836

COUNTY SURVEYOR'S CERTIFICATE

This map conforms with the requirements of the Subdivision Map Act and Local Ordinance.

dated 1-25-84
Lawrence J. Brock
 Lawrence J. Brock RCE 13528
 Plumas County Surveyor

COUNTY RECORDER'S CERTIFICATE

Filed this 27th day of February 1984, at 1:36 A.M. in Book 8 of Parcel Maps at Page 135 at the request of the County Engineer.

ILA DIGGS, County Recorder
 Fee \$ 5.00
 File No. 6666 by *Bob Cannon*
 Deputy

COUNTY TAX COLLECTOR

I, Barbara J. Cokor, Tax Collector of the County of Plumas, State of California, do hereby certify that there are no tax liens against the parcels as shown hereon for unpaid County, Municipal or Local Taxes or Special Assessments collected as taxes, except taxes or assessments not yet payable. Taxes or assessments which are a lien but not yet payable are estimated to be in the amount of NONE.

dated 1-18-84
Barbara J. Cokor
 By: *Joanna Sequera, Deputy*
 Barbara J. Cokor
 Plumas County Tax Collector

NOTES:

1. A Certificate of Ownership is recorded concurrently in Book 402 Official Records at page 391392 and is dated Oct 19, 1982.
2. Leach exclusion areas include 50' from seasonal streams, 100' from wells and meadow, all slopes over 30%, and 4 x the vertical height of cut banks.
3. Private Road Statement; Road shown hereon are private easements not subject to improvement or maintenance by Plumas County. Such easements will not become effective unless and until reservations and grants are included in respective deeds.
4. This map is a division of "Lands of Espinal et al" as shown in Book 6 of Record of Surveys at page 86.

PARCEL MAP

A Subdivision of four parcels for:

Martin Espinal Anna Anderson
 Ray L. Anderson Frank Espinal

A Portion of Section 34 T23N R13E MDB & M
 Plumas County, California

Clifford R. Brown Engineering and Surveying
 Rt. 1 Box 480 B
 Quincy, Calif.