

**SURVEYOR'S CERTIFICATE**

This map was prepared by me or under my direction and is based upon a field survey in conformance with the requirements of the Subdivision Map Act and local ordinance at the request of Mr. Raymond C. Hoxworth in April 1981. I hereby state that this Parcel Map substantially conforms to the approved or conditionally approved Tentative Map, if any.

*Robert A. Brookman*  
Robert A. Brookman, L.S. 4060



**COUNTY SURVEYOR'S CERTIFICATE**

This map conforms with the requirements of the Subdivision Map Act and local ordinance.

Dated: January 4, 1982

*Lawrence J. Brock*  
Lawrence J. Brock, R.C.E. 13,528  
Plumas County Surveyor

**NOTES**

A Certificate of Owner's Consent to the preparation and recording of this map and Grant of Easement for La Porte Road is on file in the County Recorder's Office in 363 O.R. 144.

**TAX COLLECTOR'S CERTIFICATE**

I, Barbara J. Coker, Tax Collector of the County of Plumas, State of California, do hereby certify that there are no tax liens against the parcels, as shown hereon, for unpaid county, municipal or local taxes or special assessments collected as taxes, except taxes or assessments not yet payable. Taxes or special assessments which are a lien but not yet payable, are estimated to be in the amount of \$ NONE.

Dated: 1-4-82

*Barbara J. Coker*  
Barbara J. Coker  
Plumas County Tax Collector

**RECORDER'S CERTIFICATE**

Filed this 4<sup>th</sup> day of January, 1982, at 1:08 P.M., in Book 8 of Parcel Maps at Page 57 at the request of the County Engineer.

Ila Diggs By: *Isabelle Andrews*  
Plumas County Recorder Deputy  
File No. 5680 Fee: \$ 7.00

**von Geldern Engineering Co.**

430 Second Street  
Yuba City, Calif.

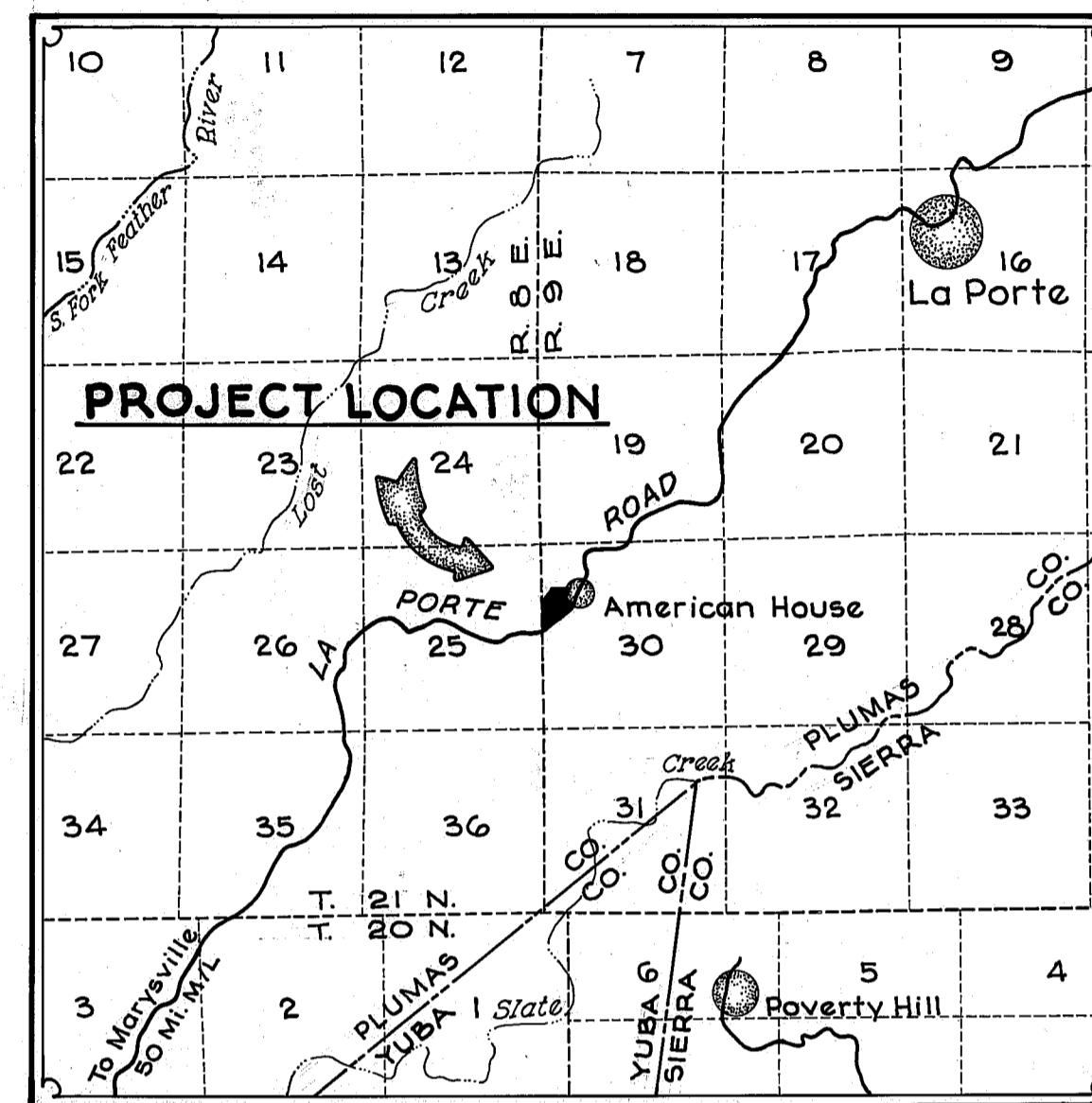

**VICINITY MAP**  
1" = 1 Mile ±

**PARCEL MAP**

FOR  
**Raymond C. and Pauline S. Hoxworth**

BEING A PORTION OF LOT 2 OF SECTION 30,  
TOWNSHIP 21 NORTH, RANGE 9 EAST, M.D.B. & M.,  
LYING NORTHWESTERLY OF LA PORTE ROAD,  
PLUMAS COUNTY, CALIF.

April 1981