

Septic tank installation permit for Parcel 3 may require submittal of a special design septic tank/leachfield system subject to the approval by the County Sanitarian.

A Division of Parcel 3 per 3 PM 126

Roads shown hereon are private easements not subject to improvement or maintenance by Plumas County. Such easements will not become effective unless and until reservations and grants are included in the respective deeds.

Owners Certificate 365 OR 271

Leach Exclusion Areas are all areas within 50' of property lines, within easements, within 50' of watercourses.

Basis of Bearings: The West line of Parcel 3 shown as N01°22'08"W per 3 PM 126, Plumas County Records.

**LEGEND**

- Found Point as noted
- Set Rebar & Lap L.S. 2843
- R Record per 3 PM 126
- M Measured
- PUE Public Utility Easement

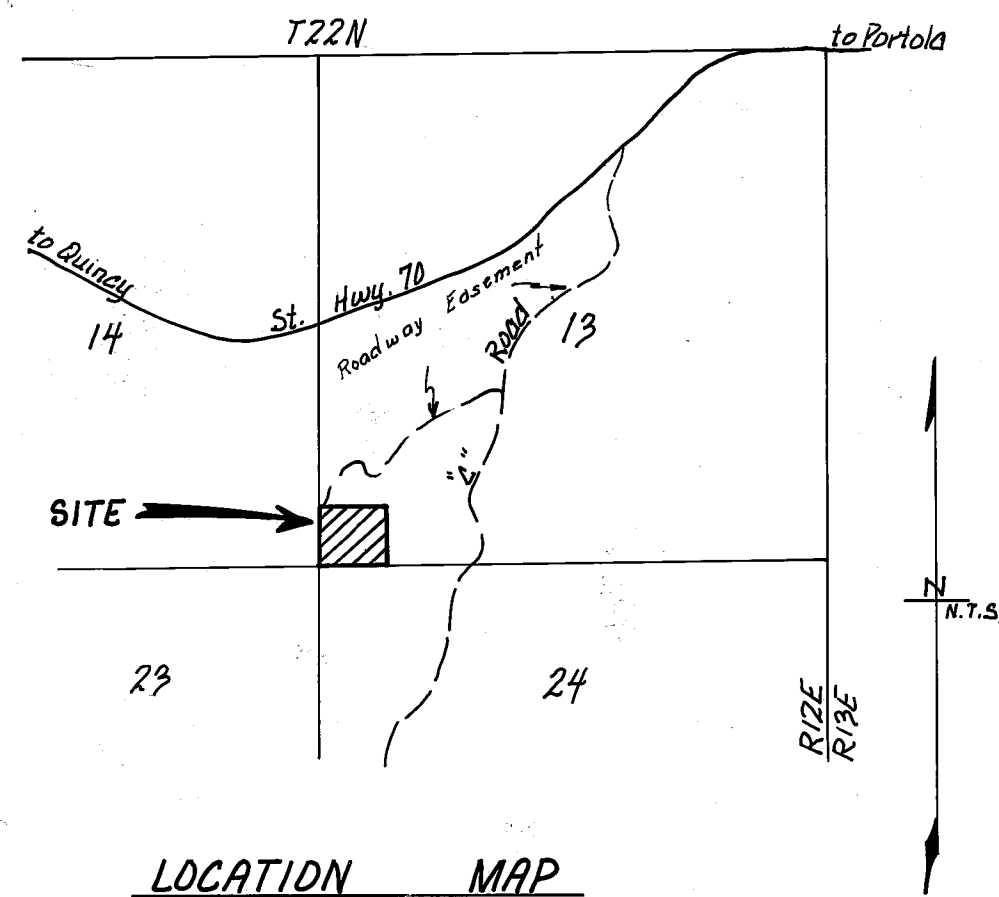

**SURVEYOR'S CERTIFICATE**

This map was prepared by me or under my direction and is based upon a field survey in conformance with the requirements of the Subdivision Map Act and local ordinance at the request of James R. & Marilyn J. Lake on 7/10/79. I hereby state that the parcel map procedures of the local agency have been complied and that this parcel map conforms to the approved tentative map and the conditions of approval thereof which were required to be fulfilled prior to the filing of the parcel map.

*John W. Hamby*  
John W. Hamby L.S. 2843

**COUNTY SURVEYOR'S CERTIFICATE**

This map conforms with the requirements of the Subdivision Map Act and local ordinances.

*Lawrence J. Brock*  
Lawrence J. Brock R.E. 13528  
Plumas County Surveyor

**COUNTY TAX COLLECTOR'S CERTIFICATE**

I, Barbara J. Coker, Tax Collector of the County of Plumas, State of California, do hereby certify that there are no tax liens against the parcels, as shown hereon, for un-paid county, municipal or local taxes or special assessments collected as taxes, except taxes or assessments not yet payable. Taxes or assessments which are a lien but not yet payable are estimated to be in the amount of \$ NONE.

*Barbara J. Coker*  
Barbara J. Coker  
Plumas County Tax Collector

**COUNTY RECORDER'S CERTIFICATE**

Filed this 24<sup>th</sup> day of February, 1982, at 3:19 P.M. in Book 8 of Parcel Maps at Page 65 at the request of the County Engineer. Fee \$5.00 File No. 6653

Ila Diggs  
County Recorder

By *Isabelle Andrews*  
Deputy

**Parcel Map for James R. & Marilyn J. Lake, Et. Al.**

Being the SW 1/4 of the SW 1/4 of the SW 1/4 of Section 13, T. 22N., R. 12E., M.D.B. & M. Plumas County, California 17<sup>th</sup> of July, 1979

Prepared by:  
John W. Hamby L.S. 2843  
Licensed Land Surveyor  
P.O. Box 842 Ph. (916) 832-5571  
Portola, California 96122

Sheet 1 of 1