

Stump of original BT some scribing visible  
 N. 68 1/2° W. 41 lks  
 Scribed 9" Pine BT  
 S. 64° W. 41 lks  
 Scribed 12" Pine BT  
 S. 42° E. 25 lks  
 W. 1/4 Cor. Sec. 18  
 3 1/4" B.L.M. Brass Cap

**NOTES**

- (1) Certificate of Owners' consent to prepare and record this map is on file in the Plumas County Recorder's office in Book 383 of Official Records at Page 218.
- (2) Leach exclusion areas are all areas within 50' of property lines, within easements, within 50' of water courses, within 100' of existing wells, proposed well locations and existing springs, within a distance of four times the height of any cutbank and all areas with slopes in excess of 30%.
- (3) Septic tank installation permits for Parcels 2, 3, & 4 may require submittal of a special design septic tank/leachfield system subject to approval by the County Sanitarian.
- (4) Roads shown hereon are private easements and will not become fully effective unless and until reservations and grants are included in the respective deeds. Said roads are private roads not subject to Plumas County improvements or maintenance.
- (5) This map amends the Parcel Map filed in Book 7 of Parcel Maps at Page 64. The North 1/4 corner of Section 18 was incorrectly proportioned on 5 R.S. 90.

**LEGEND**

- = Found monument as noted per 6 R.S. 95
- = Found 1/2" capped rebar L.S. 2843 per 6 R.S. 95
- = Set 1/2" capped rebar L.S. 2843
- M = Measured
- R = Record data per 7 P.M. 64
- = Proposed Well location

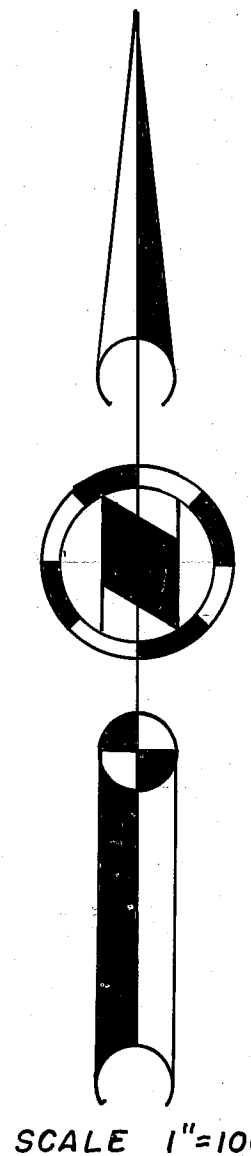
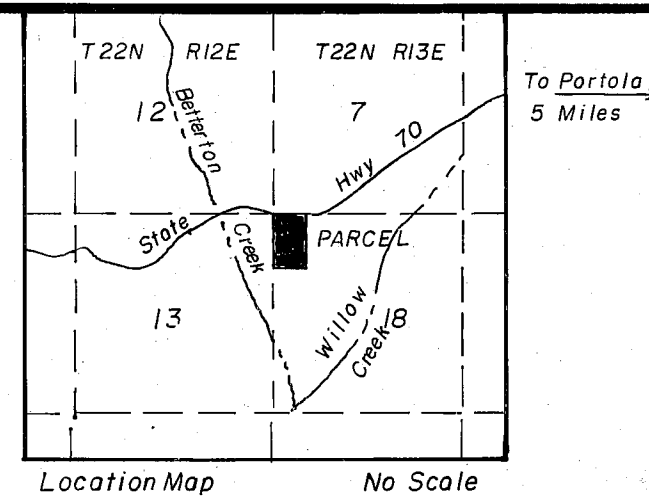

**BASIS OF BEARING**

The West line of the Northwest 1/4 of Section 18 shown as N 2° 04' 03" E on the Record of Survey map filed in Book 5 of Record of Surveys at Page 90, Plumas County Records.

**AMENDED  
 PARCEL MAP  
 FOR**

**STANLEY M. & VIVIAN D. MARKHAM**

OF  
 A PORTION OF THE N.W. 1/4 OF SECTION 18  
 T. 22 N., R. 13 E., M.D.B. & M.  
 PLUMAS COUNTY, CALIFORNIA

**HAMBY SURVEYING INC.**  
 LICENSED LAND SURVEYORS

P.O. BOX 1209  
 PORTOLA, CALIF.

P.O. BOX H.H.  
 PARADISE, CALIF.