

LEGEND

- Found Iron Pipe, as noted
- Set 1/2" Rebar and cap, L.S. 2843
- (R) Record information per 3 PM 126
- (M) Measured information

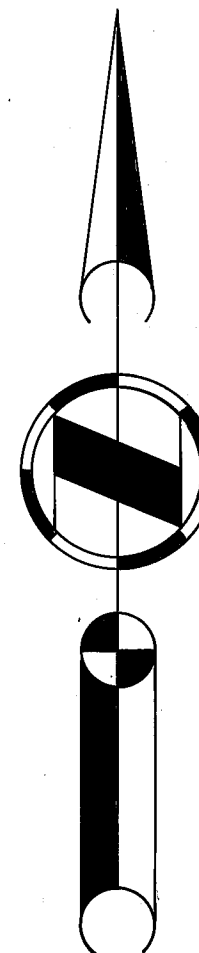

SCALE 1" = 100'

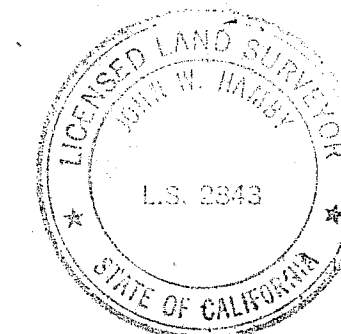

COUNTY SURVEYOR'S CERTIFICATE

This map conforms with the requirements of the Subdivision Map Act and local ordinances.

Dated 2/26/85

Lawrence J. Brock
Lawrence J. Brock, R.C.E. 13528
Plumas County Surveyor

SURVEYOR'S CERTIFICATE

This map was prepared by me or under my direction and is based upon a field survey in conformance with the requirements of the Subdivision Map Act and local ordinances at the request of William Fowler on October 7, 1983. All of the monuments shown hereon are of the character and occupy the positions indicated and are sufficient to enable the survey to be retraced. I hereby state that the parcel map procedures of the local agency have been complied with and that this parcel map conforms to the approved tentative map and the conditions of approval thereof which were required to be fulfilled prior to filing the parcel map, if any.

John W. Hamby
John W. Hamby, L.S.-2843

COUNTY TAX COLLECTOR'S CERTIFICATE

I, Barbara J. Cokor, Tax Collector of the County of Plumas, State of California, do hereby certify that there are no tax liens against the Parcels, as shown hereon, for unpaid county, municipal, or local taxes or special assessments collected as taxes, except taxes or assessments not yet payable. Taxes or assessments which are a lien but not yet payable, are estimated to be in the amount of NONE.

Dated 2-26-85

Barbara J. Cokor by Danny Schoder
Barbara J. Cokor, asst.
Plumas County Tax Collector

COUNTY RECORDER'S CERTIFICATE

Filed this 28th day of February, 1985, at 9:20 A.M. in Book 9 of Parcel Maps, at Page 24, at the request of the County Engineer.

Fee # 500
File No. 5880

Ila Diggs
County Recorder
By *Patricia Lacey*
Deputy

BASIS OF BEARINGS

Is the NORTH line of Parcels 1 & 2 shown as N. 89° 16' 56" E. per 3 PM 126.

NOTES

A certificate of ownership is on file with the County Recorder in Book 421 of Official Records at Page . The certificate was signed by William R. & Virginia E. Fowler and Douglas J. & Gay Marie Weston and stated that they consent to the preparation and recording of this map, and that they are the only persons whose consent is required to pass title to said land.

Leach Exclusion Areas are all areas within 50' of property lines, within 50' of watercourses, within 100' of wells, and within easements.

Roads shown hereon are private easements not subject to improvements or maintenance by Plumas County. Such easements may not become effective unless and until reservations and grants are included in the respective deeds.

Parcels 1 & 2 are a division of Parcel 1 per 3 PM 126.

No authorized structural fire protection is presently provided to the parcels shown hereon.

LOCATION MAP
N. T. S.

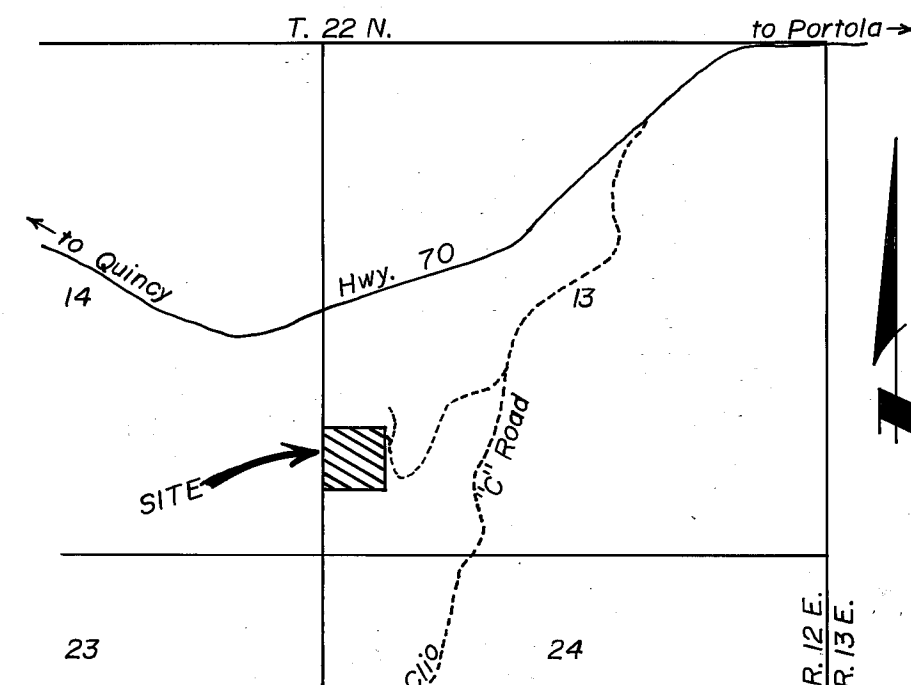

PARCEL MAP

FOR
WILLIAM R. FOWLER & VIRGINIA E. FOWLER
DOUGLAS J. WESTON & GAY MARIE WESTON

THE N.W. 1/4, OF THE S.W. 1/4, OF THE S.W. 1/4, OF SECTION 13,
T. 22 N., R. 12 E., M.D.B. & M. - PLUMAS COUNTY - CALIFORNIA

HAMBY SURVEYING INC.
P.O. Box 1209 - L.S. 2843
Portola, California 96122
Phone (916) 832-5571