

### SURVEYOR'S STATEMENT

This map was prepared by me or under my direction and is based upon field survey in conformance with the requirements of the Subdivision Map Act and local ordinance at the request of Erwin Scheppers in May, 2000. All of the monuments shown hereon are of the character and occupy the positions indicated and are sufficient to enable the survey to be retraced. I hereby state that this parcel map substantially conforms to the approved tentative map or conditionally approved tentative map, if any.

Vernon H. Templeton  
Vernon H. Templeton  
LS 4647



6/2/00  
DATE

### OWNER'S STATEMENT

We, Erwin Scheppers and <sup>Wilhelmina</sup> Scheppers, having record title interest in the subdivided lands do hereby consent to the preparation & recordation of this map.

Erwin Scheppers  
Erwin Scheppers

06-06-00  
date

Wilhelmina Scheppers  
Wilhelmina Scheppers

6-6-00  
date

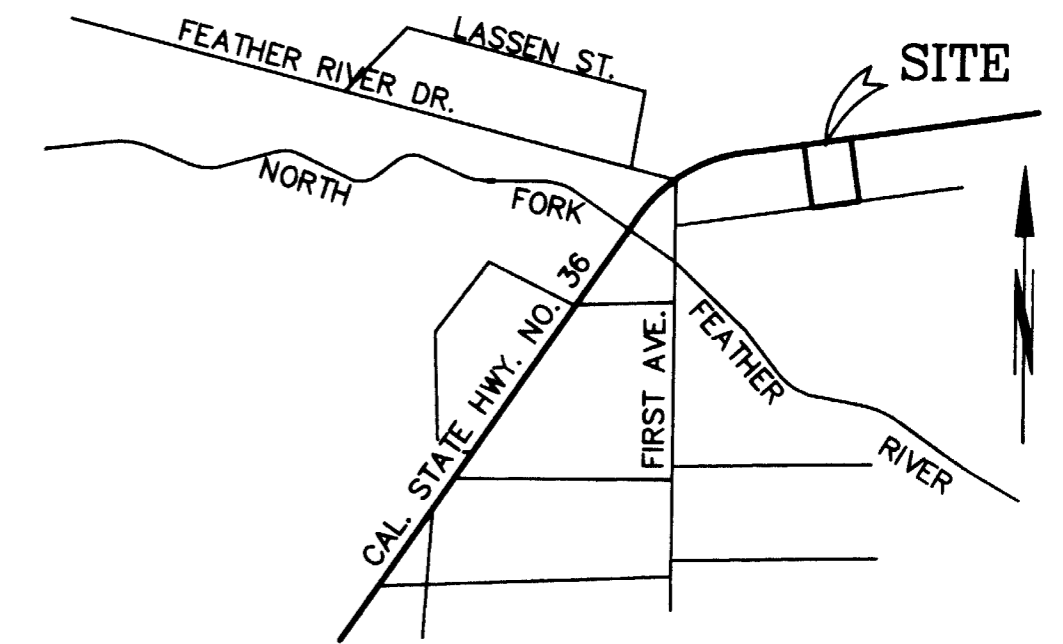

VICINITY MAP  
NOT TO SCALE

### COUNTY SURVEYOR'S STATEMENT

I have examined this map and find it is substantially the same as it appeared on the Tentative Map and any approved alterations thereof. All provisions of the Subdivision Map Act and any local ordinances applicable at the time of approval of the Tentative Map have been complied with and I am satisfied that the map is technically correct.

R Tom Hunter  
R. Tom Hunter, RCE 30515  
Plumas County Surveyor  
(lic. exp. 3/31/04)

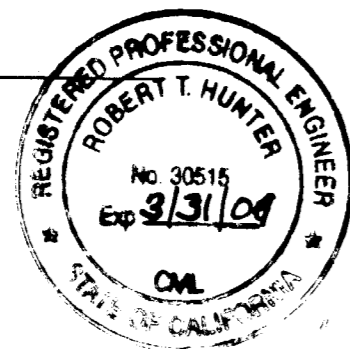

6/9/00  
DATE

### NOTARY ACKNOWLEDGMENT

STATE OF CALIFORNIA }  
COUNTY OF PLUMAS } SS

On 6/6/00 before me, the undersigned, a Notary Public in and for said State, personally appeared Erwin Scheppers & Wilhelmina Scheppers personally known to me (or proved to me on the basis of satisfactory evidence) to be the person[s] whose name[s] is/are subscribed to the within instrument and acknowledge to me that he/she/they executed the same in his/her/their authorized capacity[ies], and that by his/her/their signature[s] on the instrument the person[s], or the entity upon behalf of which the person[s] acted, executed the instrument.

WITNESS my hand and official seal.

Signature Donna Turley

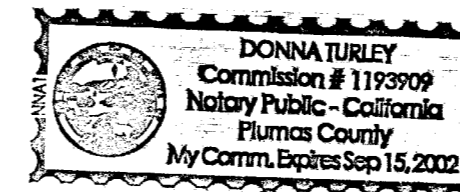

### COUNTY TAX COLLECTOR'S CERTIFICATE

I, Barbara J. Coates, Tax Collector of the County of Plumas, State of California, do hereby certify that there are no tax liens against the Parcels, as shown hereon, for unpaid State, County, Municipal, or Local taxes or special assessments collected as taxes, except taxes or assessments not yet payable. Taxes or assessments which are a lien but not yet payable, are estimated to be in the amount of 3190.00

Barbara J. Coates  
Barbara J. Coates  
Plumas County Tax Collector

June 7, 2000  
DATE

### COUNTY RECORDER'S STATEMENT

Filed this 9th day of June, 2000 at 2:10 P m. in Book 11 of Parcel Map at page 80-81 at the request of the County Surveyor.

FEE: \$ 10.00

FILE No. 3640

Judith Wells, County Recorder

By: Deborah J. Jensen  
Deputy

### PARCEL MAP FOR ERWIN & WILHELMINA SCHEPPERS

IN SECTION 5, T.28 N., R.7 E., M.D.B. & M.  
LOTS 8,9,10,18,19 & 20, BLOCK 1, SOUTHERN ADDITION  
TOWN OF CHESTER, PLUMAS COUNTY, CALIFORNIA

SCALE: 1" = 30'

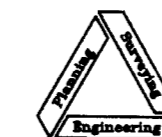

NST Engineering, Inc.  
1495 Riverside Drive  
Susanville, CA 96130  
(530) 257-5173