

COUNTY TAX COLLECTOR'S STATEMENT

I, Barbara J Coates, Tax Collector of the County of Plumas, State of California, do hereby certify that there are no tax liens against the parcels shown hereon for unpaid state, county, municipal or local taxes or special assessments collected as taxes, except taxes or assessments not yet payable. Taxes or assessments which are a lien but not yet payable are estimated to be in the amount of none.

Dated: 11-30-01

*Barbara J Coates by Minnie Hunter, act.*  
Barbara J. Coates  
Plumas County Tax Collector

OWNER'S STATEMENT

A Certificate of Ownership is on file with the County Recorder ~~As Doc # 2001-10484~~ of Official Records, at page ~~10484~~. The certificate was signed by E. Daniel Leonhardt and Debbie B. Leonhardt and states that they consented to the preparation and recording of this map, and that they are the only persons whose consent is required to pass title to said land.

COUNTY SURVEYOR'S STATEMENT

I have examined this map and find it is substantially the same as it appeared on the tentative map and any approved alterations thereof. All provisions of the subdivision map act and any local ordinances applicable at the time of approval of the tentative map have been complied with, and i am satisfied that the map is technically correct.

Dated: 12/3/01

*R Tom Hunter*  
R. Tom Hunter R.C.E. 30515  
Plumas County Surveyor  
License Expiration Date 3/31/04



NOTES

- The easement created in Book 35 Deeds page 227 is not locatable from records.
- The easement created in Book 50 Deeds page 385 is not locatable from records.
- The easement created in Book 51 Deeds page 43 is not locatable from records.
- The easement created in Book 73 Deeds page 23 is not locatable from records.
- The easement created in Book 73 Deeds page 25 is not locatable from records.

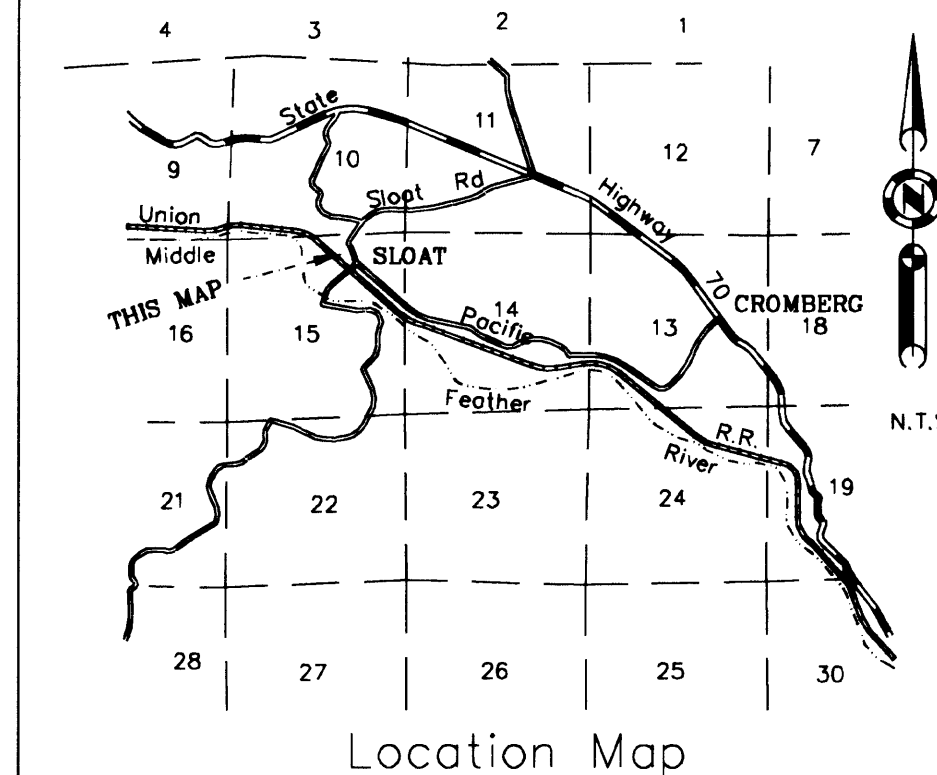

SURVEYOR'S STATEMENT

This map was prepared by me or under my direction and is based upon a field survey in conformance with the requirements of the Subdivision Map Act and local ordinance at the request of Daniel Leonhardt in September, 2001. All the monuments shown hereon are of the character and occupy the positions indicated and are sufficient to enable the survey to be retraced. I hereby state that this parcel map substantially conforms to the approved or conditionally approved tentative map, if any.

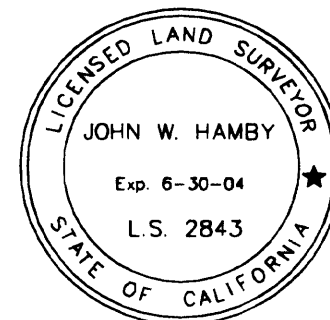

*John W Hamby*  
John W. Hamby L.S. 2843

COUNTY RECORDER'S STATEMENT

Filed this 4th day of December, 2001, at 3:06 p.m. in Book 11 of Parcel Maps, at page 104-106 at the request of the County Surveyor.

Fee 12.00  
File No. 2001-10487

Judith Wells  
County Recorder  
By *Debra J. Jensen*  
Deputy

BENEFICIARIES STATEMENT

A Beneficiaries Certificate consenting to the preparation and recording of this map is on file with the County Recorder as Document # 2001-10485 of Official Records.

PARCEL MAP

for  
E. DANIEL and DEBBIE B. LEONHARDT  
A portion Sections 10 & 15  
T. 23 N., R. 11 E., M.D.M.  
Plumas County ~ California  
September, 2001

HAMBY SURVEYING INC.  
P.O. Box 1209  
PORTOLA, CA. 96122  
Phone 530-832-5571