

SURVEYOR'S CERTIFICATE

This map correctly represents a survey made by me in conformance with the requirements of the Land Surveyors Act at the request of John Pecten, of San Mateo, California, owner of Parcel "B" shown hereon, on July 17th 1969.

James F. Flanagan
James F. Flanagan
R.C.E. 292

COUNTY SURVEYOR'S CERTIFICATE

This map has been examined by me for conformance with the requirements of the Land Surveyors Act this 31st day of July 1969.

Darrell P. Payne
Darrell P. Payne,
County Surveyor

L A K E A L M A N O R

Note: Set on P.G.#E. 4500 Contour Line as found.

N 59°50'36" W 44.80'
(Measured)
N 20°02'32" W 105.00'
(Measured)

Lot "B"
(Measured)
50.04 W
176.05
P. G. # E CO.

N 53°45'59"E 92.87 (Measured)
(N 53°42'E 88.20' Record)

Lot "A"

Lot 1.

Lot 2.

Easement (See Pg. 101 Bk. I. Refs.)
621's Rec. & Ind.
(Measured)
120

30°02' W 307.21' (Rec. & Measured)
Basis of Bearings
COUNTY ROAD
To Almanor P.O.

Scale: 1" = 20'

RECORD OF SURVEY

MAP OF LOT "B" AS SHOWN ON A RECORD OF SURVEY OF A PORTION OF THE NE 1/4 OF SE 1/4 OF SECTION 11, T. 27 N., R. 7 E., M. D. M., FILED AUGUST 1, 1952 ON PAGE 101 OF BOOK I, R. OF S., PLUMAS COUNTY RECORDS.

JAMES F. FLANAGAN, R.C.E. 292

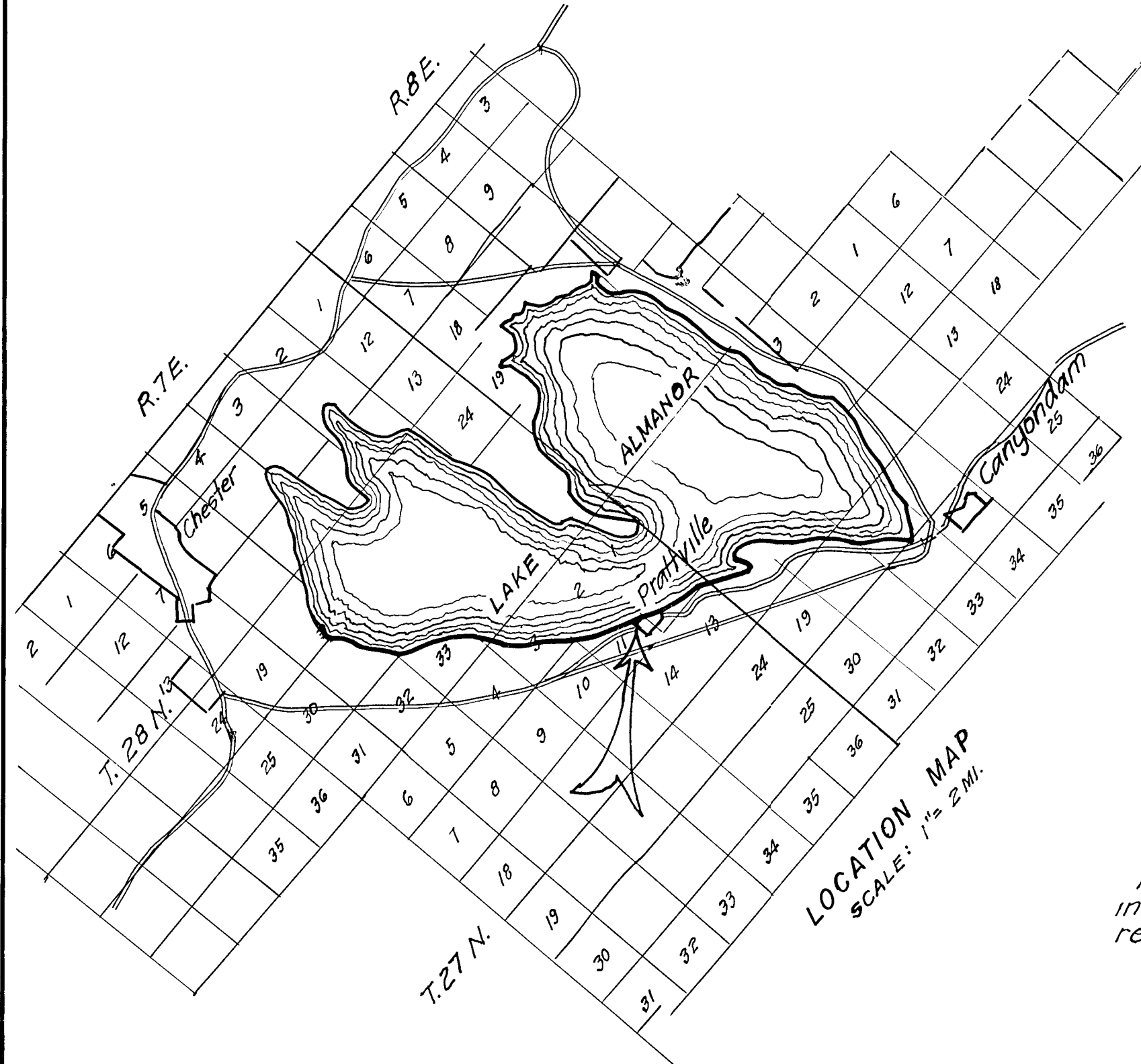

#131

RECORDER'S CERTIFICATE

Filed this 1st day of Aug 1969 at 1:30 PM in Book 3 of Rec. of Survt at Page 129 at the request of James F. Flanagan

Ida Hogan Gronvold
Ida Hogan Gronvold
Plumas County Recorder
by Debra, Deputy

LEGEND

- Conc Mon Found. P.G.#E
- Iron Pipe 3/4" Found, L.S. 2332
- 5/8" Alum conduit set R.C.E 292
- Wooden hub found, old.