

NOTES:

The basis of bearing is the centerline of the Quincy Junction Road

LEGEND:

Set 3/4" Iron Pipe marked L S 2846
Indicates found Iron Pipe

NOTE

The existing found monuments marked L S 2587, the Recorded Deeds and the Recorded Record of Survey Map referred to disagree as to the boundary of the exception shown. This survey used a line which is on the West and South extremities of the line as described by deed and Record of Survey Map and found monuments

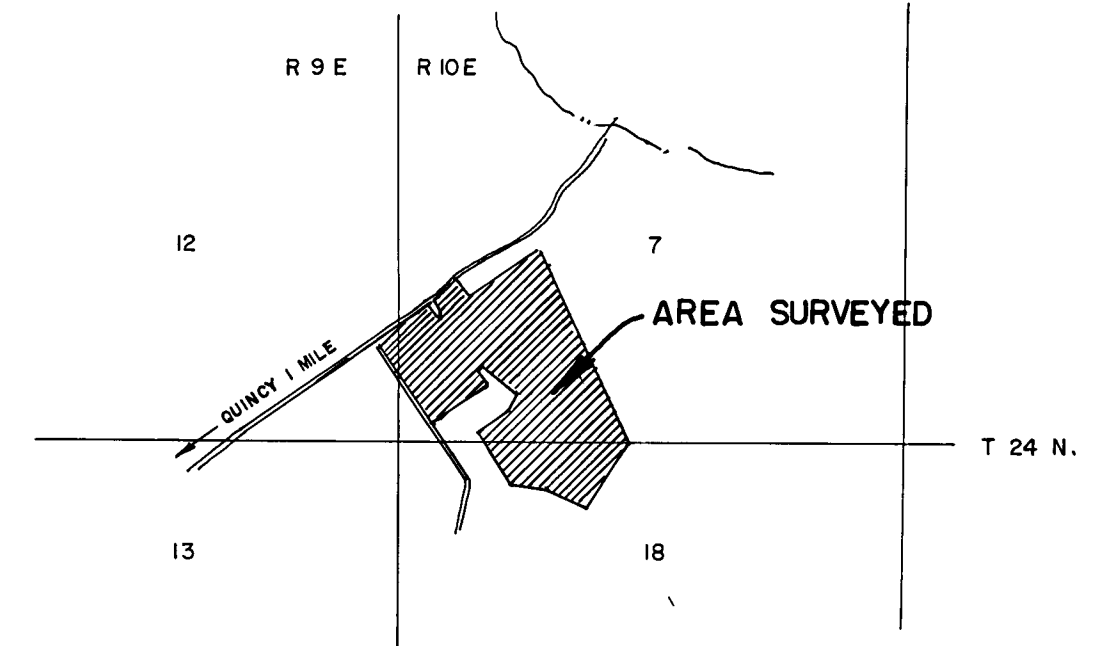

LOCATION MAP
SCALE 1" = 2000'

SURVEYOR'S CERTIFICATE.

This map correctly represents a survey made by me or under my direction in conformance with the requirements of the Land Surveyors Act at the request of R. D Mitchell in August, 1966. This record of survey is not a subdivision as defined in Section 11535, Article 3, Chapter 2, of the Business and Professions Code

Edward P. Norris
EDWARD P. NORRIS L.S. 2846

COUNTY ENGINEER'S CERTIFICATE

This map has been examined for conformance with the requirements of the Land Surveyors Act this 25th day of April, 1966.

by Marcus J. McBeem Deputy
JAMES F. FLANAGAN R.C.E 292
County Engineer

RECORDER'S CERTIFICATE:

Filed for record this 23rd day of May, 1966, at 1:01 P.M. in Book of Maps at page at the request of W.B. Grimes RECORD OF SURVEYS

Recording No. 4424
Fee 5.00

Ida Logan Gronwald
County Recorder

RECORD OF SURVEY MAP
A PORTION OF SECTIONS, 12, T.24N., R.9 E., M.D.B. & M.,
AND 7 AND 18, T.24N., R.10 E., M.D.B. & M. PLUMAS COUNTY, CALIFORNIA

SURVEY OF THE LANDS OF
R. D. MITCHELL

SCALE 1" = 200'

DECEMBER 1965

WALTER B GRIMES & ASSOCIATES
CIVIL ENGINEERS AND LAND SURVEYORS
1338 MANGROVE AVENUE CHICO, CALIFORNIA

